

QTY.	KEY	BOTANICAL NAME	COMMON NAME	SIZE
Trees				
1	AB	Abies balsamea	Balsam Fir	10'-12'
2	AR	Acer rubrum	Red Maple	3-3.5'
1	ARS	Acer rubrum 'Red Sunset'	Red Sunset Red Maple	3-3.5'
1	ASF	Acer saccharum 'Fall Fiesta'	Fall Fiesta Sugar Maple	3-3.5'
3	ASL	Acer saccharum 'Legacy'	Legacy Sugar Maple	3-3.5'
1	CKW	Cornus kousa 'Wolf Eyes'	Wolf Eyes Kousa Dogwood	2.2-2.5'
2	GBF	Gingko biloba 'Fastigiata'	Fastigiata Maidenhair Tree	3-3.5'
3	LSM	Liquidambar styraciflua 'Moraine'	Moraine Sweet Gum	3-3.5'
12	TGG	Thuja plicata 'Green Giant'	Green Giant Arborvitae	8-10'
10	TGG	Thuja plicata 'Green Giant'	Green Giant Arborvitae	7-8'
4	OC	Quercus cocinea	Scarlet Oak	3-3.5'
3	OR	Quercus rubra	Red Oak	3-3.5'
Shrubs				
AP		Azalea 'Pleasant White'	Pleasant White Azalea	3 gallon
DG		Deutzia gracilis 'Cherry Blossom'	Cherry Blossom Deutzia	3 gallon
HO		Hydrangea paniculata 'Quickfire'	Quickfire Hydrangea	5 gallon
HQRS		Hydrangea quercifolia 'Ruby Slippers'	Ruby Slippers Hydrangea	3 gallon
HTTS		Hydrangea serrata 'Tiny Tuff Stuff'	Tiny Tuff Stuff Hydrangea	3 gallon
IMB		Ilex meserveae 'Blue Princess'	Blue Princess Blue Holly	3 gallon
RCW		Rhododendron 'Cunningham's White'	Cunningham's White Rhododendron	3 gallon
SBK		Spiraea media 'Double Play Blue Kazoo'	Blue Kazoo Spiraea	3 gallon
Perennials and Ornamental Grasses				
ABI		Amsonia 'Blue Ice'	Blue Star Amsonia	1 quart
ECS		Echinacea purpurea	Eastern Purple Coneflower	1 quart
EP		Echinacea polychroma	Cushion Spurge	1 quart
GR		Geranium 'Rozanne'	Rozanne Geranium	1 quart
HAG		Hakonechloa macra 'All Gold'	All Gold Japanese Hakone Grass	1 gallon
KKF		Kalmagrostis x oculiflora 'Karl Foerster'	Feather Reed Grass	3 gallon
MS		Miscanthus sinensis 'Morning Light'	Variiegated Maiden Grass	3 gallon
PH		Pennisetum alopecuroides 'Hameln'	Dwarf Fountain Grass	3 gallon
RUD		Rudbeckia 'Goldsturm'	Black-Eyed Susan	1 quart
RAS		Rudbeckia laciniata 'Autumn Sun'	Cutleaf Coneflower	1 quart

NOTE: Final quantities of Shrubs, Perennials and Ornamental Grasses will be determined at a later date.

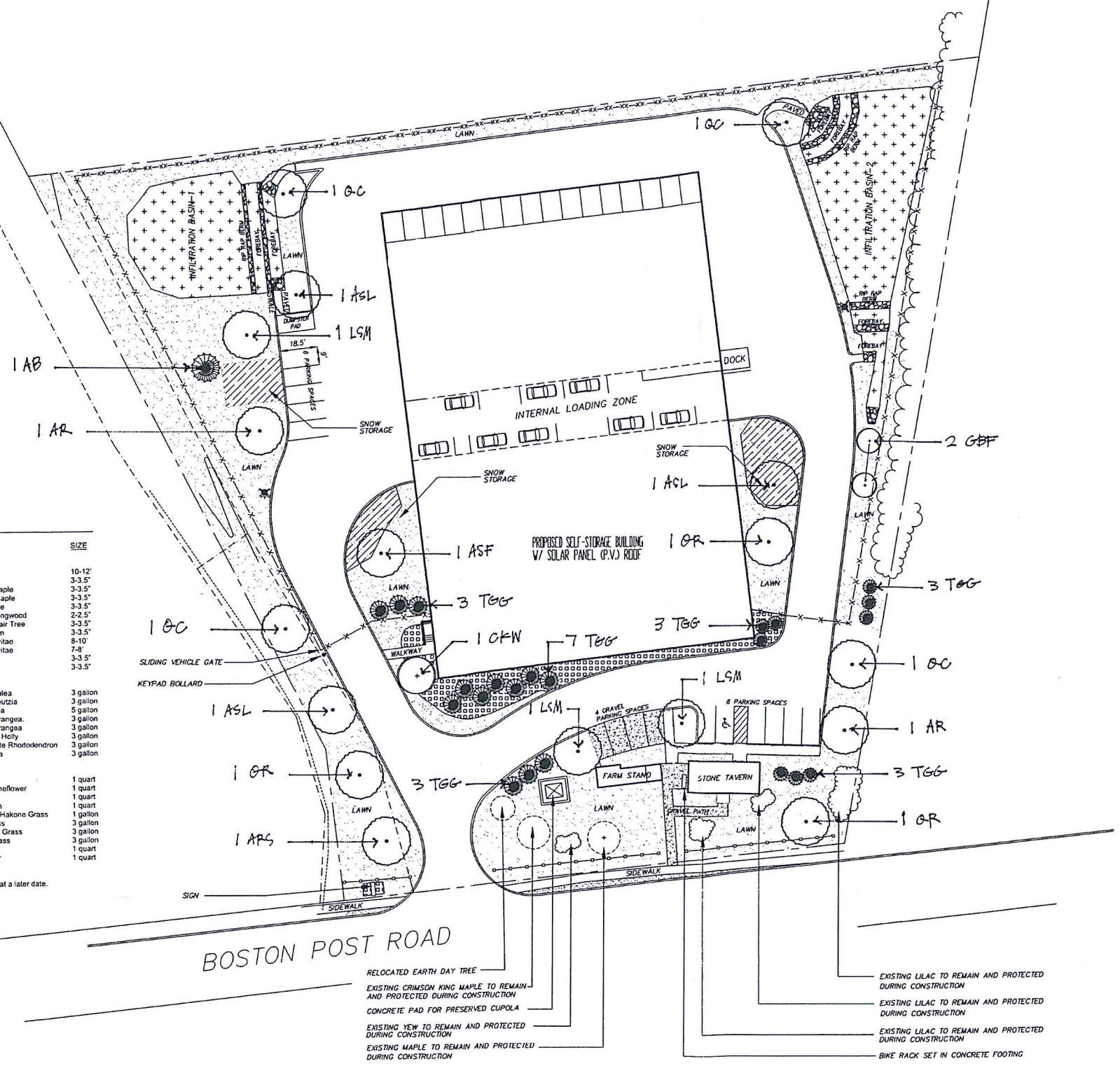

KEY	DESCRIPTION
—XX—XX—XX—XX—	8' BLACK CHAIN LINK FENCE WITH VINYL SLATS
—X—X—X—X—X—	6' BLACK CHAIN LINK FENCE
---	PROPERTY LINE
~~~~~	EXISTING VEGETATION TO REMAIN
⊕	EXISTING SHRUBS TO REMAIN
⊕	PLANT BEDS
⊕	LAWN
⊕	NEW ENGLAND EROSION CONTROL & RESTORATION MIX
⊕	SNOW STORAGE AREA
⊕	GRAVEL W/ STEEL EDGING
⊕	EXISTING TREES TO BE SAVED AND PROTECTED DURING CONSTRUCTION
⊕	DECIDUOUS SHADE TREE
⊕	ORNAMENTAL TREE
⊕	EVERGREEN TREE
⊕	MASONRY WALL
⊕	SPLIT-RAIL FENCE

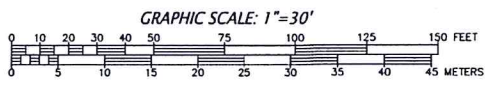

RECEIVED  
 SEP 11 2019  
 BY: .....

APPROVED BY: _____  
 _____  
 _____  
 _____  
 DATE: _____

OWNER: ANNE STONE  
 554 BOSTON POST ROAD  
 SUDBURY, MA 01776  
 APPLICANT: 554 BPR LLC  
 80 UNION AVENUE  
 SUDBURY, MA 01776

SCHREIBER ASSOCIATES  
 LANDSCAPE ARCHITECTS

LANDSCAPE PLAN  
 OF  
 554 BOSTON POST ROAD  
 IN  
 SUDBURY, MA

APPROVED  
 SEP 11 2019  
 PLANNING BOARD  
 TOWN OF SUDBURY

REVISED	DESCRIPTION
6/10/19	
7/9/19	
7/16/19	
8/5/19	
8/14/19	
8/26/19	
DRAWN BY: PTM	CHECK BY: QN
DATE: August 26, 2019	
SCALE: 1"=30'	