Summary of Environmental Conditions

*Presentation to the Sudbury Planning Board
528 Boston Post Road, Sudbury, MA*

Patricia M. Pinto, P.E., LSP

RAWN FROM A PLAN ENTITLED, "EXISTING CONDITIONS PLAN BY VANASSE HANGEN BRUSTLIN, INC. (VHB) OF TED OCTOBER 12, 2015 WITH AN ORIGINAL SCALE OF 1" = 40'.

ATED SH-3 THROUGH SH-7 WERE ADVANCED BY OSEARCH) OF FITCHBURG, MA AND OBSERVED BY EEN MAY 27 AND 29, 2015.

ATED SH-8 THROUGH SH-10 WERE ADVANCED BY ERVED BY SANBORN HEAD ON MAY 29, 2015.

ATED SH-1(W) THROUGH SH-2(W) WERE ADVANCED BY ERVED BY SANBORN HEAD BETWEEN MAY 27 AND 28, 2015.

IONS OF EXPLORATIONS BY SANBORN HEAD ARE BASED ON TS MADE IN THE FIELD RELATIVE TO PROMINENT SITE I SHOULD BE CONSIDERED ACCURATE ONLY TO THE HE METHOD USED.

IONS OF EXPLORATIONS BY OTHERS ARE BASED ON PLANS A SHOULD BE CONSIDERED ACCURATE ONLY TO THE HE METHOD USED.

LEGEND:

- SH-5 APPROXIMATE LOCATION AND DESIGNATION OF TEST BORING BY SANBORN HEAD (MAY 2015)
- SH-1(W) APPROXIMATE LOCATION AND DESIGNATION TEST BORING COMPLETED AS A MONITORING WELL BY SANBORN HEAD (MAY 2015)
- SH-10 APPROXIMATE LOCATION AND DESIGNATION OF SHALLOW TEST BORING BY SANBORN HEAD (MAY 2015)
- QZ-4 APPROXIMATE LOCATION AND DESIGNATION OF MONITORING WELL BY OTHERS
- QZ-7 APPROXIMATE LOCATION OF DESTROYED MONITORING WELL

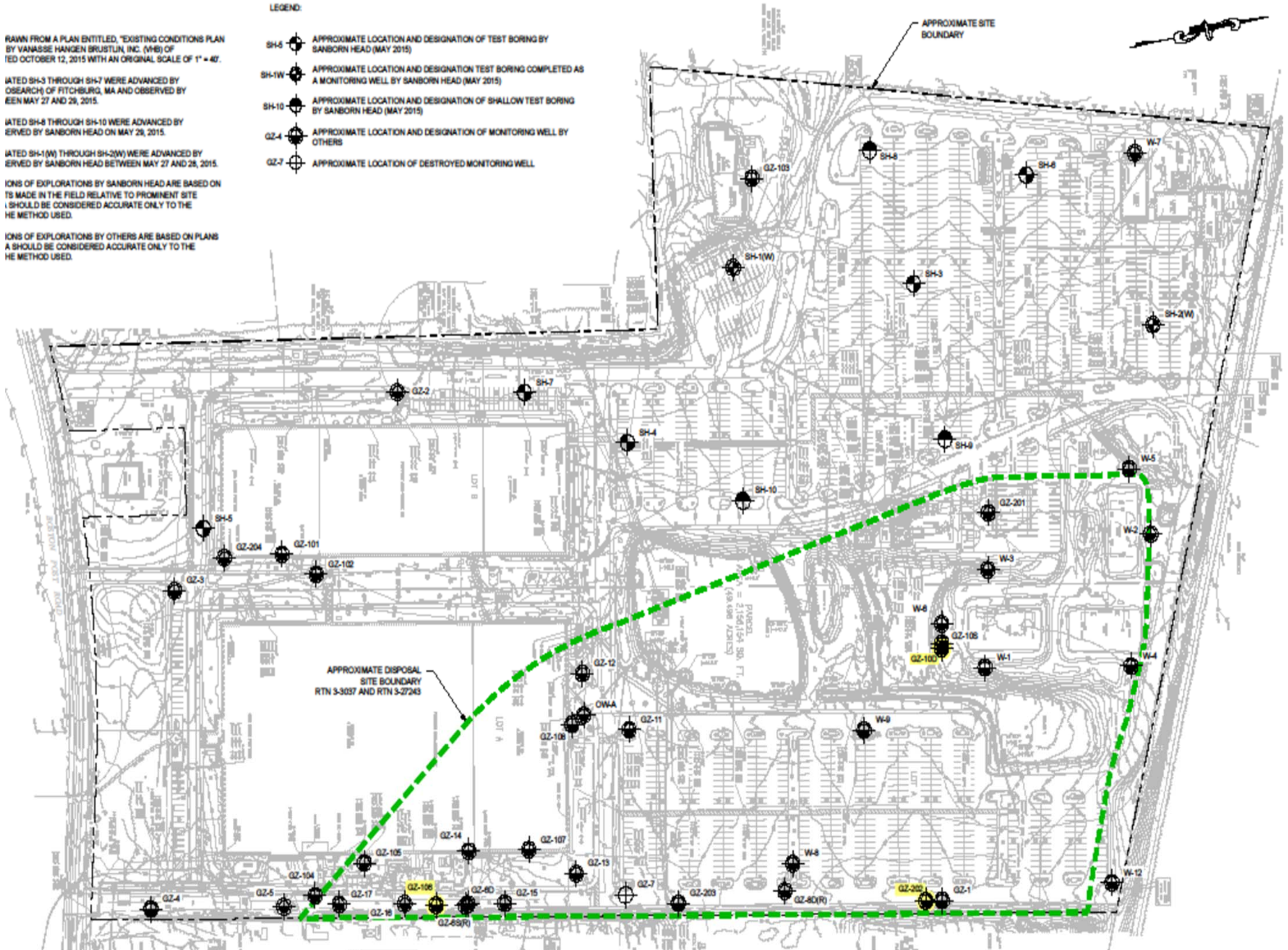

MCP Status

- RTN 3-3037 - Related to chlorinated volatile organic compounds (CVOCs) in groundwater first identified in 1990 and 1991. Achieved closure in 1997 (Pending No Further Action Status).
- 1987 spill of 35 gallons of No. 2 Fuel Oil from an underground storage tank. Documented under RTN 3-3037. Reached closure in 1990.

MCP Status

- RTN 3-27243 – Notification of the same CVOC condition in 2007 due to updated MCP rules. Achieved a Temporary Solution in 2008. Raytheon has continued responsibility to monitor.
- RTN 3-17106 – 1998 spill of 15 to 20 gallons of hydraulic oil from overturned crane. Achieved a Permanent Solution in 1998.

Current Conditions

- Most recent sampling in March 2015
- Concentrations of trichloroethylene (TCE) in groundwater exceed MCP standards at two deep wells
 - GZ-10D and GZ-202
 - Approximately 59 – 91 feet below ground
 - TCE not detected in shallower wells.

Current Conditions

- Freon 7 detected in one well exceeding risk based standard for vapor intrusion
 - GZ-106
 - Freon 7 not detected in surrounding wells
- No contamination in soil that would pose a health risk has been identified.
- Data indicates that groundwater contamination is not significantly impacting off-Site receptors

RAWN FROM A PLAN ENTITLED, "EXISTING CONDITIONS PLAN BY VANASSE HANGEN BRUSTLIN, INC. (VHB) OF TED OCTOBER 12, 2015 WITH AN ORIGINAL SCALE OF 1" = 40'.

ATED SH-3 THROUGH SH-7 WERE ADVANCED BY OSEARCH) OF FITCHBURG, MA AND OBSERVED BY EEN MAY 27 AND 28, 2015.

ATED SH-8 THROUGH SH-10 WERE ADVANCED BY ERVED BY SANBORN HEAD ON MAY 28, 2015.

ATED SH-1(W) THROUGH SH-2(W) WERE ADVANCED BY ERVED BY SANBORN HEAD BETWEEN MAY 27 AND 28, 2015.

IONS OF EXPLORATIONS BY SANBORN HEAD ARE BASED ON TS MADE IN THE FIELD RELATIVE TO PROMINENT SITE I SHOULD BE CONSIDERED ACCURATE ONLY TO THE HE METHOD USED.

IONS OF EXPLORATIONS BY OTHERS ARE BASED ON PLANS A SHOULD BE CONSIDERED ACCURATE ONLY TO THE HE METHOD USED.

LEGEND:

- SH-5 APPROXIMATE LOCATION AND DESIGNATION OF TEST BORING BY SANBORN HEAD (MAY 2015)
- SH-1(W) APPROXIMATE LOCATION AND DESIGNATION TEST BORING COMPLETED AS A MONITORING WELL BY SANBORN HEAD (MAY 2015)
- SH-10 APPROXIMATE LOCATION AND DESIGNATION OF SHALLOW TEST BORING BY SANBORN HEAD (MAY 2015)
- QZ-4 APPROXIMATE LOCATION AND DESIGNATION OF MONITORING WELL BY OTHERS
- QZ-7 APPROXIMATE LOCATION OF DESTROYED MONITORING WELL

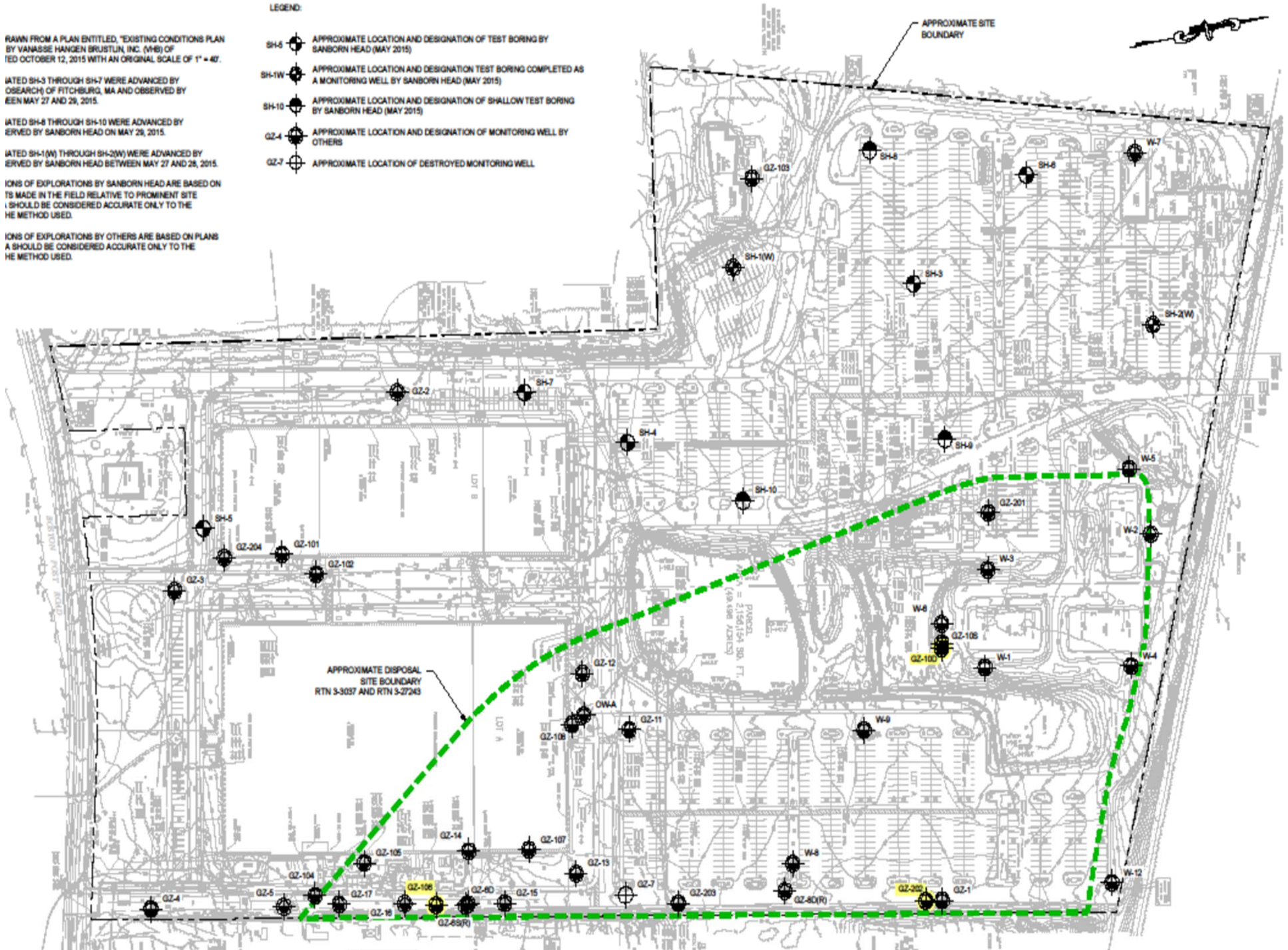

Redevelopment Project

- No drinking water wells are planned
- Vapor intrusion not a concern
 - If Site layout changes, we will evaluate further
- Construction in RTN area performed under a Release Abatement Measure (RAM) Plan
 - Soil management
 - Construction dewatering
 - Dust control
 - Air monitoring

Redevelopment Project

- Sanborn Head will provide monitoring and LSP services
- Protocol established for addressing unanticipated conditions
- Water infiltration after demolition or related to changes in waste water treatment and disposal system should not affect groundwater contamination due to location and depth

Conclusions

- Site has a long history and has been well studied
- Current conditions include the presence of TCE in two wells at depth and Freon 7 in one well at concentrations above standards
- Impacts to off-site receptors due to project are not anticipated
- Work will be performed in accordance with the MCP under the purview of an LSP

Questions?

Patricia M. Pinto, P.E., LSP
Vice President and Senior Associate
Sanborn, Head & Associates, Inc.
Phone: 978-392-0900
Email: ppinto@sanbornhead.com