

APPENDIX I –

Intensive Survey Artifacts Catalogue

Eversource Sudbury-Hudson MA Project Intensive Survey 2018 Catalogue

January 28, 2019

Page 1

Area	Test Pit	Layer	Depth	Cat.#	Era	Class	Material	Color	Description	Detail	Qty	Portion	Comments
JTP	JTP-01	Ao/AF	0-10 cm.	3	Historic	Glass	Vessel Glass	Clear	Bottle Glass	Machine-Made	2	Body Fragments	
JTP	JTP-01	Ao/AF	0-10 cm.	4	Historic	Glass	Vessel Glass	Amber	Bottle Glass	Machine-Made	1	Fragment	
JTP	JTP-04	Ao	0-10 cm.	11	Historic	Glass	Vessel Glass	Lt Green Tint	Bottle Glass	Machine-Made	1	Body Fragment	
JTP	JTP-04	Ao	0-10 cm.	12	Historic	Ceramic	Earthenware	Red	Brick		1	Fragment	
JTP	JTP-04	Ao	0-10 cm.	13	Historic	Metal	Ferrous Metal		Nail, Cut		1	Fragment	
JTP	JTP-04	A1	10-20 cm.	14	Historic	Glass	Vessel Glass	Clear	Bottle Glass	Machine-Made	2	Body Fragments	
T1	T1-02	Fill 1	10-20 cm.	1	Historic	Glass	Vessel Glass	Ruby Red	Lamp Glass	Mold-Blown	2	Fragments	Flashed Glass/RR Lanterns
T1	T1-02	Fill 1	10-20 cm.	2	Historic	Metal	Ferrous Metal		Square Nut	1.5"X1.5"	1	Intact	
T1	T1-03	Ao/A1	0-10 cm.	6	Historic	Glass	Vessel Glass	Lt Amethyst Tint	Bottle Glass	Mold-Blown/Machine-Made	3	Body Fragments	
T1	T1-03	Ao/A1	20-30 cm.	5	Historic	Metal	Ferrous Metal		Bolt, Threaded	2 3/4"L X 3/4"	1	Fragment	
T1	T1-04	Ao	0-10 cm.	7	Historic	Glass	Insulator Glass	Aqua	For Telegraph Pole	Pressed Glass	14	Fragments	2 Melted, 1 Embossed
T1	T1-04	B1	40-50 cm.	8	Historic	Glass	Insulator Glass	Aqua	For Telegraph Pole	Pressed Glass	8	Fragments	2 Melten/Burned Glass
T1	T1-04	B1	40-50 cm.	9	Historic	Metal	Ferrous Metal		Bent Strips	4-1/2"X1/2"	2	Intact	Bent to form hooks.
T1	T1-04	B1	40-50 cm.	10	Historic	Metal	Ferrous Metal		Nail, Wire	3.5"	1	Intact	
T1	T1-05	Ao	0-10 cm.	15	Historic	Glass	Insulator Glass	Aqua	For Telegraph Pole	Pressed Glass	3	Fragments	Embossed, "HEMIN..."
T1	T1-06	Ao/A1	0-10 cm.	16	Historic	Glass	Vessel Glass	Lt Green Tint	Bottle Glass	Machine-Made	3	Body Fragments	Red/White Decal, Painted or Pyroglazed on 2/3pc
T1	T1-08	Ao	0-10 cm.	17	Historic	Glass	Insulator Glass	Aqua	For Telegraph Pole	Pressed Glass	1	Fragment	
T1	T1-08	Ao	0-10 cm.	18	Historic	Metal	Ferrous Metal		Hardware, Nut	1 1/4"Sq X 3/4" Thick	1	Fragment	Nut w/ 3/4" Bolt
T1	T1-09	Ao	0-10 cm.	19	Historic	Glass	Insulator Glass	Aqua	For Telegraph Pole	Pressed Glass	3	Body Fragments	Embossed
T1	T1-10	Ao	0-10 cm.	20	Historic	Glass	Vessel Glass	Clear	Bottle Glass	Machine-Made	1	Body Fragment	
T1	T1-10	Ao	0-10 cm.	21	Historic	Glass	Vessel Glass	Clear	Lamp Glass	Thin	4	Fragments	
T2	T2-1	Ao	0-10 cm.	44	Historic	Glass	Insulator Glass	Aqua	For Telegraph Pole	Pressed Glass	1	Fragment	Embossed "W. BROOKFIELD 45 CLIFF ST. N.Y."
T2	T2-1	Ao	0-10 cm.	45	Historic	Glass	Insulator Glass	Aqua	For Telegraph Pole	Pressed Glass	5	Fragments	
T2	T2-1	Ao	0-10 cm.	46	Historic	Metal	Ferrous Metal		Square Nut	1 1/4" X 3/4"	1	Intact	
T2	T2-7	A1	20-30 cm.	47	Historic	Glass	Vessel Glass	Clear	Bottle Glass	Mold-Blown	1	Bottle Neck/Lip	Applied Lip
T2	T2-8	Ao/A1	0-10 cm.	43	Historic	Glass	Vessel Glass	Amethyst Tint	Milk Bottle	Mold-Blown/Machine-Made	1	Fragment	Embossed w/ "Guernsey Milk & Cream; Hardwick", "MA" Mends to Pieces From 10-20 cm. Pieces mend with fragment from 0-10 cm; embossed: HARDWICK".
T2	T2-8	A1	10-20 cm.	39	Historic	Glass	Vessel Glass	Amethyst Tint	Milk Bottle	Machine-Made	3	Base And Body	
T2	T2-9	Ao/A1	0-10 cm.	40	Historic	Glass	Flat Glass	Lt Green Tint	Window Glass		1	Fragment	
T2	T2-9	Ao/A1	0-10 cm.	41	Historic	Glass	Vessel Glass	Aqua Tint	Bottle Glass	Mold-Blown/Machine-Made	1	Fragment	
T2	T2-9	A1/B1	20-30 cm.	48	Historic	Metal	Ferrous Metal		Railroad Spike	5" Long	1	Near Intact	Corroded
T3	JTP-06	Ao	0-10 cm.	42	Historic	Metal	Ferrous Metal		S Hook	1/4" Diam	1	Near Intact	1/8" thick Wire Attached
T3	T3-02	A1	10-20 cm.	22	Historic	Glass	Vessel Glass	Clear	Bottle Glass	Machine-Made	8	Body Fragments	Square Milk Bottle, +1945, Applied Color Label Decal: "Hudson Dairy"
T3	T3-02	A1	10-20 cm.	23	Historic	Glass	Insulator Glass	Aqua	For Telegraph Pole	Pressed Glass	1	Body Fragment	

Eversource Sudbury-Hudson MA Project Intensive Survey 2018 Catalogue

January 28, 2019

Page 2

Area	Test Pit	Layer	Depth	Cat.#	Era	Class	Material	Color	Description	Detail	Qty	Portion	Comments
T3	T3-02	A1	10-20 cm.	24	Historic	Ceramic	Earthenware	Red	Brick		1	Fragment	
T3	T3-02	A1	10-20 cm.	25	Historic	Metal	Ferrous Metal		Railroad Spike	6" L X 1 3/4" Wide	1	Intact	
T3	T3-03	Ao	0-10 cm.	26	Historic	Metal	Ferrous Metal		Railroad Spike	5" X 5/8" X 1/2"	1	Intact	Missing Head
T3	T3-09	Ao	0-10 cm.	27	Historic	Glass	Vessel Glass	Clear	Bottle Glass	Mold-Blown/Machine-Made	2	Body Fragments	
T3	T3-10	Ao	0-10 cm.	28	Historic	Glass	Vessel Glass	Lt Amethyst Tint	Bottle Glass	Mold-Blown/Machine-Made	2	Body Fragments	Air Bubbles
T3	T3-13	B1	30-40 cm.	29	Precontact	Stone	Rhyolite	Black	Flake, Trim	10-15mm	1	Debitage	CWP
T3	T3-13	B1	30-40 cm.	30	Precontact	Stone	Hornfels	Gray	Flake, Secondary	26x15x4mm	1	Debitage	Patination
T3	T3-13	B1/B2	40-50 cm.	31	Precontact	Stone	Rhyolite	Gray	Flake, Secondary	10-15mm	1	Debitage	Possibly Utilized, IWP
T3	T3-13S	Fill 1	10-20 cm.	32	Historic	Glass	Vessel Glass	Olive Green	Bottle Glass	Mold-Blown/Machine-Made	1	Body Fragment	
T3	T3-13S	Fill 1	10-20 cm.	33	Historic	Glass	Flat Glass	Aqua Tint	Window Glass		1	Fragment	
T3	T3-13S	Fill 1	10-20 cm.	159	Historic	Glass	Vessel Glass	Clear	Bottle Glass	Mold-Blown/Machine-Made	3	Body Fragments	
T3	T3-13S	Fill 1	10-20 cm.	973	Historic	Glass	Vessel Glass	Clear	Table Glass	Etched	1	Body Fragment	1
T3	T3-13S	Fill 1	10-20 cm.	974	Historic	Glass	Vessel Glass	Clear	Table/Lamp Glass		5	Fragments	
T3	T3-13S	Fill 1	20-30 cm.	36	Historic	Metal	Ferrous Metal		Hardware	4.5"X1"X1/8"	1	Near Intact	Iron Bracket, "S" Shaped, Rusted
T3	T3-13S	Fill 1	20-30 cm.	37	Historic	Glass	Vessel Glass	Clear	Lamp Glass	Free-blown	1	Rim Fragment	
T3	T3-13S	Fill 1	20-30 cm.	975	Historic	Glass	Vessel Glass	Clear	Bottle/Table	Mold-Blown/Machine-Made	1	Body Fragment	
T3	T3-13W	B1	30-40 cm.	34	Precontact	Stone	Quartzite	Tan/Gray	Shatter, Decortication	25-30mm	1	Fragment	Cobble fragment
T3	T3-13W	B1	30-40 cm.	35	Precontact	Stone	Granite	Tan/Red	Fire-cracked Rock	31g	1	Fragment	Cobble with cortex
T3	T3-14	A1/B1	30-40 cm.	38	Historic	Metal	Ferrous Metal		Railroad Spike	5-1/2"X1-1/2"	1	Intact	
T5	T5-1	Ao	0-10 cm.	181	Historic	Glass	Insulator Glass	Aqua Tint	For Telegraph Pole	Pressed Glass	2	Fragments	
T5	T5-3	Ao	0-10 cm.	176	Historic	Ceramic	Earthenware	Orange Dec.	Whiteware	Overglaze	1	Rim Fragment	
T5	T5-3	Fill 1	20-30 cm.	180	Historic	Glass	Insulator Glass	Aqua Tint	For Telegraph Pole	Pressed Glass	1	Fragment	Threaded
T5	T5-4	Ao	0-10 cm.	179	Historic	Metal	Ferrous Metal		1/2" Threaded Nut	Square Shaped Nut	1	Intact	
T5	T5-4	B1	50-60 cm.	175	Historic	Metal	Cuprous Metal		Copper Wire		3	Fragments	
T6	JTP-07	Ao	0-10 cm.	186	Historic	Ceramic	Earthenware	Red	Brick		5	Fragments	
T6	JTP-07	Fill 1	10-20 cm.	193	Historic	Composite	Mortar				3	Fragments	
T6	JTP-07	Fill 1	10-20 cm.	194	Historic	Ceramic	Earthenware	Red	Brick		4	Fragments	Small Fragments
T6	JTP-07	Fill 1	10-20 cm.	195	Historic	Glass	Flat Glass	Clear/Tint	Window Glass		5	Fragments	
T6	JTP-07	Fill 1	10-20 cm.	196	Historic	Glass	Vessel Glass	Clear	Bottle Glass	Machine-Made	1	Fragment	
T6	JTP-07	Fill 1	10-20 cm.	197	Historic	Metal	Ferrous Metal		Nail, Cut		2	Intact	Attached to slag.
T6	JTP-07	Fill 1	10-20 cm.	198	Historic	Metal	Ferrous Metal		Nail, Cut		2	Intact	
T6	JTP-07	Fill 1	20-30 cm.	109	Historic	Ceramic	Earthenware	Red	Brick	W/ Mortar	1	Near Intact	
T6	JTP-07	Fill 1	20-30 cm.	110	Historic	Composite	Mortar				1	Near Intact	
T6	JTP-07	Fill 1	20-30 cm.	187	Historic	Wood	Wood Plank	Unpainted	Trim Or Wall Slat		1	Fragment	At 30 cmbs against chimney base.
T6	JTP-07	Fill 1	20-30 cm.	188	Historic	Glass	Flat Glass	Clear	Window Glass		2	Fragments	
T6	JTP-07	Fill 1	20-30 cm.	189	Historic	Ceramic	Earthenware	Red	Brick		3	Fragments	
T6	JTP-07	Fill 1	20-30 cm.	190	Historic	Composite	Mortar				3	Fragments	

CWP = Conspicuous White Phenocrysts; I = Inconspicuous; B = Black, G = Glassy; FCR = fire-cracked rock

Eversource Sudbury-Hudson MA Project Intensive Survey 2018 Catalogue

January 28, 2019

Page 3

Area	Test Pit	Layer	Depth	Cat.#	Era	Class	Material	Color	Description	Detail	Qty	Portion	Comments
T6	JTP-07	Fill 1	20-30 cm.	191	Historic	Metal	Ferrous Metal		Nail, Cut/Wire		3	Intact	
T6	JTP-07	Fill 1	20-30 cm.	192	Historic	Metal	Ferrous Metal		Nail, Cut		3	Intact	
T6	JTP-07	Fill 1	30-40 cm.	185	Historic	Glass	Flat Glass	Clear	Window Glass		1	Fragment	
T6	JTP-07	C	40-50 cm.	182	Historic	Glass	Flat Glass	Clear	Window Glass		2	Fragments	
T6	JTP-07	C	40-50 cm.	183	Historic	Metal	Ferrous Metal		Nail, Cut		2	Near Intact	
T6	JTP-07	C	40-50 cm.	184	Historic	Metal	Ferrous Metal		Nail, Cut	Burnt	1	Intact	
T6	JTP-08	A1	0-10 cm.	111	Historic	Glass	Flat Glass	Lt Green Tint	Window Glass		1	Fragment	
T6	JTP-08	A1	0-10 cm.	112	Historic	Glass	Vessel Glass	Green	Bottle Glass	Mold-Blown/Machine-Made	1	Body Fragment	
T6	JTP-08	A1	0-10 cm.	113	Historic	Metal	Ferrous Metal		Nail, Wire		1	Near Intact	Heavily Corroded
T6	JTP-08	A1	0-10 cm.	114	Historic	Glass	Glass Slag		Glass Slag		1	Fragment	
T6	JTP-08	A1	10-20 cm.	122	Historic	Metal	Ferrous Metal		Nail, Cut		2	Fragments	Corroded
T6	JTP-08	A1	10-20 cm.	123	Historic	Metal	Ferrous Metal		Nail, Cut	3 3/4"	1	Near Intact	Corroded
T6	JTP-08	A1	10-20 cm.	124	Historic	Glass	Flat Glass	Lt Green Tint	Window Glass		3	Fragments	
T6	JTP-08	A1	10-20 cm.	125	Historic	Glass	Vessel Glass	Aqua Tint	Bottle Glass	Mold-Blown/Machine-Made	2	Body Fragments	
T6	JTP-08	A1	10-20 cm.	126	Historic	Glass	Vessel Glass	Green	Bottle Glass	Machine-Made	1	Body Fragment	
T6	JTP-08	A1	10-20 cm.	127	Historic	Glass	Vessel Glass	Clear	Bottle Glass	Machine-Made	1	Base Fragment	
T6	JTP-09	F1/F2	20-30 cm.	54	Historic	Metal	Lead	Gray	Cast	Indeterminate	1	Fragment	Folded/Hollow Cast Metal
T6	JTP-09	F1/F2	20-30 cm.	86	Historic	Glass	Vessel Glass	Aqua Tint	Bottle Glass	Mold-Blown/Machine-Made	1	Fragment	
T6	JTP-09	F1/F2	20-30 cm.	87	Historic	Glass	Vessel Glass	Clear	Bottle Glass	Machine-Made	1	Fragment	
T6	JTP-09	F1/F2	20-30 cm.	88	Historic	Glass	Flat Glass	Lt Green Tint	Window Glass		1	Fragment	
T6	JTP-09	Fill 2	20-30cm	143	Historic	Metal	Ferrous Metal		Pipe	7x1.25"	1	Fragment	Corroded
T6	JTP-09	Fill 2	30-40 cm.	101	Historic	Metal	Ferrous Metal		Nail, Cut	1 1/2" Long	1	Fragment	Corroded
T6	JTP-09	Fill 2	30-40 cm.	102	Historic	Ceramic	Ball Clay	Off White	Pipe Bowl	4/64" Bore	1	Fragment	W/ Stem & Spur
T6	JTP-10	Ao	0-10 cm.	211	Historic	Glass	Vessel Glass	Clear	Bottle Glass	Machine-Made	1	Bottle Base	Stippled.
T6	JTP-10	Fill 1	30-40 cm.	212	Historic	Glass	Vessel Glass	Clear	Bottle Glass	Machine-Made	3	Fragments	Lug-threaded lip.
T6	JTP-10	B2	50-60 cm.	115	Historic	Wood	Lumber		Clapboard	3.5x5x1/4"	1	Fragment	
T6	JTP-10	Surface	Surface	116	Historic	Metal	Ferrous Metal		Cast Bracket	4.25x3.75x2.25"	1	Intact	Thick & heavy; machinery componer
T6	JTP-11A	Fill 2	10-20 cm.	199	Historic	Ceramic	Brick	Red	Brick		4	Fragments	
T6	JTP-11A	Fill 2	10-20 cm.	200	Historic	Metal	Ferrous Metal		Sheet Metal		2	Fragments	
T6	JTP-11A	Fill 2	10-20 cm.	201	Historic	Glass	Vessel Glass	Clear	Bottle Glass	Machine-Made	8	Fragments	
T6	JTP-11A	Fill 2	10-20 cm.	202	Historic	Metal	Ferrous Metal		Nail, Wire		1	Fragment	
T6	JTP-11A	Fill 2	10-20 cm.	203	Historic	Ceramic	Earthenware	Lt Yellow	Refined, 20 C.	Gilt Rim	3	Rim/Body Frags	2 mend.
T6	JTP-11A	Fill 1	10-20 cm.	204	Historic	Ceramic	Earthenware		Whiteware	Plain	1	Fragment	
T6	JTP-11A	Fill 2	10-20 cm.	448	Historic	Glass	Vessel Glass	Clear	Bottle Glass	Machine-Made	1	Lip	Threaded lip
T6	JTP-11A	Fill 2	10-20 cm.	449	Historic	Glass	Vessel Glass	Amber	Bottle Glass	Machine-Made	1	Body Fragment	
T6	JTP-11A	Fill 2	10-20 cm.	450	Historic	Glass	Flat Glass	Clear	Window Glass		1	Fragment	
T6	JTP-11A	Fill 2	10-20 cm.	451	Historic	Glass	Glass	Clear	Melted	Indeterminate	1	Fragment	

Eversource Sudbury-Hudson MA Project Intensive Survey 2018 Catalogue

January 28, 2019

Page 4

Area	Test Pit	Layer	Depth	Cat.#	Era	Class	Material	Color	Description	Detail	Qty	Portion	Comments
T6	JTP-11A	Fill 2	20-30 cm.	207	Historic	Composite	Asbestos	Gray	Tile	W/ Asphalt	3	Fragments	
T6	JTP-11A	Fill 2	20-30 cm.	208	Historic	Ceramic	Earthenware	Red/Gray	Brick	W/ Mortar	2	Fragments	
T6	JTP-11A	Fill 2	20-30 cm.	209	Historic	Glass	Vessel Glass	Green	Bottle Glass	Machine-Made	1	Fragment	
T6	JTP-11A	Fill 2	20-30 cm.	210	Historic	Glass	Vessel Glass	Clear	Bottle Glass	Machine-Made	4	Fragments	Condiment/olive jar, threaded tip; Base embossed: "Design/Pat'D".
T6	JTP-11A	Fill 3	30-40 cm.	144	Historic	Ceramic	Earthenware	Red	Brick	1g	1	Fragment	
T6	JTP-11A	Fill 3	30-40 cm.	145	Historic	Glass	Flat Glass	Lt Green Tint	Window Glass		3	Fragments	
T6	JTP-11A	Fill 3	30-40 cm.	146	Historic	Glass	Vessel Glass	Clear	Bottle Glass	Machine-Made	8	Body Fragments	
T6	JTP-11A	Fill 3	30-40 cm.	147	Historic	Metal	Ferrous Metal		Sheet Metal		1	Fragment	
T6	JTP-11A	Fill 3	30-40 cm.	148	Historic	Composite	Composite		Tile W/ Mortar?		2	Fragments	
T6	JTP-11A	Fill 3	40-50 cm.	130	Historic	Glass	Vessel Glass	Clear	Jar Glass	Machine-Made	1	Rim/Neck Frag	Threaded.
T6	JTP-11A	Fill 3	40-50 cm.	131	Historic	Glass	Flat Glass	Lt Green Tint	Window Glass		2	Fragments	
T6	JTP-11A	Fill 3	40-50 cm.	132	Historic	Metal	Ferrous Metal		Nail, Cut	1 3/4"	1	Near Intact	Heavily Corroded
T6	JTP-11A	Fill 3	40-50 cm.	133	Historic	Coal-Related	Coal Products		Slag		5	Fragments	
T6	JTP-11A	Fill 3	40-50 cm.	134	Historic	Ceramic	Earthenware	Red	Brick	5g	1	Fragment	
T6	JTP-11A	Fill 3	40-50 cm.	135	Historic	Composite	Mortar			42g	1	Fragment	
T6	JTP-11A	Fill 3	50-60 cm.	149	Historic	Glass	Vessel Glass	Clear	Bottle Glass	Machine-Made	1	Body Fragment	
T6	JTP-11A	Fill 3	50-60 cm.	150	Historic	Metal	Ferrous Metal		Nail, Cut		2	Fragments	
T6	JTP-11A	Fill 3	50-60 cm.	151	Historic	Coal-Related	Coal Products		Burned	Cinder, Slag	3	Fragments	
T6	JTP-11B	Fill 2	30-40 cm.	205	Historic	Coal-Related	Coal Products		Coal, Burned	Cinder	1	Fragment	
T6	JTP-11B	Fill 2	30-40 cm.	206	Historic	Metal	Ferrous Metal		Can		2	Rim Fragments	
T6	T6-3	Fill 1	30-40 cm.	177	Historic	Glass	Vessel Glass	Lt Amethyst Tint	Bottle Glass	Mold-Blown/Machine-Made	1	Body Fragment	
T6	T6-4	A1	20-30 cm.	178	Historic	Glass	Vessel Glass	Clear	Bottle Glass	Mold-Blown/Machine-Made	1	Body Fragment	
T6	T6-5	B1/B2	40-50 cm.	128	Historic	Glass	Vessel Glass	Clear	Bottle/Table	Machine-Made	1	Body Fragment	
T6	T6-5	B1/B2	40-50 cm.	129	Unknown	Stone	Quartz	Smoky	Shatter/Spall?	10-15mm	1	Fragment	Possibly cultural.
T7	T7-01	Fill 1	20-30 cm.	49	Precontact	Stone	Quartz	Smoky	Shatter, Secondary	20-25mm	1	Debitage	
T7	T7-01	Fill 2	50-60 cm.	51	Historic	Glass	Vessel Glass	Amber	Bottle Glass	Machine-Made	1	Body Fragment	
T7	T7-01E	Fill 1	0-10 cm.	63	Historic	Glass	Flat Glass	Clear	Window Glass		1	Fragment	
T7	T7-01E	Fill 1	20-30 cm.	64	Historic	Glass	Vessel Glass	Clear	Bottle Glass	Machine-Made	4	Fragments	One Frag Embossed w/ "PR"
T7	T7-01E	Fill 1	20-30 cm.	65	Historic	Composite	Mortar	Blue		Painted Blue	1	Fragment	Painted Blue Over Light Blue
T7	T7-01W	Fill 1	0-10 cm.	52	Historic	Metal	Aluminum	Brown	Bottle Cap		1	Fragment	Crushed Bottle Cap
T7	T7-01W	Ao/F1	10-20 cm.	50	Historic	Glass	Vessel Glass	Lt Green	Bottle Glass	Machine-Made	1	Body Fragment	
T7	T7-01W	Fill 1	30-40 cm.	117	Historic	Synthetic	Plastic	White	Hard	1/8" Thick	1	Fragment	
T7	T7-01W	Fill 1	30-40 cm.	118	Historic	Synthetic	Plastic	White	Hard	Flat	1	Fragment	
T7	T7-01W	Fill 1	30-40 cm.	119	Historic	Synthetic	Plastic	Green	Hard	3/32" Thick	1	Fragment	
T7	T7-01W	Fill 1	30-40 cm.	120	Historic	Composite	Coal Products		Coal, Burned	Clinker	1	Fragment	
T7	T7-01W	B1	60-70 cm.	53	Historic	Glass	Vessel Glass	Clear	Bottle Glass	Machine-Made	1	Fragment	

Eversource Sudbury-Hudson MA Project Intensive Survey 2018 Catalogue

January 28, 2019

Page 5

Area	Test Pit	Layer	Depth	Cat.#	Era	Class	Material	Color	Description	Detail	Qty	Portion	Comments
T7	T7-02	Fill 1	20-30cm	137	Historic	Metal	Ferrous Metal		Sheet Metal	Crimped Edge	4	Fragments	Corroded Rim/Barrel or Tub
T7	T7-02	Fill 1	30-40 cm.	138	Historic	Metal	Ferrous Metal		Sheet Metal	Trim	1	Fragment	Corroded
T7	T7-02	Fill 1	30-40 cm.	139	Historic	Glass	Vessel Glass	Clear	Bottle Glass	Machine-Made	2	Shards	Pieces Mend
T7	T7-02	Fill 1	40-50 cm.	136	Historic	Glass	Vessel Glass	Clear	Bottle Glass	Machine-Made	3	Body Fragments	
T7	T7-02	Buried A	90-100 cm.	141	Historic	Metal	Ferrous Metal		Nail, Indeterminate	1.5"L	1	Intact	
T7	T7-02	Buried A	90-100cm	140	Historic	Metal	Ferrous Metal		Sheet Metal	Trim	1	Fragment	Bent Rim
T7	T7-02	Buried A	90-100cm	142	Historic	Glass	Vessel Glass	Amber	Bottle Glass	Machine-Made	1	Body Fragment	
T7	T7-05	Ao	0-10 cm.	121	Historic	Ceramic	Earthenware		Whiteware	Plain	3	Fragments	
T7	T7-09	Ao	10-20 cm.	56	Historic	Synthetic	Plastic	Black	Sheet Plastic	4 1/2"X2"X1/4"	1	Fragment	Rectangular Slab
T7	T7-18	Ao	0-10 cm.	59	Historic	Ceramic	Earthenware	Polychrome	Whiteware	Hand-Painted	2	Fragments	1 Plain Spall
T7	T7-19	A1/B1	30-40 cm.	57	Historic	Ceramic	Earthenware	Dk Brown Glaze	Redware	Lead Glazed	1	Rim Fragment	
T7	T7-21	A1	0-10 cm.	68	Historic	Metal	Ferrous Metal		Nail, Cut		1	Near Intact	
T7	T7-21	A1	0-10 cm.	393	Historic	Metal	Ferrous Metal		Nail, Cut		1	Fragment	
T7	T7-21	A1	0-10 cm.	394	Historic	Metal	Ferrous Metal		Nail, Wire		1	Near Intact	
T7	T7-21	A1	10-20 cm.	60	Historic	Glass	Vessel Glass	Lt Amethyst Tint	Milk Bottle Glass	Machine-Made	2	Bottle Neck	"Hardwick" "K, Mass"
T7	T7-21	A1	10-20 cm.	61	Historic	Paper	Booklet Page	Brown	Indeterminate		1	Fragment	Possible Booklet/Catalogue "Plugs"
T7	T7-21	A1	10-20 cm.	62	Historic	Glass	Vessel Glass	Smoky	Melted Glass		1	Fragment	
T7	T7-21	B1	30-40 cm.	55	Historic	Ceramic	Earthenware	Red	Brick		1	Fragment	
T8	T8-01	Ao	10-20 cm.	78	Historic	Metal	Ferrous Metal		Hardware, S Hook	3-1/4x2-1/2"	1	Near Intact	Bent strip.
T8	T8-02	Ao	0-10 cm.	74	Historic	Metal	Aluminum		Can		2	Fragments	Embossed "Please do not litter"
T8	T8-02	A1	10-20 cm.	75	Historic	Glass	Vessel Glass	Clear	Bottle Glass	Machine-Made	1	Body Fragment	Applied color label: "Tater Beverage Co. Fitchburg, Mass."
T8	T8-02	A1	20-30 cm.	76	Historic	Ceramic	Earthenware		Whiteware	Plain	1	Body Fragment	
T8	T8-02	A1	20-30 cm.	77	Historic	Ceramic	Earthenware	Yellow	Yellowware	Lead-glazed	1	Body Fragment	
T8	T8-03	A1	10-20 cm.	79	Historic	Glass	Vessel Glass	Amethyst Tint	Bottle Glass	Mold-Blown	1	Bottle Base	
T8	T8-03	A1	10-20 cm.	80	Historic	Ceramic	Porcelain	White	Pull Handle		1	Near Intact	
T8	T8-03	A1	20-30 cm.	58	Historic	Glass	Vessel Glass	Amber	Bottle Glass	Machine-Made	1	Fragment	
T8	T8-04	Ao	0-10 cm.	89	Historic	Glass	Insulator Glass	Aqua	For Telegraph Pole	Pressed Glass	1	Fragment	Embossed w/ "TEL & TEL Co"
T8	T8-04	Ao	0-10 cm.	90	Historic	Glass	Insulator Glass	Aqua	For Telegraph Pole	Pressed Glass	3	Fragments	
T8	T8-04	Ao	0-10 cm.	91	Historic	Synthetic	Nylon	Blue	Nylon Thread	8"	1	Fragment	
T8	T8-04	Ao	0-10 cm.	92	Historic	Synthetic	Plastic	Clear			2	Fragments	
T8	T8-04	A1	10-20 cm.	69	Historic	Glass	Vessel Glass	Amber	Bottle Glass	Machine-Made	2	Fragments	
T8	T8-08	B1	40-50 cm.	66	Historic	Ceramic	Earthenware		Redware	Missing Surfaces	1	Fragment	
T8	T8-09	Fill 1	30-40 cm.	83	Historic	Ceramic	Earthenware		Whiteware	Plain	1	Body Fragment	
T8	T8-12	A1	20-30 cm.	105	Historic	Ceramic	Earthenware	Red	Brick	<1g	1	Fragment	
T8	T8-13	A1	0-10 cm.	70	Historic	Glass	Vessel Glass	Green	Bottle Glass	Machine-Made	1	Neck Fragment	Beer, Modern
T8	T8-13	A1	10-20 cm.	67	Historic	Ceramic	Earthenware		Redware	Missing Surfaces	1	Fragment	

Eversource Sudbury-Hudson MA Project Intensive Survey 2018 Catalogue

January 28, 2019

Page 6

Area	Test Pit	Layer	Depth	Cat.#	Era	Class	Material	Color	Description	Detail	Qty	Portion	Comments
T8	T8-16	A1/B1	30-40 cm.	71	Historic	Metal	Ferrous Metal		Nail, Cut		1	Intact	
T8	T8-20	A1	20-30 cm.	82	Historic	Glass	Flat Glass	Aqua Tint	Window Glass	Cylinder	1	Fragment	
T8	T8-22	A1	10-20 cm.	84	Historic	Ceramic	Earthenware	Red	Brick		1	Fragment	
T8	T8-23	B1	30-40 cm.	72	Historic	Ceramic	Earthenware		Redware	Lead Glazed	1	Body Fragment	Missing Interior.
T8	T8-24	Ao	10-20 cm.	73	Historic	Ceramic	Earthenware		Redware	Unglazed Exterior	3	Fragments	Pieces Mend; Missing Interior.
T8	T8-24	A1	20-30 cm.	93	Historic	Ceramic	Earthenware		Whiteware	Plain	1	Rim Fragment	May Be Burnt Pearlware.
T8	T8-25	A1	20-30 cm.	214	Historic	Glass	Flat Glass	Lt Green Tint	Window Glass		1	Fragment	
T8	T8-26	A1	20-30 cm.	215	Historic	Metal	Ferrous Metal		Circular Machine Part	2-5/8" Dia	1	Fragment	With spokes and hole in center
T8	T8-27	A1	10-20 cm.	218	Historic	Ceramic	Earthenware	White	Whiteware	Plain	1	Body Fragment	
T8	T8-27	A1	10-20 cm.	219	Historic	Glass	Insulator Glass	Aqua Tint	For Telegraph Pole	Pressed Glass	1	Rim Fragment	
T8	T8-27	B1	40-50 cm.	220	Historic	Metal	Ferrous Metal		Wire	1/8" Dia Wire	1	Fragment	
T8	T8-35	Ao	0-10 cm.	216	Historic	Metal	Ferrous Metal		Hex Nut 1" Diam		1	Intact	
T8	T8-35	Ao	0-10 cm.	217	Historic	Glass	Insulator Glass	Clear	For Telegraph Pole	Pressed Glass	1	Fragment	
T8	T8-36	A1	10-20 cm.	213	Historic	Metal	Cuprous Metal		Electric Machine Part	1.2"	2	Intact	W/ Wire
T8	T8-38	A1	10-20 cm.	221	Historic	Metal	Ferrous Metal		Machine Part	3.25" Dia	1	Near Intact	
T8	T8-38	A1/B1	30-40 cm.	222	Historic	Metal	Ferrous Metal		Square Nut/Bolt	1.5x1.5x1"Long	1	Fragment	Threaded
T8	T8-39	A1	20-30 cm.	224	Historic	Metal	Cuprous Metal		Wire	1/8" Dia Wire	1	Intact	2 spliced wires, bent into 2" circle.
T8	T8-39	B1	40-50 cm.	223	Precontact	Stone	Quartzite	Tan	Neville Variant Point	28x11.5x5mm	1	Intact	Small-size Neville Variant.
T8	T8-39E	A1	30-40 cm.	226	Historic	Glass	Flat Glass	Lt Green Tint	Window Glass		1	Fragments	
T8	T8-39W	Fill 1	10-20 cm.	225	Historic	Glass	Flat Glass	Clear	Window Glass	Mirror?	1	Fragments	Possible silvering.
T8	T8-40	Fill 1	10-20 cm.	228	Historic	Glass	Vessel Glass	Amethyst Tint	Bottle Glass	Mold-Blown/Machine-Made	1	Body/Base	
T8	T8-40	Fill 1	10-20 cm.	229	Historic	Metal	Ferrous Metal		Wire	3/16"X3"Long	1	Intact	
T8	T8-43	A1	10-20 cm.	157	Historic	Coal-Related	Coal, Burned		Slag		1	Fragment	
T8	T8-43	A1	20-30 cm.	158	Historic	Metal	Ferrous Metal		Nail, Wire		2	Fragments	Corroded
T8	T8-45	A1/B1int	20-30 cm.	227	Precontact	Stone	Quartzite	White/Rose	Flake, Decortication	38x22x12mm	1	Debitage	Possibly utilized.
T8	T8-45W	Fill 2	10-20 cm.	160	Historic	Glass	Insulator Glass	Aqua	For Telegraph Pole	Pressed Glass	1	Fragment	Partial Thread
T8	T8-45W	A1	20-30 cm.	231	Historic	Ceramic	Earthenware	Red	Brick		9	Fragments	
T8	T8-45W	B1	30-40 cm.	230	Precontact	Stone	Quartzite	White/Rose	Flake, Secondary	20-25mm	1	Debitage	
T8	T8-45W2	AE/A1	0-10 cm.	233	Historic	Glass	Insulator Glass	Aqua	For Telegraph Pole	Pressed Glass	20	Fragments	
T8	T8-45W2	AE/A1	0-10 cm.	234	Historic	Metal	Ferrous Metal		Square Nut	1-1/16x1-1/16"	1	Intact	
T8	T8-47	AE/A1	0-10 cm.	171	Historic	Metal	Ferrous Metal		Wire	8" L, 1/8" Thick	1	Fragment	
T8	T8-47	AE/A1	0-10 cm.	172	Historic	Metal	Ferrous Metal		Braided Wire	5.5"	1	Fragment	
T8	T8-48	Ao	0-10 cm.	163	Historic	Glass	Insulator Glass	Aqua	For Telegraph Pole	Pressed Glass	1	Fragment	Half of Makers Mark, Threaded.
T8	T8-48	Fill 1	10-20 cm.	161	Historic	Ceramic	Porcelain	White	Electrical Insulator		1	Fragment	
T8	T8-48	Fill 1	10-20 cm.	162	Historic	Metal	Ferrous Metal		Large Screw	4.75inl	1	Intact	Square Head
T8	T8-48	Fill 2	40-50 cm.	235	Historic	Glass	Insulator Glass	Aqua	For Telegraph Pole	Pressed Glass	1	Fragment	
T8	T8-51	A1	20-30 cm.	167	Historic	Ceramic	Earthenware		Redware	Missing Surfaces	2	Fragments	

Eversource Sudbury-Hudson MA Project Intensive Survey 2018 Catalogue

January 28, 2019

Page 7

Area	Test Pit	Layer	Depth	Cat.#	Era	Class	Material	Color	Description	Detail	Qty	Portion	Comments
T8	T8-51	B1	30-40 cm.	164	Precontact	Stone	Quartzite	Tan	Neville Stem Frag	14x12x5mm	1	Stem Fragment	Point Stem with concave end.
T8	T8-51	B1	30-40 cm.	165	Precontact	Quartzite	Quartzite	Tan	Secondary Flake	15-20mm	1	Debitage	
T8	T8-51	B1	30-40 cm.	166	Precontact	Stone	Granite	Tan/Red	Fire-cracked Rock	20g	1	Fragment	
T8	T8-51E	Ao	0-10 cm.	236	Historic	Ceramic	Porcelain	Brown	Insulator	Glazed	1	Fragment	
T8	T8-52	A1	10-20 cm.	173	Historic	Metal	Ferrous Metal		Square Washer	2.25x2.25x3/16"	1	Intact	
T8	T8-54	Ao/A1	10-20 cm.	174	Unknown	Stone	Granite	Gray W/ Red	Fire-cracked Rock	181g	1	Fragment	Possible FCR
T8	T8-54	A1	10-20 cm.	237	Historic	Metal	Ferrous Metal		Broken Nut	Half 1-1/2" Nut	1	Fragment	
T8	T8-56	Fill 1	0-10 cm.	170	Historic	Metal	Ferrous Metal		Railroad Spike		1	Intact	
T8	T8-60	A1	20-30 cm.	152	Precontact	Stone	Rhyolite	White/Tan	Flake, Secondary	30-35mm	1	Debitage	IBP
T8	T8-60	B1	40-50 cm.	153	Precontact	Stone	Granite	Tan	Cobble	90x74x31mm	1	Intact	Possibly utilized
T8	T8-60E	A1/B1	27 cm.	155	Precontact	Stone	Quartz, Crystal	Clear	Preform	28x19x12mm	1	Fragment	Broken during manufacture.
T8	T8-60E	A1/B1	27 cm.	156	Precontact	Stone	Granite	Tan	Fire-cracked Rock	94g	1	Fragment	Small Cobble
T8	T8-60N	Fill 1	40-50 cm.	238	Historic	Ceramic	Earthenware	Red	Brick	1/2 Brick	1	Fragment	
T8	T8-60N	B1	70-80 cm.	154	Precontact	Stone	Granite	Tan/Red	Fire-cracked Rock	Total Wt:438g	3	Fragments	Pieces mend.
T8	T8-65	A1	30-40 cm.	168	Historic	Ceramic	Earthenware	Brown	Redware	Lead Glazed	1	Fragment	
T8	T8-65	A1	40-50 cm.	169	Historic	Ceramic	Earthenware	Brown	Redware	Lead Glazed	1	Fragment	
T8	T8-66	A1	20-30 cm.	239	Historic	Glass	Flat Glass	Clear	Window Glass		1	Fragment	
T9	T9-3	A1	20-30 cm.	94	Historic	Ceramic	Earthenware	Brown Glaze	Redware	Lead-glazed	2	Fragments	
T9	T9-4	A1	10-20 cm.	85	Unknown	Bone/Teeth	Bone	White	Calcined Bone	<1g	1	Fragment	
T9	T9-4	A1	20-30 cm.	97	Unknown	Bone/Teeth	Bone	White	Calcined Bone		1	Fragment	
T9	T9-4	A1	20-30 cm.	98	Historic	Ceramic	Earthenware		Whiteware	Plain	1	Fragment	
T9	T9-4	A1	20-30 cm.	99	Natural	Stone	Schist	Gray	Spall	10-15mm	1	Fragment	Not Cultural
T9	T9-5	A1	10-20 cm.	103	Historic	Glass	Vessel Glass	Green	Bottle Glass	Machine-Made	1	Base	Owen's Scar
T9	T9-5	A1	30-40 cm.	104	Historic	Glass	Vessel Glass	Green	Bottle Glass	Machine-Made	1	Body Fragment	
T9	T9-5	A1/B1	40-50 cm.	95	Historic	Metal	Ferrous Metal		Railroad Spike		1	Near Intact	Without Head
T9	T9-5	A1/B1	40-50 cm.	96	Unknown	Stone	Granite	Slightly Red	Fire-Affected Rock	27mm	1	Fragment	
T9	T9-6	A1	10-20 cm.	100	Historic	Metal	Ferrous Metal		Sheet Metal Hinge	1 Piece W/ 2 Grommets	6	Fragments	
T9	T9-8	Fill 1	30-40	106	Historic	Metal	Ferrous Metal		Railroad Spike		1	Near Intact	Missing Head
T9	T9-8	Fill 1	30-40	107	Historic	Metal	Ferrous Metal		Wire	2.5"	1	Fragments	Corroded
T9	T9-8	Fill 1	30-40	108	Historic	Wood	Charred Wood	Black			1	Fragment	
T10	T10-1	Ao	0-10 cm.	240	Historic	Metal	Ferrous Metal		Rail Road Spikes	Missing Heads	3	Fragments	
T10	T10-1	B2	50-60 cm.	241	Historic	Bone/Teeth	Bone		Mammal	1g Unburned	1	Fragment	In A Burrough
T10	T10-3	A1	20-30 cm.	242	Historic	Glass	Vessel Glass	Amethyst Tint	Bottle Glass	Mold-Blown	5	Body/Base	Line embossed
T10	T10-4	A1	10-20 cm.	243	Historic	Glass	Flat Glass	Lt Green Tint	Window Glass		1	Fragment	
T10	T10-6	Fill 1	0-10 cm.	244	Historic	Glass	Vessel Glass	Lt Gray	Bottle Glass	Mold-Blown/Machine-Made	1	Body/Base	Embossed lettering; burned
T10	T10-9	A1	20-30 cm.	246	Historic	Coal-Related	Coal Products	Brown	Burned Coal	Slag	1	Intact	
T10	T10-9	A1	30-40 cm.	247	Historic	Ceramic	Earthenware		Redware	Missing Surface	1	Fragment	

Eversource Sudbury-Hudson MA Project Intensive Survey 2018 Catalogue

January 28, 2019

Page 8

Area	Test Pit	Layer	Depth	Cat.#	Era	Class	Material	Color	Description	Detail	Qty	Portion	Comments
T11	T11-02	A1	20-30 cm.	248	Historic	Glass	Insulator Glass	Aqua	For Telegraph Pole	Pressed Glass	4	Fragments	Embossed 1883, 1884
T11	T11-05	B1	30-40 cm.	249	Precontact	Stone	Rhyolite	Gray	Flake, Secondary	25-30mm	1	Debitage	IWP, IBP
T11	T11-05E	A1/B1	30-40 cm.	254	Precontact	Stone	Quartz	Clear/White	Flake, Secondary	10-15mm	1	Debitage	
T11	T11-05E	A1/B1	30-40 cm.	255	Precontact	Stone	Quartz	Clear/White	Flake, Secondary	15-20mm	1	Debitage	
T11	T11-05E	A1/B1	30-40 cm.	256	Precontact	Stone	Rhyolite	Blue-Gray	Flake, Secondary	10-15mm	1	Debitage	
T11	T11-05E	A1/B1	30-40 cm.	257	Precontact	Stone	Rhyolite	Gray W/ Red	Shatter, Secondary	10-15mm	1	Debitage	
T11	T11-05E	A1/B1	30-40 cm.	258	Precontact	Stone	Granite	Tan/Gray/Red	Flake, Secondary	15-20mm	1	Debitage	Feldspar and quartz minerals
T11	T11-05E	A1/B1	30-40 cm.	259	Precontact	Stone	Granite Gneiss	Tan/Gray/Red	Fire-Cracked Rock	74x27x25mm	1	Fragment	From Cobble, Poss.Utilized
T11	T11-05E	A1/B1	30-40 cm.	260	Precontact	Stone	Schist	Tan/Gray/Red	Shatter, Decortication	38x29x3mm	1	Debitage	Fired or FAR
T11	T11-05W	A1	10-20 cm.	250	Precontact	Stone	Rhyolite	Blue-Gray	Flake, Secondary	10-15mm	1	Debitage	IWP, IBP
T11	T11-05W	A1	10-20 cm.	251	Precontact	Stone	Rhyolite	Blue-Gray	Flake, Secondary	15-20mm	1	Debitage	IWP, IBP
T11	T11-05W	A1	10-20 cm.	252	Precontact	Stone	Rhyolite	Blue-Gray	Flake, Secondary	20-25mm	2	Debitage	
T11	T11-05W	A1	10-20 cm.	253	Unknown	Charred Wood	Charcoal		Sample	1g	1	Sample	
T11	T11-06	Fill 1	0-10 cm.	261	Historic	Glass	Insulator Glass	Aqua	For Telegraph Pole	Pressed Glass	1	Fragment	
T11	T11-10	Fill 1	0-10 cm.	262	Historic	Glass	Insulator Glass	Aqua	For Telegraph Pole	Pressed Glass	1	Base Fragment	Embossed "...ALL TATUM Co. V WT
T11	T11-10	Fill 1	0-10 cm.	263	Historic	Glass	Insulator Glass	Aqua	For Telegraph Pole	Pressed Glass	1	Rim Fragment	
T11	T11-10	A1/B1	20-30 cm.	264	Precontact	Stone	Quartz	Tan/White/Red	Shatter, Decortication	25-30mm	1	Debitage	Fired
T11	T11-17	Ao	0-10 cm.	265	Historic	Ceramic	Earthenware	Red	Brick		1	Fragment	
T11	T11-18	Ao	0-10 cm.	266	Historic	Metal	Ferrous Metal		Nail, Wire	3" Long	1	Near Intact	
T11	T11-18	Fill 2	20-30 cm.	267	Historic	Glass	Vessel Glass	Clear	Bottle Glass	Machine-Made	1	Body Fragment	
T11	T11-18	Fill 2	40-50 cm.	268	Historic	Glass	Vessel Glass	Clear	Bottle Glass	Machine-Made	1	Body Fragment	
T11	T11-18	Fill 2	40-50 cm.	269	Historic	Metal	Ferrous Metal		Wire	Small Gauge 1/32"	4	Fragments	
T11	T11-18	Fill 2	40-50 cm.	270	Historic	Metal	Aluminum		Aluminum Foil	Machine-Made	2	Fragments	
T11	T11-18	Fill 2	40-50 cm.	271	Historic	Metal	Ferrous Metal		U-clip	Pole Attachment	1	Near Intact	
T11	T11-18	Fill 2	40-50 cm.	272	Historic	Wood	Wood	Brown	Pole Fragment		2	Fragments	
T11	T11-18	Fill 2	40-50 cm.	273	Historic	Composite	Asphalt	Black			2	Fragments	1 Piece W/Pebbles
T11	T11-21	Fill 2	20-30 cm.	275	Historic	Glass	Vessel Glass	Clear	Bottle Glass	Machine-Made	1	Neck Fragment	Screw top
T11	T11-21	Fill 1	20-30 cm.	276	Historic	Glass	Vessel Glass	Clear	Bottle Glass	Machine-Made	1	Body Fragment	
T11	T11-21	Fill 2	20-30 cm.	277	Historic	Glass	Vessel Glass	Amber	Bottle Glass	Machine-Made	4	Body Fragments	Stippled, embossed "REFILL""RETURN".
T11	T11-21	Fill 2	20-30 cm.	278	Historic	Glass	Vessel Glass	Amber	Bottle Glass	Machine-Made	8	Body Fragments	
T11	T11-21	Fill 2	20-30 cm.	279	Historic	Glass	Vessel Glass	Amber	Bottle Glass	Machine-Made	1	Bottle Neck	
T11	T11-22	Buried A	50-60 cm.	280	Historic	Glass	Vessel Glass	Amber	Bottle Glass	Machine-Made	1	Body Fragment	Stip W/Hold Line
T11	T11-22	Fill 2	50-60 cm.	281	Historic	Synthetic	Plastic	Clear		Thin	1	Fragment	
T11	JTP-12	A1	0-10 cm.	274	Historic	Ceramic	Earthenware	Green Dec.	Whiteware	W/Green Decal	1	Body Fragment	
T12	T12-01	Ao	0-10 cm.	282	Historic	Metal	Ferrous Metal		Indeterminate	10.5x4.5x1"	1	Near Intact	Box Like Mechanism
T12	T12-01	Fill 1	10-20 cm.	283	Historic	Glass	Vessel Glass	Clear	Bottle Glass	Machine-Made	1	Neck Fragment	Screw top
T12	T12-01	Fill 1	10-20 cm.	284	Historic	Glass	Vessel Glass	Amber	Bottle Glass	Machine-Made	1	Neck Fragment	Screw top

CWP = Conspicuous White Phenocrysts; I = Inconspicuous; B = Black, G = Glassy; FCR = fire-cracked rock

Eversource Sudbury-Hudson MA Project Intensive Survey 2018 Catalogue

January 28, 2019

Page 9

Area	Test Pit	Layer	Depth	Cat.#	Era	Class	Material	Color	Description	Detail	Qty	Portion	Comments
T12	T12-01	Fill 1	10-20 cm.	285	Historic	Glass	Vessel Glass	Amber	Bottle Glass	Machine-Made	1	Fragment	
T12	T12-01	Fill 1	10-20 cm.	286	Historic	Glass	Vessel Glass	Clear	Table Glass	Machine-Made	1	Fragment	
T12	T12-01	Fill 1	10-20 cm.	287	Historic	Glass	Vessel Glass	Lt Aqua Tint	Bottle Glass	Machine-Made	1	Body Fragment	
T12	T12-01	Fill 1	10-20 cm.	288	Historic	Glass	Vessel Glass	Clear	Bottle Glass	Machine-Made	2	Body Fragments	Embossed wline
T12	T12-01	Fill 1	10-20 cm.	289	Historic	Glass	Vessel Glass	Clear	Bottle Glass	Machine-Made	9	Body Fragments	
T12	T12-01	Fill 1	10-20 cm.	290	Historic	Glass	Flat Glass	Lt Green Tint	Window Glass		1	Fragment	
T12	T12-01	A1	30-40 cm.	291	Historic	Glass	Vessel Glass	Clear	Bottle Glass	Machine-Made	1	Body Fragment	
T12	T12-01	A1	30-40 cm.	292	Historic	Glass	Flat Glass	Lt Green Tint	Window Glass		1	Fragment	
T12	T12-01	A1	30-40 cm.	293	Historic	Ceramic	Earthenware	Blue Transfer	Whiteware	Transfer-Printed	1	Body Fragment	
T12	T12-02	Fill 1	0-10 cm.	294	Historic	Glass	Vessel Glass	Clear	Bottle Glass	Machine-Made	1	Base Fragment	Embossed Lines
T12	T12-02	Fill 1	0-10 cm.	295	Historic	Glass	Flat Glass	Lt Green Tint	Window Glass		1	Fragment	
T12	T12-02	Fill 1	10-20 cm.	296	Historic	Glass	Vessel Glass	Amber	Bottle Glass	Machine-Made	1	Body Fragment	
T12	T12-02	Fill 1	10-20 cm.	297	Historic	Glass	Vessel Glass	Aqua	Bottle Glass	Machine-Made	1	Body Fragment	Burned.
T12	T12-02	Fill 1	10-20 cm.	298	Historic	Glass	Flat Glass	Lt Green Tint	Window Glass		1	Fragment	Burned.
T12	T12-02	Fill 1	10-20 cm.	299	Historic	Glass	Flat Glass	Lt Green Tint	Window Glass		1	Fragment	
T12	T12-02	Fill 1	10-20 cm.	300	Historic	Glass	Flat Glass	Clear	Window Glass		1	Fragment	
T12	T12-02	A1	20-30 cm.	301	Historic	Metal	Aluminum		Strap/Clip	2"X1"X1/16"	1	Fragment	
T12	T12-04	A0/F1	0-10 cm.	302	Historic	Glass	Vessel Glass	Clear/Yellow	Table Glass	Possible Bowl	1	Lip	Looks Fired
T12	T12-06	A0/A1	10-20 cm.	303	Historic	Glass	Vessel Glass	Lt Green Tint	Bottle Glass	Mold-Blown	1	Body Fragment	
T12	T12-06	A0/A1	10-20 cm.	304	Historic	Glass	Vessel Glass	Amber	Bottle Glass	Machine-Made	1	Fragments	
T12	T12-06	A1	30-40 cm.	305	Historic	Glass	Vessel Glass	Lt Green Tint	Bottle Glass	Mold-Blown/Machine-Made	1	Base Fragment	Embossed "NTE"
T12	T12-07	A0/F1	0-10 cm.	306	Historic	Glass	Vessel Glass	Clear	Bottle Glass	Machine-Made	1	Fragment	<1.5cm Diam
T12	T12-07	Ao/F1	0-10 cm.	307	Historic	Coal-Related	Burned	Brown	Slag		3	Fragments	1 Teardrop Piece
T12	T12-07	A0/F1	0-10 cm.	308	Historic	Composite	Ferrous/Rubber		Iron Pipe	W/Rubber Stop	1	Intact	5/8"D. Pipe x 1 1/8" Long
T12	T12-07	Fill 1	10-20 cm.	309	Historic	Glass	Vessel Glass	Clear	Bottle Glass	Machine-Made	1	Body Fragment	
T12	T12-07	A1	30-40 cm.	310	Historic	Ceramic	Earthenware	Red	Brick	1Piece W/Surface	2	Fragments	
T12	T12-07	A1	30-40 cm.	311	Historic	Glass	Vessel Glass	Clear	Lamp/Bottle		1	Fragment	
T12	T12-07	A1	30-40 cm.	312	Historic	Glass	Flat Glass	Lt Green Tint	Window Glass		1	Fragment	
T12	T12-13	A1	10-20 cm.	313	Historic	Ceramic	Earthenware		Redware	1 Surface Each	2	Body Fragments	Possibly Glazed
T12	T12-14	A1	10-20 cm.	314	Unknown	Bone/Teeth	Bone		Calcined Bone	Flat Bone	1	Fragment	
T12	T12-14	A1	10-20 cm.	315	Unknown	Bone/Teeth	Bone		Calcined Bone	Pieces Mend	2	Fragments	
T12	T12-18	Fill 2	30-40 cm.	316	Historic	Metal	Ferrous Metal		Washer	1 3/8"O.D.	1	Intact	
T12	T12-19	Fill 1	10-20 cm.	317	Historic	Glass	Vessel Glass		Bottle Glass	Burned	1	Body Fragment	
T13	JTP-13	Fill 1	0-10 cm.	318	Historic	Ceramic	Earthenware	Red	Brick	No Surfaces	1	Fragment	
T13	JTP-13	Fill 1	0-10 cm.	319	Historic	Ceramic	Earthenware	Green Transfer	Whiteware	Transfer-Printed	1	Body Fragment	Molded Floral
T13	JTP-13	Fill 1	0-10 cm.	320	Historic	Glass	Vessel Glass	Clear/Gray	Bottle Glass	Machine-Made	5	Body Fragments	
T13	JTP-13	Fill 1	0-10 cm.	321	Historic	Glass	Vessel Glass	Green	Bottle Glass	Machine-Made	1	Fragment	

Eversource Sudbury-Hudson MA Project Intensive Survey 2018 Catalogue

January 28, 2019

Page 10

Area	Test Pit	Layer	Depth	Cat.#	Era	Class	Material	Color	Description	Detail	Qty	Portion	Comments
T13	JTP-13	F1/F2	10-20 cm.	322	Historic	Ceramic	Earthenware	Red	Brick	No Surfaces	1	Fragment	
T13	JTP-13	F1/F2	10-20 cm.	323	Historic	Glass	Vessel Glass	Clear	Bottle Glass	Machine-Made	2	Body Fragments	
T13	JTP-13	F1/F2	10-20 cm.	324	Historic	Glass	Vessel Glass	Aqua Tint	Bottle Glass	Mold-Blown/Machine-Made	1	Body Fragment	Natural Abrasion
T13	JTP-13	Ab	80-90 cm.	325	Historic	Glass	Vessel Glass	Clear	Bottle Glass	Machine-Made	1	Body Fragment	
T13	JTP-14	A0/F1	0-10 cm.	326	Historic	Glass	Vessel Glass	Clear	Possible Bowl	Machine-Made	1	Rim Fragment	
T13	JTP-15	Ao	0-10 cm.	327	Historic	Glass	Flat Glass	Lt Green Tint	Window Glass		2	Fragments	
T13	JTP-15	Fill 1	30-40 cm.	328	Historic	Glass	Vessel Glass	Aqua Tint	Bottle Glass	Mold-Blown	1	Base Fragment	Heavily Worn-Natural Abrasion
T13	JTP-15	Fill 1	30-40 cm.	329	Historic	Glass	Flat Glass	Lt Green Tint	Window Glass		2	Fragments	
T13	JTP-15	Fill 1	40-50 cm.	330	Historic	Glass	Vessel Glass	Blue	Bottle Glass	Mold-Blown/Machine-Made	1	Body Fragment	
T13	JTP-15	Fill 1	40-50 cm.	331	Historic	Glass	Vessel Glass	Clear Frosted	Bottle/Table	Mold-Blown/Machine-Made	1	Body Fragment	
T13	JTP-15	Fill 1	40-50 cm.	332	Historic	Glass	Vessel Glass	Clear	Bottle Glass	Machine-Made	1	Body Fragment	
T13	JTP-15	Fill 1	40-50 cm.	333	Historic	Glass	Flat Glass	Lt Green Tint	Window Glass		4	Fragments	
T13	JTP-15	Fill 1	40-50 cm.	334	Historic	Metal	Ferrous Metal		Nail, Cut	2 1/4" Long	1	Intact	
T13	JTP-15	Fill 1	40-50 cm.	335	Historic	Metal	Ferrous Metal		Wrought/Masonry Nail	4 1/2" Long	1	Near Intact	Rose Head, Corroded
T13	JTP-15	Fill 1	40-50 cm.	336	Historic	Coal-Related	Coal Products		Clinker		1	Fragment	
T13	JTP-15	F1/B1	50-60 cm.	337	Historic	Glass	Flat Glass	Lt Green Tint	Window Glass		2	Fragments	1/16" & 3/32" Thick
T13	JTP-16	Fill 1	10-20 cm.	338	Historic	Glass	Vessel Glass	Lt Green Tint	Bottle Glass	Machine-Made	1	Body Fragment	
T13	JTP-16	Fill 1	10-20 cm.	339	Historic	Glass	Flat Glass	Lt Green Tint	Window Glass		1	Fragment	
T13	JTP-16	Fill 1	10-20 cm.	340	Historic	Glass	Flat Glass	Lt Green Tint	Plate Glass	3/16" Thick	2	Fragments	Pieces Mend
T13	JTP-16	Fill 1	10-20 cm.	341	Historic	Metal	Ferrous Metal		Nail, Wire	4 1/4" Long	1	Intact	Encrusted
T13	JTP-16	Fill 1	10-20 cm.	342	Historic	Metal	Ferrous Metal		Nail, Wire	3" Long	1	Intact	
T13	JTP-16	Fill 1	10-20 cm.	343	Historic	Metal	Ferrous Metal		Sheet Metal	3" Long	1	Fragment	Rounded Edges
T13	JTP-16	Fill 1	10-20 cm.	344	Historic	Wood	Timber	Brown	Possible Lumber	Up To 5" Long	8	Fragments	2 Pieces W/White Paint.
T13	JTP-16	Fill 1	10-20 cm.	345	Historic	Wood	Architectural Wood	Brown/Tan	Finished Wood	W/Tan Paint	2	Fragments	Semi-Circular Shape, Station Wood
T13	JTP-16	Fill 1	10-20 cm.	346	Historic	Ceramic	Earthenware	Gray/Red	Brick	W/ Mortar	1	Fragment	
T13	JTP-16	Fill 1	10-20 cm.	347	Historic	Composite	Asphalt		Pavement	1 Surface	1	Fragment	
T13	JTP-16	Fill 1	20-30 cm.	348	Historic	Ceramic	Earthenware	Br/Bl/Red	Brick	1 Surface	1	Fragment	Burned
T13	JTP-16	Fill 1	20-30 cm.	349	Historic	Metal	Ferrous Metal		Nail, Wire	4" Long	2	Near Intact	Corroded
T13	JTP-16	Fill 1	20-30 cm.	350	Historic	Wood	Timber	Brown	Possible Lumber	3 1/2" Long	1	Fragment	
T13	JTP-16	Fill 1	30-40 cm.	351	Historic	Metal	Ferrous Metal		Nail, Wire	3" Long	1	Intact	Wood Attached To Tip
T13	JTP-16	Fill 1	30-40 cm.	352	Historic	Metal	Ferrous Metal		Nail, Wire	4" Long	1	Intact	Finish Nail, Encrusted
T13	JTP-16	Fill 1	30-40 cm.	353	Historic	Metal	Cuprous Metal		Lincoln Cent	Wheat Back	1	Intact	1909-1958; indeterminate date.
T13	JTP-16	Fill 1	30-40 cm.	354	Historic	Wood	Timber	Brown	Probably Lumber	Up To 2 1/4" Long	3	Fragments	W/White Paint
T13	JTP-16	Fill 2	40-50 cm.	355	Historic	Glass	Vessel Glass	Aqua Tint	Bottle/Table	Mold-Blown	1	Body Fragment	W/Curved Lip or Base
T13	JTP-16	Fill 2	40-50 cm.	356	Historic	Glass	Vessel Glass	Blue	Bottle Glass	Mold-Blown/Machine-Made	1	Body Fragment	
T13	JTP-16	Fill 2	40-50 cm.	357	Historic	Glass	Flat Glass	Lt Green Tint	Window Glass		1	Fragment	
T13	JTP-17	Ao	0-10 cm.	358	Historic	Ceramic	Earthenware	Red/Black	Brick		3	Fragments	2 Pieces Show Black Surface

Eversource Sudbury-Hudson MA Project Intensive Survey 2018 Catalogue

January 28, 2019

Page 11

Area	Test Pit	Layer	Depth	Cat.#	Era	Class	Material	Color	Description	Detail	Qty	Portion	Comments
T13	JTP-17	Ao	0-10 cm.	359	Historic	Ceramic	Earthenware		Redware	Unglazed	1	Body Fragment	Int. & Ext. Surface W/Mold Lines
T13	JTP-17	Ao	0-10 cm.	360	Historic	Ceramic	Porcelain	Blue Dec.	Tableware	Possible Bowl	1	Rim Fragment	
T13	JTP-17	Ao	0-10 cm.	361	Historic	Glass	Vessel Glass	Clear	Bottle Glass	Machine-Made	1	Body Fragment	
T13	JTP-17	Ao	0-10 cm.	362	Historic	Glass	Vessel Glass	Aqua Tint	Bottle Glass	Mold-Blown	1	Base Fragment	45 Degree Angle Body to Base.
T13	JTP-17	Ao	0-10 cm.	363	Historic	Glass	Flat Glass	Lt Aqua Tint	Window Glass	Crazed	2	Fragments	
T13	JTP-17	Ao	0-10 cm.	364	Historic	Glass	Flat Glass	Aqua Tint	Window Glass		3	Fragments	
T13	JTP-17	Ao	0-10 cm.	365	Historic	Glass	Flat Glass	Lt Green Tint	Window Glass		3	Fragments	
T13	JTP-17	Ao	0-10 cm.	366	Historic	Metal	Ferrous Metal		Nail, Cut/Wrought	2 1/2" Long	1	Intact	Corroded
T13	JTP-17	Ao	0-10 cm.	367	Historic	Metal	Ferrous Metal		Nail, Cut	Head/Broken Shank	1	Fragment	
T13	JTP-17	Ao	0-10 cm.	368	Historic	Metal	Ferrous Metal		Cut Brads	Up To 1" Long	3	Intact	
T13	JTP-17	Ao	0-10 cm.	369	Historic	Metal	Ferrous Metal		Nail, Wire	3" Long	1	Intact	
T13	JTP-17	Ao	0-10 cm.	370	Historic	Metal	Ferrous Metal		Nail, Wire	Missing Head	1	Shank	
T13	JTP-17	Ao	0-10 cm.	371	Historic	Metal	Ferrous Metal		Sheet Metal	1"X1/2"X1/16"	1	Fragment	
T13	JTP-17	Fill 1	10-20 cm.	436	Historic	Ceramic	Earthenware	Red	Brick		2	Fragments	
T13	JTP-17	Fill 1	10-20 cm.	437	Historic	Ceramic	Earthenware		Redware	Unglazed	1	Body Fragment	
T13	JTP-17	Fill 1	10-20 cm.	438	Historic	Glass	Flat Glass	Lt Green Tint	Window Glass		13	Fragments	
T13	JTP-17	Fill 1	10-20 cm.	439	Historic	Glass	Vessel Glass	Clear	Bottle/Table Glass	Indeterminate	2	Fragments	
T13	JTP-17	Fill 1	10-20 cm.	440	Historic	Glass	Vessel Glass	Clear/Frosted	Lamp Glass	Chimney	1	Fragment	
T13	JTP-17	Fill 1	10-20 cm.	441	Historic	Metal	Ferrous Metal		Crown Cap		1	Intact	
T13	JTP-17	Fill 1	10-20 cm.	442	Historic	Metal	Ferrous Metal		Nail, Wire		2	Fragments	
T13	JTP-17	Fill 1	10-20 cm.	443	Historic	Metal	Ferrous Metal		Nail, Indeterminate		2	Fragments	
T13	JTP-17	Fill 1	10-20 cm.	444	Historic	Metal	Ferrous Metal		Wood Screw		1	Near Intact	
T13	JTP-17	Fill 1	10-20 cm.	445	Historic	Metal	Ferrous Metal		Sheet/Can		1	Fragment	
T13	JTP-17	Fill 1	30-40 cm.	446	Historic	Metal	Ferrous Metal		Hex Nut	1 5/16" Dia.	1	Intact	
T13	JTP-17	Fill 1	30-40 cm.	447	Historic	Metal	Ferrous Metal		Bracket	7.5x1.5x1/4"	1	Intact	
T13	JTP-17	Fill 1	40-50 cm.	452	Historic	Ceramic	Earthenware	Red	Brick		1	Fragment	
T13	JTP-17	Fill 1	40-50 cm.	453	Historic	Ceramic	Earthenware	Brown Glaze	Redware	Lead-glazed	1	Body Fragment	Glazed both sides
T13	JTP-17	Fill 1	40-50 cm.	454	Historic	Glass	Vessel Glass	Clear	Ink Bottle	Machine-Made	1	Bottle Neck	
T13	JTP-17	Fill 1	40-50 cm.	455	Historic	Glass	Flat Glass	Lt Green Tint	Window Glass		50	Fragments	
T13	JTP-17	Fill 1	40-50 cm.	456	Historic	Glass	Flat Glass	Lt Green Tint	Window Glass		1	Fragment	
T13	JTP-17	Fill 1	40-50 cm.	457	Historic	Glass	Vessel Glass	Sapphire Blue	Lamp Glass	Mold-Blown	12	Fragments	1 Embossed "R" Lantern?
T13	JTP-17	Fill 1	40-50 cm.	458	Historic	Glass	Vessel Glass	Clear	Lamp Glass	Thin	2	Fragments	
T13	JTP-17	Fill 1	40-50 cm.	459	Historic	Glass	Vessel Glass	Lt Amethyst Tint	Bottle Glass	Mold-Blown/Machine-Made	2	Fragments	
T13	JTP-17	Fill 1	40-50 cm.	460	Historic	Glass	Vessel Glass	Clear	Bottle Glass		3	Fragments	
T13	JTP-17	Fill 1	40-50 cm.	461	Historic	Glass	Vessel Glass	Aqua	Bottle Glass		2	Fragments	
T13	JTP-17	Fill 1	40-50 cm.	462	Historic	Glass	Vessel Glass	Lt Amethyst Tint	Bottle Glass	Mold-Blown/Machine-Made	1	Fragment	Panel Embossed "B"
T13	JTP-17	Fill 1	40-50 cm.	463	Historic	Glass	Vessel Glass	Clear	Melted Glass	Thick	1	Fragment	

Eversource Sudbury-Hudson MA Project Intensive Survey 2018 Catalogue

January 28, 2019

Page 12

Area	Test Pit	Layer	Depth	Cat.#	Era	Class	Material	Color	Description	Detail	Qty	Portion	Comments
T13	JTP-17	Fill 1	40-50 cm.	464	Historic	Glass	Medical	Clear	Syringe Plunger Rod		1	Fragment	
T13	JTP-17	Fill 1	40-50 cm.	465	Historic	Metal	Cuprous Metal		.22 Caliber	Bullet Casing	1	Intact	"US" On Base
T13	JTP-17	Fill 1	40-50 cm.	466	Historic	Metal	Ferrous Metal		Nail, Wire		6	Fragments	1 1/4" to 2 3/4"
T13	JTP-17	Fill 1	40-50 cm.	467	Historic	Metal	Ferrous Metal		Nail, Wire	Roofing	1	Intact	
T13	JTP-17	Fill 1	40-50 cm.	468	Historic	Metal	Ferrous Metal		Nail, Wire		11	Fragments	
T13	JTP-17	Fill 1	40-50 cm.	469	Historic	Metal	Ferrous Metal		Spike, Wire		2	Fragments	
T13	JTP-17	Fill 1	40-50 cm.	470	Historic	Metal	Ferrous Metal		Iron Buckel For Strap	1.1"X1"X1/8"	1	Intact	"D" Shaped w/Tongue
T13	JTP-17	Fill 1	40-50 cm.	471	Historic	Metal	Ferrous Metal		Iron Disks	1 1/16" Dia.	4	Intact	Dome-Shaped
T13	JTP-17	Fill 1	40-50 cm.	472	Historic	Metal	Ferrous Metal		Iron Disks	1 1/16" Dia.	3	Fragments	
T13	JTP-17	Fill 1	40-50 cm.	473	Historic	Metal	Ferrous Metal		Stacked Iron Disks	1 1/16" Dia.	7	Intact	Stacks of 2 (2); 4 (2); 5; 7; & 8.
T13	JTP-17	Fill 1	40-50 cm.	474	Historic	Coal-Related	Coal Products		Burned	Coal Cinder	1	Fragment	
T13	JTP-17	Fill 1	40-50 cm.	475	Historic	Synthetic	Rubber	Black	Galoshes	Footwear	6	Fragments	Rubberized w/ Mesh Fabric
T13	T13-01	A0/A1	0-10 cm.	395	Historic	Metal	Ferrous Metal		Nut	1-3/16"	1	Fragment	
T13	T13-01	A1	10-20 cm.	396	Historic	Ceramic	Earthenware	Red	Brick		2	Fragments	
T13	T13-01	A1	10-20 cm.	397	Historic	Ceramic	Earthenware		Redware	Missing Surface	4	Fragments	
T13	T13-01	A1	10-20 cm.	398	Historic	Glass	Flat Glass	Lt Green Tint	Window Glass		1	Fragment	
T13	T13-01	A1	10-20 cm.	399	Historic	Ceramic	Stoneware	White	White Salt-Glaze	Slip-Dip	1	Body Fragment	Hollow Form
T13	T13-02	A1	10-20 cm.	400	Historic	Ceramic	Earthenware	Red	Brick		8	Fragments	
T13	T13-02	A1	10-20 cm.	401	Historic	Stone	Granite	Gray	Spall	6cm	1	Fragment	Spall/Chinking Stone
T13	T13-02	A1	20-30 cm.	402	Historic	Ceramic	Earthenware	Red	Brick		1	Fragment	
T13	T13-04	A0/A1	0-10 cm.	403	Historic	Ceramic	Earthenware		Redware	Missing Surfaces	3	Fragments	
T13	T13-04	A0/A1	0-10 cm.	404	Historic	Ceramic	Earthenware		Redware	Unglazed	1	Fragment	
T13	T13-05	Ao	0-10 cm.	405	Historic	Glass	Vessel Glass	Clear	Bottle Glass	Machine-Made	2	Body Fragments	
T13	T13-05	Ao	0-10 cm.	406	Historic	Metal	Ferrous Metal		Collar		1	Fragment	Fitting
T13	T13-06	A0/A1	0-10 cm.	407	Historic	Metal	Ferrous Metal		Rectangular Bracket		1	Intact	W/ 2 Wire Nails Attached
T13	T13-06	B1	30-40 cm.	408	Historic	Ceramic	Earthenware	Red	Brick		1	Fragment	
T13	T13-07	A0/A1	0-10 cm.	409	Historic	Ceramic	Earthenware	Buff	Tile	Molded	1	Fragment	"MG. CO"
T13	T13-07	A1	10-20 cm.	410	Historic	Ceramic	Earthenware		Redware	Unglazed	1	Body Fragment	Missing Interior
T13	T13-14	A1	20-30 cm.	411	Historic	Metal	Ferrous Metal		Wire	Bent "U"	1	Fragment	
T13	T13-14	A1	20-30 cm.	412	Historic	Metal	Ferrous Metal		Bolt	4 1/2x 3/4"	1	Fragment	May go with Cat. #413
T13	T13-14	A1	20-30 cm.	413	Historic	Metal	Ferrous Metal		Bolt/Nut	1 1/2"X 1 1/2" Nut	1	Fragment	May go with Cat.#412
T13	T13-17	A1	15-25 cm	414	Historic	Glass	Vessel Glass	Lt Amethyst Tint	Bottle Glass	Mold-Blown/Machine-Made	2	Body Fragments	
T13	T13-18	A1	10-20 cm.	415	Historic	Glass	Vessel Glass	Lt Amethyst Tint	Bottle Glass	Mold-Blown/Machine-Made	2	Body Fragments	
T15	T15-06	A0/A1	0-10 cm.	416	Historic	Glass	Vessel Glass	Clear	Bottle Glass	Machine-Made	1	Bottle Neck	Threaded Same Bottle
T15	T15-06	A0/A1	0-10 cm.	417	Historic	Glass	Vessel Glass	Clear	Bottle Glass	Machine-Made	14	Body Fragments	Threaded Same Bottle
T15	T15-06	A0/A1	0-10 cm.	418	Historic	Glass	Vessel Glass	Lt Green Tint	Bottle Glass	Mold-Blown/Machine-Made	5	Body Fragments	
T15	T15-08	Fill 1	30-40 cm.	419	Historic	Glass	Vessel Glass	Aqua Tint	Bottle Glass	Mold-Blown/Machine-Made	11	Body Fragments	Strap Flask?

Eversource Sudbury-Hudson MA Project Intensive Survey 2018 Catalogue

January 28, 2019

Page 13

Area	Test Pit	Layer	Depth	Cat.#	Era	Class	Material	Color	Description	Detail	Qty	Portion	Comments
T15	T15-08	Fill 1	30-40 cm.	420	Historic	Glass	Vessel Glass	Aqua Tint	Bottle Glass	Mold-Blown/Machine-Made	1	Base Fragment	Embossed "5" Same Vessel
T15	T15-08	Fill 3	40-50 cm.	421	Historic	Glass	Vessel Glass	Aqua Tint	Bottle Glass	Mold-Blown/Machine-Made	2	Body Fragments	May be Strap Flask
T15	T15-09	B1	30-40 cm.	422	Historic	Metal	Ferrous Metal		Wire	9" Length	1	Fragment	Bent
T15	T15-10	Fill 1	0-10 cm.	423	Historic	Metal	Ferrous Metal		Rail Road Spike		1	Intact	
T15	T15-16	A0/A1	0-10 cm.	424	Historic	Metal	Ferrous Metal		Rail Road Spike		1	Intact	
T15	T15-18	A1	10-20 cm.	425	Historic	Metal	Ferrous Metal		Bolt/Nut	1 1/4"X1 1/4" Nut	1	Fragment	Nut w/ Bolt Fragment
T15	T15-21	A0/F1	0-10 cm.	426	Historic	Glass	Insulator Glass	Aqua Tint	For Telegraph Pole	Pressed Glass	1	Fragment	
T15	T15-29	Ao	0-10 cm.	427	Historic	Composite	Plastic/Metal		Shotgun Shells		3	Intact	2 Red, 1 Blue Plastic Shell
T15	T15-30	A0/F1	0-10 cm.	428	Historic	Glass	Insulator Glass	Aqua Tint	For Telegraph Pole	Pressed Glass	2	Fragments	
T15	T15-30	Fill 1	10-20 cm.	429	Historic	Glass	Insulator Glass	Aqua	For Telegraph Pole	Pressed Glass	2	Intact	"W.BROOKFIELD/45 CLIFF ST/NY"
T15	T15-30	Fill 1	10-20 cm.	430	Historic	Glass	Insulator Glass	Aqua	For Telegraph Pole	Pressed Glass	11	Fragments	
T15	T15-30	Fill 1	10-20 cm.	431	Historic	Metal	Ferrous Metal		Sheet Metal		8	Fragments	
T15	T15-33	F1/A1	20-30 cm.	432	Historic	Metal	Ferrous Metal		Large Washer	2 3/4" Diam.	1	Intact	
T16	T16-03	Ao	0-10 cm.	433	Historic	Metal	Cuprous Metal		Wire	13" Length	1	Fragment	
T16	T16-07	A0/F1	0-10 cm.	434	Historic	Glass	Vessel Glass	Clear	Bottle Glass	Mold-Blown/Machine-Made	1	Body Fragment	
T16	T16-07	A1	10-20 cm.	435	Historic	Metal	Ferrous Metal		Bolt Head/Shaft	2 1/2"	1	Fragment	
T16	T16-14	B1	30-40 cm.	516	Historic	Metal	Cuprous Metal		Wire	9 1/2L	1	Fragment	Twisted Stand for Telegraph 3
T16	T16-15	Fill 1	0-10 cm.	373	Historic	Metal	Ferrous Metal		Square Washer		1	Intact	
T16	T16-15	Surface	0cm	372	Historic	Glass	Insulator Glass	Aqua	For Telegraph Pole	Pressed Glass	1	Intact	"HEMINGRAY" "N2 16"
T17	T16-15	Fill 1	0-10 cm.	374	Historic	Metal	Ferrous Metal		Square Bolt		1	Intact	
T17	T17-3	A1	10-20 cm.	376	Unknown	Charred Wood	Charcoal		Sample	3g	1	Fragments	
T17	T17-3	A1	12 cmbs	375	Precontact	Stone	Quartz	White	Untyped Point	36x15x7mm	1	Intact	
T17	T17-3E	B1	30-40 cm.	377	Precontact	Stone	Quartz	White	Shatter, Secondary	10-15mm	1	Debitage	
T17	T17-3W	Ao	0-10 cm.	378	Historic	Metal	Ferrous Metal		Bolt & Nut	RR Bolt W/Nut	1	Fragment/Intact	
T17	T17-6	F1/F2	30-40 cm.	379	Historic	Glass	Vessel Glass	Aqua Tint	Bottle Glass		1	Fragment	
T17	T17-6	F1/F2	30-40 cm.	380	Historic	Glass	Vessel Glass	Red	Lamp Glass	Lantern	1	Fragment	Flashed Glass
T17	T17-9	Ao	0-10 cm.	381	Historic	Glass	Vessel Glass	Red	Lamp Glass	Lantern	1	Fragment	
T18	T18-03	A1	20-30 cm.	383	Historic	Glass	Insulator Glass	Aqua	For Telegraph Pole	Pressed Glass	1	Fragment	Bottom Part, Partial Thread
T18	T18-04	Ao	0-10 cm.	382	Historic	Glass	Insulator Glass	Blue Tint	For Telegraph Pole	Pressed Glass	1	Fragment	
T18	T18-06	Fill 2	40-50 cm.	384	Historic	Glass	Vessel Glass	Red	Lamp Glass	RR Lamp Glass	1	Fragment	Railroad Lantern?
T18	T18-08	Ao	0-10 cm.	476	Historic	Metal	Ferrous Metal		Hardware Lg Brace	11-3/4"X6"X1"	1	Intact	
T19	T19-03	A1	10-20 cm.	478	Historic	Glass	Vessel Glass	Lt Aqua Tint	Bottle Glass	Mold-Blown/Machine-Made	2	Body Fragments	Pieces Mend
T19	T19-04	A1	10-20 cm.	479	Historic	Composite	Resin	Black	Skeet		1	Rim Fragment	
T19	T19-14	A1	10-20 cm.	480	Historic	Metal	Ferrous Metal		Bolt	6"X4/5"	1	Intact	
T19	T19-20	Fill 1	10-20 cm.	481	Historic	Glass	Vessel Glass	Clear	Bottle Glass	Machine-Made	1	Body Fragment	
T19	T19-20	Fill 1	10-20 cm.	482	Historic	Glass	Vessel Glass	Clear	Bottle Glass	Machine-Made	1	Base Fragment	Embossed "Wine"/A-C6"
T19	T19-20	Fill 2	25-35cm	483	Historic	Metal	Ferrous Metal		Nut	1 1/2"X1 1/2"	1	Intact	W/Bolt Frag. Inside

Eversource Sudbury-Hudson MA Project Intensive Survey 2018 Catalogue

January 28, 2019

Page 14

Area	Test Pit	Layer	Depth	Cat.#	Era	Class	Material	Color	Description	Detail	Qty	Portion	Comments
T19	T19-23	Ao	0-10 cm.	477	Historic	Metal	Ferrous Metal		Hardware Fastner	8 1/2"X1/2"	1	Intact	Threaded w/Round Shaft 3/4"Nut
T19	T19-25	A0/Fill	0-10 cm.	484	Historic	Ceramic	Earthenware	Red/Gray	Brick	Burnt, 794g	1	Fragment	3-Sides Present
T19	T19-27	A1	10-20 cm.	485	Historic	Metal	Ferrous Metal		Hardware Bolt	8 3/4"X9/16"	1	Intact	For Telegraph Insulator
T19	T19-32	A0/Fill	0-10 cm.	486	Historic	Ceramic	Earthenware		Whiteware	Plain	12	Fragments	
T19	T19-32	A1	10-20 cm.	487	Historic	Ceramic	Earthenware		Whiteware	Plain	1	Rim Fragment	
T19	T19-32	A1	10-20 cm.	488	Historic	Ceramic	Earthenware		Whiteware	Plain	2	Fragments	
T19	T19-32	A1	20-30 cm.	489	Historic	Ceramic	Earthenware		Whiteware	Plain	1	Rim Fragment	
T19	T19-34	A1	20-30 cm.	490	Historic	Metal	Ferrous Metal		Bolt	4/5"	1	Fragment	
T19	T19-36	Ao	0-10 cm.	491	Historic	Glass	Insulator Glass	Lt Aqua Tint	For Telegraph Pole	Pressed Glass	2	Fragments	Pieces Mend; Threaded.
T20	T20-03	A1	10-20 cm.	494	Historic	Ceramic	Earthenware		Whiteware	Plain	2	Fragments	Tan Stripe
T20	T20-08	B1	30-40 cm.	493	Historic	Metal	Ferrous Metal		Nut W/Bolt		1	Near Intact	
T20	T20-11	A1	30-40 cm.	492	Historic	Metal	Ferrous Metal		Rail Road Spike	15cm	1	Intact	
T20	T20-13	B1	20-30 cm.	495	Historic	Synthetic	Plastic	Green	Indeterminate		4	Fragments	
T20	T20-15	A1	10-20 cm.	496	Historic	Glass	Vessel Glass	Amber	Bottle Glass	Machine-Made	1	Base Fragment	Embossed "K19".
T20	T20-15	A1	10-20 cm.	497	Historic	Glass	Vessel Glass	Amber	Bottle Glass	Machine-Made	2	Lip Fragments	
T20	T20-15	A1	10-20 cm.	498	Historic	Glass	Vessel Glass	Amber	Bottle Glass	Machine-Made	7	Fragments	
T20	T20-15	A1	10-20 cm.	499	Historic	Glass	Vessel Glass	Green	Bottle Glass	Machine-Made	1	Fragment	
T20	T20-15	A1	10-20 cm.	500	Historic	Glass	Vessel Glass	Clear	Bottle Glass	Machine-Made	1	Fragment	
T20	T20-15	A1/B1	20-30 cm.	501	Historic	Glass	Vessel Glass	Amber	Bottle Glass	Machine-Made	3	Fragments	1 Embossed "Knick"
T20	T20-15	A1/B1	20-30 cm.	502	Historic	Composite	Resin	Black	Skeet		1	Fragment	
T20	T20-15	A1/B1	20-30 cm.	503	Historic	Glass	Vessel Glass	Lt Aqua Tint	Bottle Glass	Machine-Made	2	Body Fragments	
T20	T20-15	A1/B1	20-30 cm.	504	Historic	Glass	Vessel Glass	Green Tint	Bottle Glass	Machine-Made	1	Body Fragment	
T20	T20-15	A1/B1	20-30 cm.	505	Historic	Glass	Vessel Glass	Clear	Bottle Glass	Machine-Made	2	Body Fragments	
T20	T20-15	B1	40-50 cm.	506	Historic	Glass	Vessel Glass	Amber	Bottle Glass	Machine-Made	2	Body Fragments	
T20	T20-15	B1	40-50 cm.	507	Historic	Glass	Vessel Glass	Clear	Bottle Glass	Machine-Made	3	Body Fragments	
T21	T21-01	A1	10-20 cm.	517	Historic	Composite	Resin	Orange/Black	Skeet	Painted	4	Fragments	
T21	T21-13	Ao	0-10 cm.	518	Historic	Metal	Ferrous Metal		Square Washer	2 1/4"X2 1/4"	1	Intact	
T22	T22-11	A/B	30-40 cm.	519	Historic	Metal	Ferrous Metal		Bolt	3 1/4"L X 4/5"T	1	Fragment	
T23	T23-03	A0/A1	0-10 cm.	389	Historic	Glass	Insulator Glass	Aqua Tint	For Telegraph Pole	Pressed Glass	1	Fragment	
T23	T23-03	A/B	20-30 cm.	385	Historic	Glass	Insulator Glass	Aqua Tint	For Telegraph Pole	Pressed Glass	1	Fragment	Partial Thread "End Tel"
T23	T23-04	Fill 1	10-20 cm.	520	Historic	Glass	Insulator Glass	Lt Aqua Tint	For Telegraph Pole	Pressed Glass	1	Intact	Embossed "JAN 25th, 1870/FEB 22nd, 1870/MCH 20th 1877" "4" on top; threaded.
T23	T23-04	Fill 1	20-30 cm.	521	Historic	Ceramic	Earthenware	Red	Brick		5	Fragments	
T23	T23-04	Fill1/B	30-40 cm.	522	Historic	Ceramic	Earthenware	Red	Brick		2	Fragments	
T23	T23-04	Fill1/B	30-40 cm.	523	Historic	Glass	Insulator Glass	Lt Aqua Tint	For Telegraph Pole	Pressed Glass	2	Fragments	
T23	T23-04	Fill1/B	30-40 cm.	524	Historic	Metal	Ferrous Metal		Lg. Screw	7 1/2"X2/3"	1	Intact	1" Square Head For Tel. Pole?
T23	T23-04	B1	40-50 cm.	386	Historic	Metal	Ferrous Metal		Coiled Wire	1/4" Thick	2	Fragments	

Eversource Sudbury-Hudson MA Project Intensive Survey 2018 Catalogue

January 28, 2019

Page 15

Area	Test Pit	Layer	Depth	Cat.#	Era	Class	Material	Color	Description	Detail	Qty	Portion	Comments
T23	T23-04	B1	40-50 cm.	387	Historic	Ceramic	Earthenware	Red	Brick		2	Fragments	
T23	T23-04	B1	40-50 cm.	388	Historic	Glass	Insulator Glass	Aqua	For Telegraph Pole	Pressed Glass	2	Fragments	1 Has Full Top With Thread
T23	T23-05	A1	10-20 cm.	525	Historic	Ceramic	Earthenware	Red	Brick		11	Fragments	
T23	T23-05	A1	10-20 cm.	526	Historic	Ceramic	Earthenware	Brown Glaze	Redware	Lead-glazed	1	Fragment	
T23	T23-06	A1	0-10 cm.	391	Historic	Ceramic	Earthenware	Red	Brick	Half Bricks	3	Fragments	
T23	T23-06	A1	0-10 cm.	392	Historic	Ceramic	Earthenware	Red	Brick		2	Fragments	
T23	T23-06	A1	10-20 cm.	527	Historic	Ceramic	Earthenware	Red	Brick	459g	20	Fragments	
T23	T23-06	A1	10-20 cm.	528	Historic	Ceramic	Earthenware		Creamware	Plain	2	Body Fragments	
T23	T23-06	A1	10-20 cm.	529	Historic	Ceramic	Earthenware		Creamware	Plain	1	Fragment	
T23	T23-06	A1	10-20 cm.	530	Historic	Ceramic	Earthenware	Dk Brown Glaze	Redware	Lead-glazed	1	Rim Fragment	
T23	T23-06	A1	10-20 cm.	531	Historic	Glass	Flat Glass	Aqua Tint	Window Glass		1	Fragment	
T23	T23-06	A1	10-20 cm.	532	Historic	Glass	Vessel Glass	Clear	Table Glass	Free-Blown	1	Body Fragment	
T23	T23-06	A1	10-20 cm.	533	Historic	Metal	Ferrous Metal		Nail, Wrought	T-Head	1	Intact	
T23	T23-06	A1	10-20 cm.	534	Historic	Metal	Ferrous Metal		Nail, Wrought		1	Fragment	
T23	T23-06	A1	10-20 cm.	535	Historic	Bone/Teeth	Bone		Lg. Mammal		2	Fragments	
T23	T23-07	A0/Fill	0-10 cm.	537	Historic	Synthetic	Plastic	Blue	Disk		1	Fragment	
T23	T23-07	A1	10-20 cm.	508	Historic	Ceramic	Earthenware		Creamware	Plain	7	Body Fragments	
T23	T23-07	A1	10-20 cm.	509	Historic	Ceramic	Earthenware		Pearlware	Plain	4	Body Fragments	
T23	T23-07	A1	10-20 cm.	510	Historic	Ceramic	Earthenware		Pearlware	Plain	2	Fragments	
T23	T23-07	A1	10-20 cm.	511	Historic	Ceramic	Earthenware	Blue	Pearlware	Hand Painted	1	Body Fragment	
T23	T23-07	A1	10-20 cm.	512	Historic	Ceramic	Earthenware	Brown	Redware	Glazed	1	Body Fragment	Both Sides Glazed
T23	T23-07	A1	10-20 cm.	513	Historic	Glass	Flat Glass	Clear	Window Glass		2	Body Fragments	
T23	T23-07	A1	10-20 cm.	514	Historic	Ceramic	Earthenware	Red	Brick		6	Fragments	
T23	T23-07	A1	10-20 cm.	515	Historic	Metal	Ferrous Metal		Nail, Wrought	Forged	3	Intact	
T23	T23-07	A1	10-20 cm.	536	Historic	Metal	Ferrous Metal		Nail, Wrought		7	Near Intact	
T23	T23-07	A1	10-20 cm.	538	Historic	Ceramic	Earthenware	Red	Brick	4g	10	Fragments	
T23	T23-07	A1	10-20 cm.	539	Historic	Ceramic	Earthenware		Redware	Missing Surface	3	Fragments	
T23	T23-07	A1	10-20 cm.	540	Historic	Ceramic	Earthenware		Redware	Unglazed	1	Fragment	Missing Interior
T23	T23-07	A1	10-20 cm.	541	Historic	Ceramic	Earthenware	Dk Brown Glaze	Redware	Lead-glazed	10	Body Fragments	Glazed Both Sides
T23	T23-07	A1	10-20 cm.	542	Historic	Ceramic	Earthenware		Creamware	Plain	5	Fragments	
T23	T23-07	A1	10-20 cm.	543	Historic	Ceramic	Earthenware		Pearlware	Plain	3	Fragments	
T23	T23-07	A1	10-20 cm.	544	Historic	Ceramic	Earthenware		Pearlware	Plain	1	Base Fragment	
T23	T23-07	A1	10-20 cm.	545	Historic	Ceramic	Earthenware		Creamware/Pearlware	Missing Surfaces	2	Fragments	
T23	T23-07	A1	10-20 cm.	546	Historic	Glass	Flat Glass	Smoky	Window Glass	Burned	4	Fragments	
T23	T23-07	A1	10-20 cm.	547	Historic	Glass	Vessel Glass	Clear	Table Glass	Mold-Blown	3	Body Fragments	Ribbed Tumbler
T23	T23-07	A1	10-20 cm.	548	Historic	Metal	Ferrous Metal		Nail, Wrought	Rose Head	1	Intact	
T23	T23-07	A1	10-20 cm.	549	Historic	Metal	Ferrous Metal		Nail, Wrought	L-Head	1	Intact	

Eversource Sudbury-Hudson MA Project Intensive Survey 2018 Catalogue

January 28, 2019

Page 16

Area	Test Pit	Layer	Depth	Cat.#	Era	Class	Material	Color	Description	Detail	Qty	Portion	Comments
T23	T23-07	A1	10-20 cm.	550	Historic	Metal	Ferrous Metal		Nail, Wrought		5	Fragments	
T23	T23-08	Ao	0-10 cm.	551	Historic	Ceramic	Earthenware	Red	Brick	33g	4	Fragments	
T23	T23-08	Ao	0-10 cm.	552	Historic	Ceramic	Earthenware	Black Glaze	Redware	Manganese Glaze	2	Body Fragments	
T23	T23-08	Ao	0-10 cm.	553	Historic	Ceramic	Earthenware	Brown Glaze	Redware	Lead-glazed	2	Fragments	
T23	T23-08	Ao	0-10 cm.	554	Historic	Ceramic	Earthenware		Creamware	Plain	1	Base Fragment	
T23	T23-08	Ao	0-10 cm.	555	Historic	Ceramic	Earthenware		Creamware	Plain	4	Fragments	
T23	T23-08	Ao	0-10 cm.	556	Historic	Ceramic	Earthenware		Pearlware	Plain	1	Fragment	
T23	T23-08	Ao	0-10 cm.	557	Historic	Ceramic	Earthenware		Pearlware	Plain	2	Foot	
T23	T23-08	Ao	0-10 cm.	558	Historic	Ceramic	Earthenware	Polychrome	Pearlware	Hand-Painted	2	Rim Fragments	Pieces Mend
T23	T23-08	Ao	0-10 cm.	559	Historic	Ceramic	Earthenware	Blue Dec.	Pearlware	Hand-Painted	1	Rim Fragment	
T23	T23-08	Ao	0-10 cm.	560	Historic	Ceramic	Earthenware	Blue Dec.	Pearlware	Hand-Painted	2	Body Fragments	
T23	T23-08	Ao	0-10 cm.	561	Historic	Glass	Flat Glass	Lt Aqua Tint	Window Glass		1	Fragment	
T23	T23-08	Ao	0-10 cm.	562	Historic	Glass	Insulator Glass	Lt Aqua Tint	For Telegraph Pole	Pressed Glass	1	Fragment	
T23	T23-08	Ao	0-10 cm.	563	Historic	Metal	Ferrous Metal		Nail, Wrought		2	Fragments	
T23	T23-08	Ao	0-10 cm.	564	Historic	Bone/Teeth	Bone		Lg. Mammal	Cow Phalanx	2	Intact	Proximal
T23	T23-08	Ao	0-10 cm.	565	Historic	Bone/Teeth	Bone		Lg. Mammal	Long Bone	1	Fragment	
T23	T23-08	Ao	0-10 cm.	566	Historic	Bone/Teeth	Bone		Md. Mammal	Sheep/Goat Mandible	1	Fragment	W/1 Tooth
T23	T23-08	Ao	0-10 cm.	567	Historic	Bone/Teeth	Bone		Md. Mammal	Sheep/Goat Femur	1	Fragment	Proximal End
T23	T23-08	Ao	0-10 cm.	568	Historic	Bone/Teeth	Bone		Md/Lg. Mammal		21	Fragments	
T23	T23-08	Ao	0-10 cm.	569	Historic	Bone/Teeth	Bone		Lg. Mammal	Cow Radius	1	Fragment	Proximal End
T23	T23-08	Ao	0-10 cm.	570	Historic	Bone/Teeth	Bone		Lg. Mammal	Cow Phalanx	1	Fragment	Medial; Butchered
T23	T23-08	Ao	0-10 cm.	571	Historic	Bone/Teeth	Bone		Lg. Mammal	Cow Tooth	1	Fragment	
T23	T23-08	Ao	0-10 cm.	572	Historic	Bone/Teeth	Bone		Md/Lg. Mammal	Tooth	3	Fragments	
T23	T23-08	A1	20-30 cm.	573	Historic	Ceramic	Earthenware	Red	Brick	75g	14	Fragments	
T23	T23-08	A1	20-30 cm.	574	Historic	Ceramic	Earthenware	Red	Brick/Redware	2g	3	Fragments	
T23	T23-08	A1	20-30 cm.	575	Historic	Ceramic	Earthenware		Redware	Unglazed	2	Rim Fragments	Missing Interior
T23	T23-08	A1	20-30 cm.	576	Historic	Ceramic	Earthenware	Black Glaze	Redware	Manganese Glaze	1	Rim Fragment	
T23	T23-08	A1	20-30 cm.	577	Historic	Ceramic	Earthenware	Black Glaze	Redware	Manganese Glaze	1	Body Fragment	
T23	T23-08	A1	20-30 cm.	578	Historic	Ceramic	Earthenware	Black Glaze	Redware	Manganese Glaze	1	Base Fragment	
T23	T23-08	A1	20-30 cm.	579	Historic	Ceramic	Earthenware	Brown Glaze	Redware	Lead-glazed	1	Body Fragment	
T23	T23-08	A1	20-30 cm.	580	Historic	Glass	Vessel Glass	Yellow Tint	Bottle/Table	Indeterminate	1	Body Fragment	
T23	T23-08	A1	20-30 cm.	581	Historic	Glass	Vessel Glass	Amber	Bottle Glass	Machine-Made	1	Body Fragment	Modern, Beer Bottle
T23	T23-08	A1	20-30 cm.	582	Historic	Ceramic	Earthenware		Creamware	Plain	2	Fragments	
T23	T23-08	A1	20-30 cm.	583	Historic	Ceramic	Earthenware		Pearlware	Plain	2	Fragments	
T23	T23-08	A1	20-30 cm.	584	Historic	Charred Wood	Charcoal		Partially Burned	4g	1	Fragment	
T23	T23-08	A1	20-30 cm.	585	Historic	Bone/Teeth	Bone		Lg. Mammal	Cow Phalanx	1	Fragment	Medial
T23	T23-08	A1	20-30 cm.	586	Historic	Bone/Teeth	Bone		Lg. Mammal	Long Bone Shaft	1	Fragment	

Eversource Sudbury-Hudson MA Project Intensive Survey 2018 Catalogue

January 28, 2019

Page 17

Area	Test Pit	Layer	Depth	Cat.#	Era	Class	Material	Color	Description	Detail	Qty	Portion	Comments
T23	T23-08	A1	20-30 cm.	587	Historic	Bone/Teeth	Bone		Md/Lg. Mammal	Sesmoid	1	Intact	
T23	T23-08	A1	20-30 cm.	588	Historic	Bone/Teeth	Bone		Md/Lg.		35	Fragments	
T23	T23-09	A1	10-20 cm.	589	Historic	Ceramic	Earthenware	Brown Glaze	Redware	Lead-glazed	2	Body Fragments	Pieces Mend
T23	T23-09	A1	10-20 cm.	590	Historic	Ceramic	Earthenware	Brown Glaze	Redware	Lead-glazed	1	Body Fragment	
T23	T23-09	A1	10-20 cm.	591	Historic	Ceramic	Earthenware		Redware	Missing Surface	4	Fragments	Unglazed Exterior
T23	T23-09	A1	10-20 cm.	592	Historic	Glass	Insulator Glass	Lt Aqua Tint	For Telegraph Pole	Pressed Glass	1	Small Fragment	
T23	T23-10	A0/A1	0-10 cm.	390	Historic	Ceramic	Earthenware	Red	Brick		2	Fragments	
T23	T23-10	A1	10-20 cm.	593	Historic	Ceramic	Earthenware	Brown Glaze	Redware	Lead-glazed	2	Fragments	
T23	T23-10	A1	10-20 cm.	594	Historic	Ceramic	Earthenware		Redware	Missing Surface	1	Fragment	
T23	T23-12	A1	10-20 cm.	595	Historic	Metal	Ferrous Metal		Nut	7/8"X7/8"	1	Intact	W/Bolt Fragment
T23	T23-14	Ao	0-10 cm.	596	Historic	Ceramic	Earthenware	Red	Brick	18g	1	Fragment	
T23	T23-14	Ao	0-10 cm.	597	Historic	Metal	Ferrous Metal		Iron Sheet	3 1/2"X2 3/8"X1/4"	1	Fragment	
T23	T23-16	A1	10-20 cm.	598	Historic	Glass	Insulator Glass	Aqua Tint	For Telegraph Pole	Pressed Glass	1	Rim Fragment	
T23	T23-16	A1	10-20 cm.	599	Historic	Metal	Ferrous Metal		Lg. Screw	7 1/2" W/Washer	1	Intact	Telegraph 7/8x7/8" Sq Hd
T23	T23-19	Ao	0-10 cm.	600	Historic	Metal	Ferrous Metal		Sheet Metal	3 3/8"X3"X1/4"	1	Intact	
T23	T23-21	A1	10-20 cm.	601	Historic	Glass	Vessel Glass	Amethyst Tint	Bottle Glass	Mold-Blown/Machine-Made	1	Body Fragment	Embossed
T23	T23-25	A1	10-20 cm.	602	Historic	Glass	Insulator Glass	Aqua Tint	For Telegraph Pole	Pressed Glass	1	Rim Fragment	
T23	T23-25	B/C	40-50 cm.	603	Historic	Glass	Insulator Glass	Aqua Tint	For Telegraph Pole	Pressed Glass	1	Fragment	
T23	T23-38	A1	13-20cmbs	604	Historic	Metal	Ferrous Metal		Wire	13 1/2"Lx1/4"	1	Fragment	
T23	T23-38	A1	13-20cmbs	605	Historic	Glass	Insulator Glass	Aqua	For Telegraph Pole	Pressed Glass	5	Fragments	1 Embossed "Ray"
T23	T23-40	A1	10-20 cm.	606	Historic	Ceramic	Earthenware	Brown Glaze	Redware	Lead-glazed	1	Fragment	
T23	T23-48	A1	10-20 cm.	607	Historic	Metal	Ferrous Metal		Bolt/Nut	1.5"X 1.5" Nut	1	Fragment	Nut w/Bolt Frag
T23	T23-56	Ao	0-10 cm.	608	Historic	Glass	Insulator Glass	Aqua Tint	For Telegraph Pole	Pressed Glass	1	Rim Fragment	Embossed "EL"
T23	T23-57	Fill 1	20-30 cm.	609	Historic	Metal	Ferrous Metal		Bolt	4"L 4/5"T	1	Fragment	Telegraph Line
T24	T24-07	Fill 1	20-30 cm.	610	Historic	Glass	Flat Glass	Clear	Plate Glass	Melted	1	Fragment	
T24	T24-12	A1	30-40 cm.	611	Historic	Glass	Insulator Glass	Amethyst Tint	For Telegraph Pole	Pressed Glass	1	Rim Fragment	Embossed "Made In"
T24	T24-21	Ao	0-10 cm.	612	Historic	Metal	Ferrous Metal		Rail Road Spike		1	Intact	
T24	T24-52	Fill 1	10-20 cm.	613	Historic	Metal	Ferrous Metal		Bolt	4 1/2"L, 4/5"T	1	Fragment	Telegraph Line
T24	T24-65	Ao	0-10 cm.	614	Historic	Glass	Insulator Glass	Lt Aqua Tint	For Telegraph Pole	Pressed Glass	1	Fragment	Embossed "Co."
T24	T24-66	Ao	10-20 cm.	615	Historic	Metal	Ferrous Metal		Rail Road Spike		3	Intact	
T24	T24-66	B1	40-50 cm.	616	Historic	Metal	Ferrous Metal		Wire	10"L	1	Fragment	
T24	T24-69	A0/Fill	0-10 cm.	617	Historic	Metal	Ferrous Metal		Rail Plate	8x6" 5 Holes	1	Intact	Plate To Secure Rail
T26	T26-0	A/B	30-35cmbs	618	Historic	Ceramic	Earthenware		Redware	Miss Int.	1	Fragment	Unglazed Exterior
T26	T26-1	Fill 1	20-30 cm.	619	Historic	Ceramic	Earthenware	Red	Brick	5g	3	Fragments	
T26	T26-6	A1	10-20 cm.	620	Historic	Ceramic	Earthenware	Black Glaze	Redware	Maganese Glaze	1	Body Fragment	
T26	T26-7	B1	40-50 cm.	621	Historic	Ceramic	Earthenware	Red	Brick	5g	1	Fragment	
T27	T27-01	Ao	0-10 cm.	622	Historic	Ceramic	Earthenware	Black Glaze	Redware	Manganese Glaze	1	Body Fragment	

Eversource Sudbury-Hudson MA Project Intensive Survey 2018 Catalogue

January 28, 2019

Page 18

Area	Test Pit	Layer	Depth	Cat.#	Era	Class	Material	Color	Description	Detail	Qty	Portion	Comments
T27	T27-01	Ao	0-10 cm.	623	Historic	Ceramic	Earthenware	Brown Glaze	Redware	Lead-glazed	2	Body Fragments	
T27	T27-01	Ao	0-10 cm.	624	Historic	Ceramic	Earthenware	Brown Glaze	Redware	Lead-glazed	1	Base Fragment	
T27	T27-01	Ao	0-10 cm.	625	Historic	Ceramic	Earthenware		Redware	Missing Glaze	1	Body Fragment	Unglazed Ext.
T27	T27-01	Ao	0-10 cm.	626	Historic	Ceramic	Earthenware		Whiteware	Plain	11	Fragments	9 Burned
T27	T27-01	Ao	0-10 cm.	627	Historic	Ceramic	Earthenware	Green Transfer	Whiteware	Transfer-Printed	1	Body Fragment	
T27	T27-01	Ao	0-10 cm.	628	Historic	Ceramic	Earthenware	Polychrome	Whiteware	Hand-Painted	1	Body Fragment	Chrome Colors, Floral
T27	T27-01	Ao	0-10 cm.	629	Historic	Ceramic	Earthenware		Yellowware	Plain	1	Body Fragment	
T27	T27-01	Ao	0-10 cm.	630	Historic	Ceramic	Earthenware	Brown Bands	Yellowware	Banded	1	Base Fragment	
T27	T27-01	Ao	0-10 cm.	631	Historic	Ceramic	Earthenware		Yellowware	Banded	4	Body Fragments	
T27	T27-01	Ao	0-10 cm.	632	Historic	Ceramic	Ball Clay	Off White	Pipe Stem	4/64"Bore	1	Stem Fragment	Tobacco Pipe
T27	T27-01	Ao	0-10 cm.	633	Historic	Glass	Flat Glass	Aqua Tint	Window Glass		7	Fragments	
T27	T27-01	Ao	0-10 cm.	634	Historic	Metal	Ferrous Metal		Nail, Wrought	T-Head	1	Intact	
T27	T27-01	Ao	0-10 cm.	635	Historic	Bone/Teeth	Bone		Calcined Bone	Mammal, 1g	1	Fragment	
T27	T27-01	A1	10-20 cm.	636	Historic	Ceramic	Earthenware		Redware	Unglazed	1	Body Fragment	Sugar Cone
T27	T27-01	A1	10-20 cm.	637	Historic	Ceramic	Earthenware	Brown Glaze	Redware	Lead-glazed	1	Fragment	
T27	T27-01	A1	10-20 cm.	638	Historic	Ceramic	Earthenware		Redware	Missing Surfaces	4	Fragments	
T27	T27-01	A1	10-20 cm.	639	Historic	Ceramic	Earthenware		Yellowware	Plain	9	Fragments	
T27	T27-01	A1	10-20 cm.	640	Historic	Ceramic	Earthenware		Yellowware	Plain	5	Rim Fragments	
T27	T27-01	A1	10-20 cm.	641	Historic	Ceramic	Earthenware	Brown Bands	Yellowware	Banded	15	Body Fragments	
T27	T27-01	A1	10-20 cm.	642	Historic	Ceramic	Earthenware		Pearlware	Plain	2	Body Fragments	
T27	T27-01	A1	10-20 cm.	643	Historic	Ceramic	Earthenware		Whiteware	Plain	8	Body Fragments	5 Burned
T27	T27-01	A1	10-20 cm.	644	Historic	Ceramic	Earthenware	Lt Blue Trans.	Whiteware	Transfer-Printed	1	Body Fragment	
T27	T27-01	A1	10-20 cm.	645	Historic	Ceramic	Earthenware	Blue Dec.	Whiteware	Sponged	1	Rim Fragment	
T27	T27-01	A1	10-20 cm.	646	Historic	Ceramic	Earthenware		Whiteware	Missing Surfaces	2	Fragments	
T27	T27-01	A1	10-20 cm.	647	Historic	Glass	Flat Glass	Aqua Tint	Window Glass		1	Fragment	
T27	T27-01	A1	10-20 cm.	648	Historic	Glass	Melted Glass	Aqua Tint	Burned	Globs	2	Fragments	Probably Window Glass
T27	T27-01	A1	10-20 cm.	649	Historic	Glass	Vessel Glass	Olive Green	Bottle Glass	Mold-Blown	1	Body Fragment	Dip-Mold or 3-Piece Mold
T27	T27-01	A1	10-20 cm.	650	Historic	Metal	Ferrous Metal		Nail, Cut	1.4" Brad	1	Intact	Burnt
T27	T27-01	A1	20-30 cm.	651	Historic	Ceramic	Earthenware		Pearlware	Plain	3	Body Fragments	
T27	T27-01	A1	20-30 cm.	652	Historic	Ceramic	Earthenware	Brown Bands	Yellowware	Banded	2	Body Fragments	
T27	T27-01	A1	20-30 cm.	653	Historic	Ceramic	Earthenware	Brown Glaze	Redware	Lead-glazed	2	Body Fragments	
T27	T27-01	A1	20-30 cm.	654	Historic	Ceramic	Earthenware	White	Missing Surface	Indeterminate	1	Body Fragment	
T27	T27-02	Ao/F1	0-20 cm.	665	Historic	Ceramic	Earthenware	Red	Brick		3	Fragments	
T27	T27-02	Ao/F1	0-20 cm.	666	Historic	Ceramic	Earthenware		Redware		1	Body Fragment	
T27	T27-02	Ao/F1	0-20 cm.	667	Historic	Ceramic	Earthenware	Brown Glaze	Redware	Lead-glazed	1	Body Fragment	Burnt
T27	T27-02	Ao/F1	0-20 cm.	668	Historic	Ceramic	Earthenware		Whiteware	Sm. Blue Dots	2	Body Fragments	Pieces Mend.
T27	T27-02	Ao/F1	0-20 cm.	669	Historic	Ceramic	Earthenware	Green/White	Whiteware	Hand-Painted	1	Body Fragment	

Eversource Sudbury-Hudson MA Project Intensive Survey 2018 Catalogue

January 28, 2019

Page 19

Area	Test Pit	Layer	Depth	Cat.#	Era	Class	Material	Color	Description	Detail	Qty	Portion	Comments
T27	T27-02	Ao/F1	0-20 cm.	670	Historic	Ceramic	Earthenware	Blue/Orange	Pearlware	Annular Banded	2	Body Fragments	
T27	T27-02	Ao/F1	0-20 cm.	671	Historic	Glass	Vessel Glass	Lt Aqua Tint	Bottle Glass	Mold-Blown	3	Body Fragments	
T27	T27-02	Ao/F1	0-20 cm.	672	Historic	Glass	Vessel Glass	Lt Green Tint	Bottle Glass	Mold-Blown	5	Body Fragments	Melted
T27	T27-02	Ao/F1	0-20 cm.	673	Historic	Glass	Flat Glass	Lt Green Tint	Window Glass		9	Fragments	
T27	T27-02	Ao/F1	0-20 cm.	674	Historic	Glass	Flat Glass	Clear	Window Glass		1	Fragment	
T27	T27-02	Ao/F1	0-20 cm.	675	Historic	Glass	Vessel Glass	Clear	Bottle Glass	Mold-Blown	1	Fragment	
T27	T27-02	Ao/F1	0-20 cm.	676	Historic	Metal	Ferrous Metal		Nail, Cut		3	Near Intact	3.5,7,6cm
T27	T27-02	Ao/F1	0-20 cm.	677	Historic	Metal	Ferrous Metal		Nail, Wrought		2	Near Intact	3 cm long.
T27	T27-02	Ao/F1	0-20 cm.	678	Historic	Metal	Ferrous Metal		Buckle/Strap	Serrated Edge	1	Near Intact	4x2 cm.
T27	T27-02	Ao/F1	0-20 cm.	679	Historic	Metal	Ferrous Metal		Bracket Fastener	W/Fl.Head Screw	1	Near Intact	5x2x.5cm
T27	T27-02	B1	20-30 cm.	655	Historic	Glass	Flat Glass	Lt Green Tint	Window Glass		5	Fragments	
T27	T27-02	B1	20-30 cm.	656	Historic	Glass	Vessel Glass	Lt Aqua Tint	Bottle Glass	Mold-Blown	2	Fragments	
T27	T27-02	B1	20-30 cm.	657	Historic	Glass	Vessel Glass	Lt Green Tint	Bottle Glass	Mold-Blown	1	Fragment	
T27	T27-02	B1	20-30 cm.	658	Historic	Glass	Melted Glass	Lt Green Tint	Melted		1	Fragment	
T27	T27-02	B1	20-30 cm.	659	Historic	Glass	Vessel Glass	Clear	Bottle Glass	Mold-Blown	1	Fragment	
T27	T27-02	B1	20-30 cm.	660	Historic	Metal	Ferrous Metal		Nail, Wrought		1	Fragment	
T27	T27-02	B1	20-30 cm.	661	Historic	Metal	Ferrous Metal		Nail, Cut		2	Fragments	
T27	T27-02	B1	20-30 cm.	662	Historic	Ceramic	Earthenware	Red	Brick		5	Fragments	
T27	T27-02	B1	20-30 cm.	663	Historic	Ceramic	Earthenware		Redware		2	Fragments	
T27	T27-02	B1	20-30 cm.	664	Historic	Ceramic	Earthenware	Brown Glaze	Redware	Lead-glazed	3	Fragments	
T27	T27-03	A0/A1	0-10 cm.	680	Historic	Metal	Ferrous Metal		Bracket Plate	Flat W/Flange	2	Fragments	
T27	T27-03	A1	10-20 cm.	681	Historic	Ceramic	Earthenware	Red	Brick		12	Fragments	Some burned.
T27	T27-03	A1	10-20 cm.	682	Historic	Glass	Flat Glass	Lt Aqua Tint	Window Glass		1	Fragment	
T27	T27-03	A1	10-20 cm.	683	Historic	Glass	Flat Glass	Lt Green Tint	Window Glass		1	Fragment	
T27	T27-03	A1/B	20-30 cm.	684	Historic	Ceramic	Earthenware	Red	Brick		5	Fragments	Burn Marks
T27	T27-03	A1/B	20-30 cm.	685	Historic	Glass	Vessel Glass	Green	Bottle Glass	Free-Blown	1	Body Fragment	Wine bottle, may be squat form; deteriorated; 17th-18th century.
T27	T27-03	A1/B	20-30 cm.	686	Historic	Ceramic	Earthenware	Lt Green Tint	Pearlware	Plain	2	Fragments	
T27	T27-04	A1	20-30 cm.	689	Historic	Glass	Insulator Glass	Lt Aqua Tint	For Telegraph Pole	Pressed Glass	1	Rim Fragment	
T27	T27-04	A1	20-30 cm.	690	Historic	Glass	Insulator Glass	Lt Aqua Tint	For Telegraph Pole	Pressed Glass	1	Fragment	Poss. Burn Residue
T27	T27-04	A1	20-30 cm.	691	Historic	Metal	Ferrous Metal		Can Bottom		1	Fragment	
T27	T27-05	A1	20-30 cm.	687	Historic	Ceramic	Earthenware	Red	Brick		1	Fragment	
T27	T27-05	A1	20-30 cm.	688	Historic	Ceramic	Earthenware		Whiteware	Plain	1	Fragment	
T27	T27-10	Ao	0-10 cm.	692	Historic	Glass	Insulator Glass	Lt Aqua Tint	For Telegraph Pole	Pressed Glass	3	Rim Fragments	
T27	T27-10	Ao	0-10 cm.	693	Historic	Glass	Insulator Glass	Lt Aqua Tint	For Telegraph Pole	Pressed Glass	1	Fragment	
T27	T27-10	Ao	0-10 cm.	694	Historic	Glass	Vessel Glass	Lt Green Tint	Bottle Glass		2	Fragments	
T28	T28-2	A0/A1	0-10 cm.	696	Historic	Metal	Ferrous Metal		Metal Bracket	2.5"X3.0 Cut	1	Fragment	End Cut
T28	T28-2E	A0/A1	0-10 cm.	698	Historic	Metal	Ferrous Metal		3/4" Nut-Bolt	Threaded	1	Fragment	Cut Off

Eversource Sudbury-Hudson MA Project Intensive Survey 2018 Catalogue

January 28, 2019

Page 20

Area	Test Pit	Layer	Depth	Cat.#	Era	Class	Material	Color	Description	Detail	Qty	Portion	Comments
T28	T28-2E	A0/A1	0-10 cm.	699	Historic	Metal	Ferrous Metal		Nail, Wire		3	Fragments	
T28	T28-3	A0/A1	0-10 cm.	695	Historic	Metal	Ferrous Metal		3/4" Nut/Bolt	Threaded	1	Fragment	
T28	T28-6	A1	10-20 cm.	697	Historic	Glass	Insulator Glass	Lt Aqua Tint	For Telegraph Pole	Pressed Glass	3	Fragments	
T29	T29-2	A1/B1	20-30 cm.	700	Historic	Metal	Ferrous Metal		Bolt, Threaded	Round 6x3/4"	1	Fragment	Threads To 1/3 Length
T29	T29-3	Ao	0-10 cm.	701	Historic	Glass	Vessel Glass	Lt Green Tint	Bottle Glass	Machine-Made	1	Fragment	
T29	T29-3	Ao	0-10 cm.	702	Historic	Ceramic	Porcelain	Brown	Insulator	Telegraph Line	1	Fragment	
T29	T29-3	Ao	0-10 cm.	703	Historic	Metal	Cuprous Metal		Copper Wire	12 Gauge	1	Fragment	Approx 1 Ft Coil
T29	T29-3	Ao	0-10 cm.	704	Historic	Glass	Insulator Glass	Lt Aqua Tint	For Telegraph Pole	Pressed Glass	1	Near Intact	"AM_TEL&TEL_Co."; threaded.
T30	JTP-21	Fill 1	0-10 cm.	715	Historic	Composite	Glass/Cuprous		Car Fuse	1 1/4"X1/4"	1	Near Intact	
T30	JTP-21	Fill 2	10-25cm	716	Historic	Glass	Insulator Glass	Green	For Telegraph Pole	Pressed Glass	1	Intact	Embossed "Brookfield"
T30	JTP-21	Fill 2	10-25cm	717	Historic	Glass	Insulator Glass	Green	For Telegraph Pole	Pressed Glass	2	Fragments	Pieces Mend
T30	JTP-21	Fill 2	10-25cm	718	Historic	Glass	Insulator Glass	Green	For Telegraph Pole	Pressed Glass	1	Fragment	Same Type
T30	JTP-21	Fill 2	10-25cm	719	Historic	Glass	Insulator Glass	Aqua	For Telegraph Pole	Pressed Glass	2	Fragments	Mends Near Intact "A...T.Co."
T30	JTP-21	Fill 2	10-25cm	720	Historic	Glass	Vessel Glass	Clear	Bottle Glass	Mold-Blown/Machine-Made	3	Body Fragments	
T30	JTP-21	Fill 2	10-25cm	721	Historic	Glass	Flat Glass	Lt Aqua Tint	Window Glass		5	Fragments	
T30	JTP-21	Fill 2	10-25cm	722	Historic	Metal	Ferrous Metal		Indeterminate	Corroded, 3 1/2"L	2	Fragments	Pieces Mend
T30	JTP-21	Fill2/C	25-30cm	723	Historic	Glass	Flat Glass	Lt Aqua Tint	Window Glass		1	Fragment	
T30	JTP-21	Fill2/C	25-30cm	724	Historic	Metal	Ferrous Metal		Nail, Cut		1	Fragment	
T30	JTP-22	Fill	0-10 cm.	725	Historic	Glass	Vessel Glass	Lt Green Tint	Bottle Glass	Mold-Blown/Machine-Made	1	Body Fragment	
T30	JTP-22	Fill	0-10 cm.	726	Historic	Glass	Flat Glass	Lt Aqua Tint	Window Glass		1	Fragment	
T30	JTP-22	Fill	0-10 cm.	727	Historic	Synthetic	Plastic	Gray	Hard Plastic		1	Fragment	
T30	JTP-22	F1/F2	10-20 cm.	728	Historic	Metal	Ferrous Metal		Spike, Cut	5"L1	1	Intact	
T30	JTP-22	F2/B	30-40 cm.	729	Historic	Glass	Vessel Glass	Green	Bottle Glass	Mold-Blown/Machine-Made	1	Fragment	Scorched 1 Side
T30	JTP-23	F3/C Int.	34cm	730	Historic	Ceramic	Ball Clay	Off White	Pipe Stem	4/64" Bore	1	Stem Fragment	"326 McDougall//Scotland"
T30	JTP-25	Fill	10-20 cm.	731	Historic	Glass	Vessel Glass	Clear	Lamp Glass	Mold-Blown	1	Base Fragment	Lamp Globe-Ground Base Rim
T30	T30-1	Ao	0-10 cm.	705	Historic	Metal	Ferrous Metal		Wire Bracket Part	2 Piece	2	Fragments	
T30	T30-2	A	10-20 cm.	706	Historic	Glass	Vessel Glass	Dk Olive Green	Bottle Glass	Machine-Made	3	Body Fragments	
T30	T30-2	A	10-20 cm.	707	Historic	Glass	Vessel Glass	Lt Aqua Tint	Bottle Glass	Machine-Made	2	Base Fragment	
T30	T30-2	A	10-20 cm.	708	Historic	Glass	Vessel Glass	Clear	Bottle Glass	Machine-Made	1	Lip Fragment	
T30	T30-2	A	10-20 cm.	709	Historic	Glass	Vessel Glass	Clear	Bottle Glass	Machine-Made	2	Body Fragments	
T30	T30-3	A0/A1	20-30 cm.	710	Historic	Glass	Flat Glass	Clear	Window Glass		3	Fragments	
T30	T30-3	A0/A1	20-30 cm.	711	Historic	Glass	Vessel Glass	Clear	Bottle Glass	Machine-Made	3	Fragments	"One Pint"
T30	T30-3	A0/A1	20-30 cm.	712	Historic	Glass	Vessel Glass	Lt Aqua Tint	Bottle Glass	Machine-Made	1	Base Fragment	"15"
T30	T30-3	A0/A1	20-30 cm.	713	Historic	Glass	Vessel Glass	Lt Aqua Tint	Bottle Glass	Machine-Made	7	Fragments	
T30	T30-3	A0/A1	20-30 cm.	714	Historic	Glass	Vessel Glass	Blue	Bottle Glass	Machine-Made	1	Body Fragment	
T32	T32-02	Fill	0-10 cm.	732	Historic	Glass	Vessel Glass	Lt Aqua Tint	Bottle Glass	Mold-Blown	1	Body Fragment	
T32	T32-02	Fill 2	10-20 cm.	733	Historic	Ceramic	Earthenware	Red	Brick		1	Fragment	

Eversource Sudbury-Hudson MA Project Intensive Survey 2018 Catalogue

January 28, 2019

Page 21

Area	Test Pit	Layer	Depth	Cat.#	Era	Class	Material	Color	Description	Detail	Qty	Portion	Comments
T32	T32-02	Fill 2	10-20 cm.	734	Historic	Glass	Vessel Glass	Lt Aqua Tint	Bottle Glass	Mold-Blown	1	Body Fragment	Burnt
T32	T32-02	B1	30-40 cm.	735	Historic	Ceramic	Ball Clay	Off White	Pipe Bowl	Tobacco	2	Fragments	Pieces Mend
T32	T32-09	Ao	0-10 cm.	736	Historic	Metal	Ferrous Metal		Nut	1 1/4"X1 1/4"	1	Intact	
T32	T32-11	Ao	0-10 cm.	737	Historic	Glass	Insulator Glass	Lt Aqua Tint	For Telegraph Pole	Pressed Glass	1	Rim Fragment	
T33	T33-09	Ao/A1	0-10 cm.	738	Historic	Glass	Vessel Glass	Lt Amethyst Tint	Bottle Glass	Mold-Blown/Machine-Made	1	Body Fragment	
T33	T33-12	Ao	0-10 cm.	739	Historic	Glass	Insulator Glass	Lt Aqua Tint	For Telegraph Pole	Pressed Glass	3	Fragments	
T33	T33-12	A1	10-20 cm.	740	Historic	Glass	Insulator Glass	Lt Aqua Tint	For Telegraph Pole	Pressed Glass	1	Fragment	
T34	T34-1	A1	10-20 cm.	741	Historic	Ceramic	Earthenware		Whiteware	Plain	1	Fragment	Burned
T34	T34-1	A1	10-20 cm.	742	Historic	Bone/Teeth	Bone		Calcined Bone	Mammal, 1g	1	Fragment	
T34	T34-2	A1	10-20 cm.	743	Historic	Glass	Vessel Glass	Lt Amethyst Tint	Bottle Glass	Mold-Blown/Machine-Made	1	Fragment	
T34	T34-4	A1	10-20 cm.	744	Historic	Glass	Vessel Glass	Clear	Bottle Glass	Machine-Made	1	Body Fragment	
T34	T34-4	A1/B1	20-30 cm.	745	Historic	Ceramic	Earthenware		Redware	Missing Surfaces	1	Fragment	
T34	T34-4	A1/B1	20-30 cm.	746	Historic	Ceramic	Earthenware		Whiteware	Plain	1	Rim Fragment	Molded Rim
T34	T34-6	A1	20-30 cm.	747	Historic	Bone/Teeth	Bone		Calcined Bone	<1g	1	Fragment	
T34	T34-6	A1	20-30 cm.	748	Historic	Coal-Related	Coal Products		Slag	Burned	1	Fragment	
T35	JTP-26	Ao/A1	0-10 cm.	749	Historic	Metal	Ferrous Metal		Cast Iron Plug	2 1/2"Dia	1	Intact	Threaded w/ 1/4" Square Nut Top
T36	T36-1	A1	10-20 cm.	750	Historic	Metal	Ferrous Metal		Square Nut	1"X1"	1	Intact	
T36	T36-3	Ao	0-10 cm.	751	Historic	Glass	Vessel Glass	Clear	Bottle Glass	Machine-Made	1	Body Fragment	
T36	T36-3	Ao	0-10 cm.	752	Historic	Glass	Vessel Glass	Amber	Bottle Glass	Machine-Made	2	Body Fragments	Anheuser Busch Beer, Modern
T37	T37-1	Fill	0-10 cm.	753	Historic	Glass	Vessel Glass	Clear	Bottle Glass	Machine-Made	2	Fragments	
T37	T37-1	Fill	0-10 cm.	754	Historic	Metal	Ferrous Metal		Washer	9/16"Dia	1	Intact	
T37	T37-1	Fill	10-20 cm.	755	Historic	Glass	Vessel Glass	Clear	Bottle Glass	Machine-Made	1	Body Fragment	
T37	T37-1	Fill	10-20 cm.	756	Historic	Metal	Lead		Bullet	.35cal.	1	Intact	Flat Tip, Muzzle Loaded
T37	T37-1	Fill	10-20 cm.	757	Historic	Composite	Metal/Rubber		Electric Cable	W/Loop End	1	Fragment	2 1/2"L
T37	T37-1	Fill	10-20 cm.	758	Historic	Metal	Cuprous Metal		Electric Loop	For Cable 1/2"Dia.	1	Intact	Same As Last Entry
T37	T37-2	Fill 1	20-30 cm.	759	Historic	Synthetic	Plastic	Red	Large Reflector	8 1/2" Dia. Disk	2	Fragments	Pieces Mend
T37	T37-3	Ao	0-10 cm.	760	Historic	Glass	Vessel Glass	Clear	Bottle Glass	Machine-Made	1	Body Fragment	"DOT" Texture
T38	T38-3	A/B	20cm	761	Historic	Metal	Ferrous Metal		Cast Furnace Door	8"X7-1/2"X6/10"	1	Intact	Hinged Door; Illegible letters-4 Lines
T38	T38-4	Ao	0-10 cm.	762	Historic	Bone/Teeth	Bone		Turtle Bone	Carapace	43	Fragments	Unburned. May Be Natural
T38	T38-4	Ao	0-10 cm.	763	Historic	Glass	Vessel Glass	Clear	Bottle Glass	Machine-Made	1	Body Fragment	
T39	T39-04	Surface	0cm	769	Historic	Metal	Ferrous Metal		Machine	17"X15"X8"	1	Near Intact	Found near T39-4; industrial table machine with punch or sewing apparatus; looks mill-related.
T39	T39-05	A1	10-20 cm.	764	Historic	Ceramic	Earthenware		Whiteware	Plain	1	Body Fragment	
T39	T39-05	A1	10-20 cm.	765	Historic	Glass	Insulator Glass	Clear	For Telegraph Pole	Pressed Glass	1	Top Frag.	
T39	T39-05	A1	10-20 cm.	766	Historic	Metal	Ferrous Metal		Wire Spike	6"Long, Burned	1	Intact	
T39	T39-05	A1	20-30 cm.	767	Historic	Ceramic	Earthenware	Blue Edge	Whiteware/Pearlware	Blue Edge	4	Rim Fragments	Pieces Mend, Burned

Eversource Sudbury-Hudson MA Project Intensive Survey 2018 Catalogue

January 28, 2019

Page 22

Area	Test Pit	Layer	Depth	Cat.#	Era	Class	Material	Color	Description	Detail	Qty	Portion	Comments
T39	T39-05	A1	20-30 cm.	768	Historic	Ceramic	Earthenware		Whiteware/Pearlware	Plain	1	Body Fragment	Same as Cat# 767, Burned
T39	T39-07	A/B	40-50 cm.	770	Historic	Metal	Ferrous Metal		Square Nut	1 3/4"X1 3/4"X 1 1/8"	1	Intact	For 1" Dia Bolt
T39	T39-10	Ao/A1	0-10 cm.	771	Historic	Metal	Ferrous Metal		Fence Wire	Braided	2	Fragments	9 1/4"+5" Lengths
T40	T40-1	Ao	0-10 cm.	776	Historic	Glass	Insulator Glass	Lt Aqua Tint	For Telegraph Pole	Pressed Glass	1	Rim Fragment	
T40	T40-1	A1	10-20 cm.	772	Historic	Ceramic	Earthenware	Red	Brick		2	Fragments	
T40	T40-1	A1	10-20 cm.	773	Historic	Glass	Insulator Glass	Aqua	For Telegraph Pole	Pressed Glass	1	Rim Fragment	Toothed Edge, Embossed "...S.A."
T40	T40-1	A1	10-20 cm.	774	Historic	Metal	Cuprous Metal		Wire	1/10" Thick,Bent	1	Fragment	5" Long
T40	T40-1	A1	10-20 cm.	775	Historic	Metal	Cuprous Metal		Wire	1/10" Thick,Bent	1	Fragment	15"+ Long
T40	T40-2	A1/Fill	20-30 cm.	777	Historic	Ceramic	Porcelain	Brown	Insulator		1	Fragment	For telegraph line.
T40	T40-2	A1/Fill	20-30 cm.	778	Historic	Glass	Insulator Glass	Lt Aqua Tint	For Telegraph Pole	Pressed Glass	1	Intact	Threaded
T40	T40-2	A1/Fill 1	20-30 cm.	779	Historic	Glass	Insulator Glass	Lt Aqua Tint	For Telegraph Pole	Pressed Glass	15	Fragments	
T40	T40-2	A1/Fill 1	20-30 cm.	780	Historic	Metal	Cuprous Metal		Thin Gauge Wire	Coated	6	Fragments	10-15 cm long
T40	T40-2	B1	30-40 cm.	781	Historic	Glass	Insulator Glass	Lt Aqua Tint	For Telegraph Pole	Pressed Glass	1	Intact	Threaded
T40	T40-2	B1	30-40 cm.	782	Historic	Glass	Insulator Glass	Lt Aqua Tint	For Telegraph Pole	Pressed Glass	14	Fragments	
T40	T40-3	A1/Fill 1	0-10 cm.	783	Historic	Metal	Ferrous Metal		Nail, Wire	3.5"	1	Intact	
T40	T40-3	A1/Fill 1	0-10 cm.	784	Historic	Glass	Flat Glass	Lt Green Tint	Window Glass		2	Fragments	
T40	T40-3	A1/Fill 1	10-20 cm.	785	Historic	Metal	Ferrous Metal		Nail, Wire	No Head	1	Fragment	
T40	T40-5	A1	0-10 cm.	786	Historic	Metal	Ferrous Metal		Braided Wire W/Anchor	Doubled 20" Long	1	Fragment	
T40	T40-7	A1	20-30 cm.	787	Historic	Ceramic	Porcelain	Brown Glaze	Insulator	Burnt	1	Fragment	For telegraph line.
T41	T41-12	A1/Fill 1	0-10 cm.	788	Historic	Metal	Ferrous Metal		Nail, Wrought	2.5"	1	Near Intact	Large head, rosehead?
T41	T41-12	A1/Fill 1	0-10 cm.	789	Historic	Glass	Vessel Glass	Clear	Bottle Glass	Machine-Made	1	Fragment	
T42	T42-09	A1	10-20 cm.	796	Historic	Glass	Vessel Glass	Clear	Bottle Glass	Machine-Made	2	Fragments	
T42	T42-11	A0/Fill 1	0-10 cm.	790	Historic	Metal	Ferrous Metal		Twisted Wire	Bucket Handle?	1	Fragment	
T43	T43-1	Ao	10-20 cm.	791	Historic	Metal	Ferrous Metal		Spike, Cut	7.5" Long	1	Intact	
T43	T43-12	Surface	0 cm.	792	Historic	Glass	Insulator Glass	Sapphire Blue	For Telegraph Pole	Pressed Glass	1	Intact	"HEMINGRAY 42/MADE IN USA"
T44	T44-2	A1	10-20 cm.	793	Historic	Ceramic	Ball Clay	Off White	Pipe Bowl	Tobacco Pipe	2	Fragments	Pieces mend.
T44	T44-2	A1	10-20 cm.	794	Historic	Glass	Vessel Glass	Clear	Bottle Glass	Machine-Made	1	Small Fragment	
T44	T44-5	A1	10-20 cm.	795	Historic	Metal	Ferrous Metal		Severed Tie/Anchor	11" X 1/4"	1	Near Intact	Metal anchor/stake
T45	JTP-27	Ao	0-10 cm.	976	Historic	Metal	Ferrous Metal		Threaded Bolt W/ Nut	12"X5/8" Dia	1	Near Intact	From telegraph pole.
T45	T45-17	Ao/A1	0-10 cm.	798	Historic	Synthetic	Plastic	White	Small Machine Part	11/16" Dia	1	Intact	"pat pending" spin groove
T45	T45-29	Fill 1	10-20 cm.	797	Historic	Glass	Insulator Glass	Lt Aqua Tint	For Telegraph Pole	Pressed Glass	1	Body Fragment	
T46	T46-1	Fill 1/C1	30-40 cm.	799	Historic	Metal	Ferrous Metal		Threaded Bolt	3/4" Dia	1	Fragment	
T47	T47-1	Ao	0-10 cm.	800	Historic	Ceramic	Earthenware	Red	Brick		3	Fragments	
T48	T48-1	Ao	0-10 cm.	801	Historic	Glass	Vessel Glass	Clear	Bottle Glass	Machine-Made	1	Neck/Handle	Jug neck with handle.
T48	T48-10	Ao	0-10 cm.	802	Historic	Glass	Vessel Glass	Amber	Bottle Glass	Machine-Made	10	Body Fragments	
T49	T49-1	Ao	0-10 cm.	803	Historic	Glass	Vessel Glass	Clear	Bottle Glass	Machine-Made	1	Fragment	
T50	T50-04	A1	20-30 cm.	804	Historic	Ceramic	Earthenware	Gray	Whiteware	Plain, Burned	3	Fragments	

Eversource Sudbury-Hudson MA Project Intensive Survey 2018 Catalogue

January 28, 2019

Page 23

Area	Test Pit	Layer	Depth	Cat.#	Era	Class	Material	Color	Description	Detail	Qty	Portion	Comments
T50	T50-10	A1	0-10 cm.	805	Historic	Metal	Cuprous Metal		Copper Wire	Coiled, 60cm+	1	Fragment	
T51	T51-10	Ao	0-10 cm.	808	Historic	Glass	Insulator Glass	Dk Green Tint	For Telegraph Pole	Pressed Glass	10	Fragments	Threaded
T51	T51-12	Fill 1	0-10 cm.	806	Historic	Metal	Ferrous Metal		1 1/2" Square Nut	Partial Bolt	1	Near Intact	
T51	T51-13	Ao/A1	0-10 cm.	807	Historic	Metal	Ferrous Metal		Hinge/Bracket	2 1/2" X 1 1/2"	1	Near Intact	
T53	JTP-28	Ao	0-10 cm.	81	Historic	Glass	Vessel Glass	Aqua Tint	Bottle Or Insulator	Mold-Blown/Machine-Made	1	Fragment	
T53	T53-1	Ao/F1	0-10 cm.	828	Historic	Glass	Vessel Glass	Clear	Bottle Glass	Machine-Made	1	Base Fragment	"20", "8", "76"
T53	T53-2	Fill 1	0-10 cm.	809	Historic	Metal	Ferrous Metal		Threaded Bolt	2 1/4" L, 5/8 Dia	1	Intact	
T53	T53-2	Fill 1	0-10 cm.	810	Historic	Glass	Vessel Glass	Clear	Bottle Glass	Machine-Made	2	Fragments	Textured exterior
T53	T53-3	Fill 1	10-20 cm.	811	Historic	Glass	Flat Glass	Lt Green Tint	Window Glass	1/4" Thick	1	Fragment	
T53	T53-4	Ao/F1	0-10 cm.	812	Historic	Metal	Ferrous Metal		Indeterminate		1	Fragment	
T53	T53-4	Ao/F1	0-10 cm.	813	Historic	Metal	Ferrous Metal		Wire, Pin	Cotter Pin Or Lock Pin	1	Fragment	
T53	T53-4	Ao/F1	0-10 cm.	814	Historic	Glass	Flat Glass	Lt Aqua Tint	Window Glass		16	Fragments	Burnt, melted
T53	T53-4	Ao/F1	0-10 cm.	815	Historic	Glass	Vessel Glass	Clear	Bottle Glass	Machine-Made	5	Fragments	
T53	T53-4	Fill 1	10-20 cm.	816	Historic	Glass	Flat Glass	Lt Green Tint	Window Glass		10	Fragments	
T53	T53-4	Fill 1	10-20 cm.	817	Historic	Glass	Flat Glass	Clear	Window Glass		1	Fragment	
T53	T53-4	Fill 1	10-20 cm.	818	Historic	Glass	Vessel Glass	Clear	Bottle Glass	Machine-Made	7	Rim/Body Frag	"P.Hood" milk bottle
T53	T53-4	Fill 1	10-20 cm.	819	Historic	Glass	Vessel Glass	Clear	Bottle Glass	Machine-Made	1	Base Fragment	Milk bottle frag
T53	T53-4	Fill 1	10-20 cm.	820	Historic	Glass	Vessel Glass	Amethyst Tint	Bottle Glass	Machine-Made	1	Rim Fragment	Milk bottle type
T53	T53-4	Fill 1	10-20 cm.	821	Historic	Glass	Vessel Glass	Amethyst Tint	Bottle Glass	Machine-Made	1	Body Fragment	Milk bottle type
T53	T53-4	Fill 1	10-20 cm.	822	Historic	Ceramic	Earthenware		Whiteware	Plain	1	Fragment	
T53	T53-4	Fill 1	20-30 cm.	823	Historic	Glass	Vessel Glass	Dark Green	Bottle Glass	Mold-Blown	1	Fragments	
T53	T53-4	Fill 1	20-30 cm.	824	Historic	Glass	Vessel Glass	Clear	Bottle Glass	Machine-Made	1	Fragment	
T53	T53-5	Fill 1	0-10 cm.	825	Historic	Glass	Vessel Glass	Clear	Bottle Glass	Machine-Made	15	Body Fragments	"regi..." & design marks
T53	T53-5	Fill 1	0-10 cm.	826	Historic	Glass	Flat Glass	Lt Green Tint	Window Glass		3	Fragments	
T53	T53-5	Fill 1	0-10 cm.	827	Historic	Glass	Vessel Glass	Clear	Bottle Glass	Machine-Made	1	Fragment	
T53	T53-6	Fill 1	10-20 cm.	829	Historic	Glass	Vessel Glass	Clear	Bottle Glass	Machine-Made	3	Body Fragments	"L. S..."
T53	T53-6	Fill 1	20-30 cm.	830	Historic	Glass	Vessel Glass	Green	Bottle Glass	Machine-Made	1	Body Fragment	
T53	T53-6	Fill 1	20-30 cm.	831	Historic	Glass	Vessel Glass	Clear	Bottle Glass	Machine-Made	1	Body Fragment	
T53	T53-8	Fill 1	0-10 cm.	832	Historic	Glass	Vessel Glass	Clear	Bottle Glass	Machine-Made	1	Body Fragment	Small design visible
T53	T53-9	B2/C	10-20 cm.	833	Historic	Glass	Flat Glass	Lt Green Tint	Window Glass		1	Fragment	Truncated top soil
T53	T53-9	B2/C	10-20 cm.	834	Historic	Glass	Flat Glass	Clear	Window Glass		1	Fragment	Truncated top soil
T53	T53-9	B2/C1	10-20 cm.	835	Historic	Metal	Ferrous Metal		Nail, Cut	Large 3", 5"	2	Near Intact	
T54	JTP-32	A1	0-10 cm.	245	Historic	Glass	Vessel Glass	Dark Green	Bottle Glass	Mold-Blown	1	Body Fragment	W/ bubbles
T54	JTP-33	Fill 1	10-20 cm.	232	Historic	Glass	Flat Glass	Clear	Window Glass		1	Fragment	
T54	T54-1	Fill 1	0-10 cm.	836	Historic	Ceramic	Earthenware	Green Band	Semi-Porcelain	3" Dia Bowl	1	Rim Fragment	Green banded lip
T54	T54-1	Fill 1	0-10 cm.	837	Historic	Ceramic	Earthenware	Red	Brick	1 Surface	1	Fragment	
T54	T54-1	Fill 1	0-10 cm.	838	Historic	Metal	Ferrous Metal		Nail, Wire	1 1/4" Long	1	Intact	Bent

Eversource Sudbury-Hudson MA Project Intensive Survey 2018 Catalogue

January 28, 2019

Page 24

Area	Test Pit	Layer	Depth	Cat.#	Era	Class	Material	Color	Description	Detail	Qty	Portion	Comments
T54	T54-1	Fill 2	20-30 cm.	839	Historic	Ceramic	Earthenware	Red	Brick	Corner	1	Fragment	
T54	T54-1	Fill 2	20-30 cm.	840	Historic	Ceramic	Earthenware	Red	Brick	Plain	1	Fragment	
T54	T54-1	Fill 2	20-30 cm.	841	Historic	Metal	Ferrous Metal		Nail, Wire	3" Long	1	Intact	Finish nail, clinch marks by head
T54	T54-1	Fill 2	20-30 cm.	842	Historic	Glass	Flat Glass	Lt Green Tint	Window Glass		9	Fragments	
T54	T54-2	Ao/F1	0-10 cm.	843	Historic	Glass	Flat Glass	Lt Green Tint	Window Glass		1	Fragment	
T54	T54-2	Ao/F1	0-10 cm.	844	Historic	Metal	Ferrous Metal		Spike, Cut	4" Long	1	Near Intact	Burned
T54	T54-2	Ao/F1	0-10 cm.	845	Historic	Metal	Ferrous Metal		Nail, Cut	2 1/2" Long	1	Near Intact	Burned
T54	T54-2	Ao/F1	0-10 cm.	846	Historic	Metal	Ferrous Metal		Nail, Cut	1 1/2" Long	1	Fragment	
T54	T54-2	Fill 1	10-20 cm.	847	Historic	Ceramic	Earthenware	Red/Black	Brick	Melted	1	Fragment	
T54	T54-2	Fill 1	10-20 cm.	848	Historic	Metal	Ferrous Metal		Nail, Cut	1 1/4" Long	1	Fragment	Burned
T54	T54-2	Fill 1	10-20 cm.	849	Historic	Metal	Ferrous Metal		Nail, Cut	1 1/2"	1	Fragment	Burned, bent
T54	T54-2	Fill 1	20-30 cm.	850	Historic	Ceramic	Earthenware		Whiteware	Plain	1	Body Fragment	
T54	T54-2	Fill 1	20-30 cm.	851	Historic	Ceramic	Earthenware		Creamware	Plain	1	Fragment	Plate, saucer
T54	T54-2	Fill 1	20-30 cm.	852	Historic	Ceramic	Earthenware		Redware	Missing Surfaces	1	Fragment	
T54	T54-2	Fill 1	20-30 cm.	853	Historic	Metal	Ferrous Metal		Spike, Bent	6" Long	1	Near Intact	Burned
T54	T54-3	Ao/F1	0-10 cm.	854	Historic	Glass	Vessel Glass	Clear	Bottle Glass	Mold-Blown/Machine-Made	1	Body Fragment	Burned
T54	T54-3	Ao/F1	0-10 cm.	855	Historic	Glass	Flat Glass	Lt Green Tint	Window Glass		1	Fragment	
T54	T54-3	Ao/F1	0-10 cm.	856	Historic	Metal	Ferrous Metal		Nail, Wrought	2 1/2" Long	1	Intact	Clinch mark by head
T54	T54-3	Ao/F1	0-10 cm.	857	Historic	Metal	Ferrous Metal		Nail, Wrought	1 1/2" Long	1	Near Intact	
T54	T54-3	Fill 1	10-20 cm.	870	Historic	Glass	Flat Glass	Lt Green Tint	Window Glass		15	Fragments	
T54	T54-3	Fill 1	10-20 cm.	871	Historic	Glass	Vessel Glass	Clear	Bottle Glass	Mold-Blown/Machine-Made	1	Body Fragment	Burned
T54	T54-3	Fill 1	10-20 cm.	872	Historic	Glass	Vessel Glass	Lt Aqua Tint	Bottle Glass	Mold-Blown/Machine-Made	1	Body Fragment	
T54	T54-3	Fill 1	10-20 cm.	873	Historic	Glass	Vessel Glass	Clear/White Decal	Bottle Glass	Machine-Made	1	Body Fragment	
T54	T54-3	Fill 1	10-20 cm.	874	Historic	Metal	Ferrous Metal		Nail, Wrought	2 1/4" Long	1	Near Intact	
T54	T54-3	Fill 1	10-20 cm.	875	Historic	Metal	Ferrous Metal		Nail, Wrought	1 1/2" Tip	1	Fragment	
T54	T54-3	Fill 1	10-20 cm.	876	Historic	Metal	Ferrous Metal		Indeterminate	Probable Nail	3	Fragments	
T54	T54-3	Fill 1	20-30 cm.	858	Historic	Glass	Flat Glass	Lt Green Tint	Window Glass		2	Fragments	
T54	T54-3	Fill 1	20-30 cm.	859	Historic	Glass	Vessel Glass	Lt Aqua Tint	Bottle Glass	Machine-Made	2	Fragments	
T54	T54-3	Fill 1	20-30 cm.	860	Historic	Glass	Vessel Glass	Clear	Bottle Glass	Machine-Made	2	Fragments	
T54	T54-3	Fill 1	20-30 cm.	861	Historic	Metal	Ferrous Metal		Iron Bracket/Coupling	8" X 2.5" X 1/4"	2	Intact	
T54	T54-3	Fill 1	20-30 cm.	862	Historic	Metal	Ferrous Metal		Indeterminate Nails	Encrusted	13	Fragments	2 possible cut nails
T54	T54-3	Fill 1	20-30 cm.	863	Historic	Metal	Cuprous Metal		Copper Wire Doubled	4.5" Long	1	Fragment	
T54	T54-5	Fill 1	0-10 cm.	864	Historic	Glass	Vessel Glass	Clear	Bottle Glass	Machine-Made	3	Body Fragments	"ottle...ing" "r" trademark
T54	T54-5	Fill 1	0-10 cm.	865	Historic	Glass	Vessel Glass	Green	Bottle Glass	Machine-Made	2	Body Fragments	
T54	T54-5	Fill 1	0-10 cm.	866	Historic	Glass	Vessel Glass	Lt Green Tint	Bottle Glass	Machine-Made	6	Fragments	"fl","reg" embossed
T54	T54-5	Fill 1	0-10 cm.	867	Historic	Metal	Ferrous Metal		Cap Remnant	2 1/4" Dia	1	Fragment	Pressure valve w/rubber gasket
T54	T54-5	Fill 1	20-30 cm.	868	Historic	Glass	Vessel Glass	Clear	Bottle Glass	Machine-Made	3	Body Fragments	Small decal visible

Eversource Sudbury-Hudson MA Project Intensive Survey 2018 Catalogue

January 28, 2019

Page 25

Area	Test Pit	Layer	Depth	Cat.#	Era	Class	Material	Color	Description	Detail	Qty	Portion	Comments
T54	T54-7	Ao	0-10 cm.	877	Historic	Glass	Vessel Glass	Aqua Tint	Bottle Glass	Mold-Blown Embossed	1	Intact	"Yo-Yo" trademark soda bottle; ca. 1900-1910; applied crown lip.
T54	T54-7	A1	10-20 cm.	869	Historic	Glass	Insulator Glass	Lt Aqua Tint	For Telegraph Pole	Pressed Glass	1	Fragment	
T55	JTP-37	A1	10-20 cm.	887	Historic	Ceramic	Earthenware		Creamware	Plain	1	Body Fragment	
T55	JTP-37	A1	20-30 cm.	889	Precontact	Stone	Rhyolite	Gray	Flake, Secondary	31x30x5mm	1	Debitage	CWP, possibly utilized
T55	JTP-37	A1	20-30 cm.	890	Historic	Ceramic	Earthenware		Pearlware	Plain	1	Fragment	
T55	JTP-37	A1	25cm	888	Precontact	Stone	Rhyolite	Gray Banded	Core	59x51x42mm	1	Debitage	Shows cortex.
T55	JTP-37	A1/B1	30-40 cm.	885	Historic	Ceramic	Stoneware	White	White Salt-Glaze	Slip-Dip	1	Body Fragment	
T55	JTP-37	B1	40-50 cm.	886	Historic	Glass	Vessel Glass	Dk Green	Bottle Glass	Mold-Blown	1	Fragment	Burnt
T55	JTP-37E	A1	0-10 cm.	879	Historic	Metal	Ferrous Metal		Cut Spike	4" Long 7/16 Thick	1	Fragment	
T55	JTP-37N	A1	20-30 cm.	880	Historic	Ceramic	Earthenware	Brown Glaze	Redware	Lead-glazed	1	Body Fragment	
T55	JTP-37S	A1	20-30 cm.	881	Precontact	Stone	Rhyolite	Dark Gray	Shatter, Secondary	30x17x9mm	1	Debitage	CWP
T55	JTP-37W	Ao/A1	10-20 cm.	882	Historic	Ceramic	Earthenware	Red	Brick		1	Fragment	
T55	JTP-37W	A1/B1	30-40 cm.	883	Precontact	Stone	Quartz	White	Core	42x29x22mm	1	Debitage	Shows "B" soil, worked edges.
T55	JTP-37W	A1/B1	30-40 cm.	884	Historic	Ceramic	Earthenware		Creamware	Plain	1	Fragment	
T55	T55-7	A1	10-20 cm.	878	Historic	Glass	Flat Glass	Clear	Window Glass		1	Fragment	
T56	T56-01	Ao	0-10 cm.	891	Historic	Glass	Vessel Glass	Clear	Bottle Glass		1	Base Fragment	
T56	T56-09	A1	30-40 cm.	892	Historic	Ceramic	Earthenware		Whiteware	Plain	1	Rim Fragment	
T56	T56-10	Ao	0-10 cm.	893	Historic	Glass	Flat Glass	Lt Green Tint	Window Glass		1	Fragment	
T56	T56-12	Fill 1	20-30 cm.	896	Historic	Ceramic	Earthenware	Blue 2 Tones	Whiteware	Transfer-Printed	1	Body Fragment	
T56	T56-13	A1	10-20 cm.	897	Historic	Metal	Ferrous Metal		Nail, Cut	3" Long	1	Intact	
T57	T57-1	F1/A1	0-10 cm.	904	Historic	Glass	Insulator Glass	Aqua Tint	For Telegraph Pole	Pressed Glass	1	Fragment	W/Bubbles in Glass
T57	T57-4	F1	10-20 cm.	905	Historic	Glass	Insulator Glass		For Telegraph Pole	Pressed Glass	1	Fragment	
T57	T57-6	F/A1	0-10 cm.	906	Historic	Glass	Vessel Glass	Lt Amethyst Tint	Bottle Glass	Mold-Blown/Machine-Made	4	Body Fragments	Vary In Thickness
T57	T57-6	F/A1	0-10 cm.	907	Historic	Glass	Curved Glass	Frosted	Possible Lightbulb	Thin Lamp Glass	1	Body Fragment	
T57	T57-6	F/A1	0-10 cm.	908	Historic	Metal	Ferrous Metal		Round Head Bolt	1 3/4"X3/4"	1	Near Intact	
T57	T57-6	F/Ao	0-10 cm.	925	Historic	Bone/Teeth	Bone		Calcined Bone		2	Fragments	
T57	T57-6	F/Ao	0-10 cm.	926	Historic	Coal-Related	Coal Products		Clinker		3	Fragments	
T57	T57-6	F/A	10-20 cm.	909	Historic	Glass	Vessel Glass	Lt Amethyst Tint	Bottle Glass	Mold-Blown/Machine-Made	1	Body Fragment	Varies In Thickness
T57	T57-8	Fill	0-10 cm.	913	Historic	Glass	Flat Glass	Lt Green Tint	Window Glass		1	Fragment	
T57	T57-8	F/Ao	10-20 cm.	914	Historic	Bone/Teeth	Bone		Med. Mammal		1	Fragment	Recently rodent Gnawed
T58	JTP-41	Fill 1	10-20 cm.	894	Historic	Ceramic	Earthenware	Red	Brick	Burnt	1	Fragment	
T58	JTP-41	Fill 1	30-40 cm.	895	Historic	Metal	Ferrous Metal		Bent Rod/Crank	7" Long Plus 3" Bend	1	Near Intact	5/8" thick
T58	JTP-41	Fill 1	40-50 cm.	898	Historic	Metal	Cuprous Metal		Coiled Copper Wire	1/8" Dia	1	Intact	
T58	JTP-42	Fill 1	10-20 cm.	899	Historic	Glass	Vessel Glass	Amber	Bottle Glass	Machine-Made	1	Body/Base	Stippled
T58	JTP-42	Fill 1	10-20 cm.	900	Historic	Glass	Vessel Glass	Amber	Bottle Glass	Machine-Made	1	Body Fragment	
T58	JTP-42	Fill 1	10-20 cm.	901	Historic	Glass	Vessel Glass	Green	Bottle Glass	Machine-Made	1	Fragment	

Eversource Sudbury-Hudson MA Project Intensive Survey 2018 Catalogue

January 28, 2019

Page 26

Area	Test Pit	Layer	Depth	Cat.#	Era	Class	Material	Color	Description	Detail	Qty	Portion	Comments
T58	JTP-42	Fill 1	10-20 cm.	902	Historic	Glass	Insulator Glass	Aqua Tint	For Telegraph Pole	Pressed Glass	2	Fragments	W/ bubbles
T58	JTP-42	Fill 1	10-20 cm.	903	Historic	Glass	Insulator Glass	Lt Green Tint	For Telegraph Pole	Pressed Glass	3	Fragments	
T58	JTP-43	Fill 1	0-10 cm.	910	Historic	Metal	Ferrous Metal		Wire Spike	6"L	1	Intact	Rusted
T58	JTP-43	Fill 1	0-10 cm.	911	Historic	Glass	Flat Glass	Lt Green Tint	Window Glass		1	Fragment	
T58	JTP-43	Fill 2	30-40 cm.	912	Historic	Glass	Vessel Glass	Green	Bottle Glass	Machine-Made	1	Fragment	
T58	JTP-44	Ao/F1	0-10 cm.	915	Historic	Ceramic	Earthenware	Red	Brick	1 Surface	1	Fragment	
T58	JTP-44	Ao/F1	0-10 cm.	916	Historic	Glass	Vessel Glass	Amber	Bottle Glass	Machine-Made	18	Body Fragments	
T58	JTP-44	Ao/F1	0-10 cm.	917	Historic	Glass	Vessel Glass	Amber	Bottle Glass	Machine-Made	1	Base Fragment	Embossed "Refill"
T58	JTP-44	Ao/F1	0-10 cm.	918	Historic	Glass	Vessel Glass	Clear	Bottle Glass	Machine-Made	1	Body Fragment	Etched W/White Lettering
T58	JTP-44	Ao/F1	0-10 cm.	919	Historic	Glass	Vessel Glass	Clear	Bottle Glass	Machine-Made	1	Body Fragment	
T58	JTP-44	Ao/F1	0-10 cm.	920	Historic	Glass	Vessel Glass	Aqua Tint	Bottle Glass	Mold-Blown/Machine-Made	1	Body Fragment	
T58	JTP-44	Ao/F1	0-10 cm.	921	Historic	Glass	Vessel Glass	Green Tint	Bottle/Table	Mold-Blown/Machine-Made	1	Fragment	Burned
T58	JTP-44	Ao/F1	0-10 cm.	922	Historic	Metal	Ferrous Metal		Nail Frags		7	Fragments	Encrusted
T58	JTP-44	Ao/F1	0-10 cm.	923	Historic	Glass	Flat Glass	Lt Green Tint	Window Glass		1	Fragment	
T58	JTP-44	Ao/F1	0-10 cm.	924	Historic	Composite	Asphalt		Tar Paper		1	Fragment	
T58	JTP-44	Fill 2	20-30 cm.	927	Historic	Glass	Vessel Glass	Aqua Tint	Bottle Glass	Mold-Blown/Machine-Made	1	Body Fragment	Bubbles in Glass
T58	JTP-44	Fill 2	20-30 cm.	928	Historic	Ceramic	Earthenware	Red	Brick	1 Surface	1	Fragment	
T58	JTP-44	Fill 2	20-30 cm.	929	Historic	Glass	Vessel Glass	Aqua Tint	Indeterminate	Burned & Melted	9	Fragments	
T58	JTP-44	Fill 2	20-30 cm.	930	Historic	Wood	Wood	Black/Brown	Architectural Timber	Partially Burned	1	Fragment	
T58	JTP-44	Fill 2	20-30 cm.	931	Historic	Metal	Ferrous Metal		Nail Frags	Indeterminate	7	Fragments	Encrusted
T58	JTP-44	Fill 2	20-30 cm.	932	Historic	Ferrous & Glas	Ferrous & Glass	Brown & Aqua	Burned & Encrusted	Slag	3	Fragments	Iron Concretion w/Melted Glass
T58	JTP-44	Fill 2	20-30 cm.	933	Historic	Glass	Flat Glass	Clear	Window Glass		1	Fragment	
T58	JTP-44	Fill 2	30-40 cm.	934	Historic	Glass	Vessel Glass	Aqua Tint	Bottle Glass	Mold-Blown/Machine-Made	1	Body Fragment	W/Bubbles In Glass
T58	JTP-44	Fill 2	30-40 cm.	935	Historic	Metal	Ferrous Metal		Wire Nail	2 1/2"L	1	Near Intact	Encrusted
T58	JTP-44	Fill 2	30-40 cm.	936	Historic	Metal	Ferrous Metal		Indeterminate Nail	2"L	1	Fragment	Encrusted
T58	JTP-44	Fill 2	30-40 cm.	937	Historic	Metal	Ferrous Metal		Nail Frags	Indeterminate	13	Fragments	Encrusted
T58	JTP-44	Fill 2	40-50 cm.	938	Historic	Glass	Melted Glass	Aqua Tint	Burned	Indeterminate	3	Fragments	
T58	JTP-44	Fill 2	40-50 cm.	939	Historic	Metal	Ferrous Metal		Wire Nail	Head	1	Fragment	
T58	JTP-44	Fill 2	40-50 cm.	940	Historic	Metal	Ferrous Metal		Nail, Indeterminate		5	Fragments	Encrusted
T58	JTP-44	Fill 2	40-50 cm.	941	Historic	Metal	Cuprous Metal		.22 Shell		1	Near Intact	
T58	JTP-44	Fill 2	40-50 cm.	942	Historic	Wood	Wood	Black	Timber	Burned	1	Fragment	Probably Architectual
T58	JTP-44	Fill 2	40-50 cm.	943	Historic	Ferrous & Glas	Ferrous & Glass	Brown & Aqua	Burned & Encrusted	Slag	1	Fragment	
T58	T58-1	Ao	0-10 cm.	944	Historic	Glass	Insulator Glass	Dk Blue Tint	For Telegraph Pole	Pressed Glass	1	Fragment	Spiked Edge
T58	T58-1	Ao	0-10 cm.	945	Historic	Glass	Vessel Glass	Clear	Bottle Glass	Machine-Made	1	Fragment	
T58	T58-1	Ao	0-10 cm.	946	Historic	Metal	Ferrous Metal		Bolt	4 1/2"X5/8"	1	Near Intact	W/Flange/Washer
T58	T58-1	Ao	0-10 cm.	947	Historic	Glass	Vessel Glass	Clear	Light Bulb Glass		1	Fragment	
T58	T58-3	Ao	0-10 cm.	952	Historic	Glass	Insulator Glass	Aqua Tint	For Telegraph Pole	Pressed Glass	1	Fragment	

Eversource Sudbury-Hudson MA Project Intensive Survey 2018 Catalogue

January 28, 2019

Page 27

Area	Test Pit	Layer	Depth	Cat.#	Era	Class	Material	Color	Description	Detail	Qty	Portion	Comments
T58	T58-3	Ao	0-10 cm.	953	Historic	Glass	Vessel Glass	Clear	Bottle Glass	Machine-Made	1	Fragment	
T58	T58-3	Ao	0-10 cm.	954	Historic	Glass	Flat Glass	Clear	Window Glass		1	Fragment	
T58	T58-4	Ao	0-10 cm.	955	Historic	Glass	Insulator Glass	Lt Aqua Tint	For Telegraph Pole	Pressed Glass	4	Fragments	Pronged Edge
T58	T58-4	Ao	0-10 cm.	956	Historic	Ceramic	Earthenware	Red	Brick		1	Fragment	
T58	T58-4	Ao	0-10 cm.	957	Historic	Glass	Vessel Glass	Clear	Bottle Glass	Mold-Blown/Machine-Made	1	Body Fragment	Square edge bottle.
T58	T58-4	Ao	0-10 cm.	958	Historic	Glass	Insulator Glass	Clear	For Telegraph Pole	Pressed Glass	1	Body Fragment	"TUM"
T58	T58-4	Ao	0-10 cm.	959	Historic	Glass	Vessel Glass	Lt Amethyst Tint	Bottle Glass	Mold-Blown/Machine-Made	1	Fragment	
T58	T58-5	Fill 1	10-20 cm.	960	Historic	Ceramic	Earthenware	Red	Brick	Burnt	1	Fragment	
T58	T58-5	Fill 2	30-40 cm.	950	Historic	Ceramic	Earthenware		Ironstone		3	Fragments	1 Rim Frag
T58	T58-5	Fill 2	30-40 cm.	951	Historic	Ceramic	Earthenware	Blue	Whiteware	Transfer-Printed	1	Fragment	
T58	T58-6	Ao/F1	0-10 cm.	948	Historic	Glass	Vessel Glass	Lt Green Tint	Bottle Glass		1	Body Fragment	
T58	T58-6	Ao/F1	0-10 cm.	949	Historic	Metal	Ferrous Metal		Indeterminate	Indeterminate	3	Fragments	
T58	T58-6	Fill 1	10-20 cm.	961	Historic	Metal	Ferrous Metal		Nail, Cut	3.5"	1	Near Intact	No Head
T58	T58-6	Fill 1	10-20 cm.	962	Historic	Metal	Ferrous Metal		Indeterminate	Indeterminate	7	Fragments	
T59	T59-2	Fill 1	10-20 cm.	963	Historic	Ceramic	Earthenware	Red	Brick		1	Fragment	
T59	T59-2	Fill 1	10-20 cm.	964	Historic	Glass	Vessel Glass	Aqua Tint	Indeterminate		1	Small Fragment	
T59	T59-2	Fill 1	30-40 cm.	965	Historic	Ceramic	Earthenware	Dk Brown Glaze	Redware	Pb Glazed	1	Body Fragment	
T59	T59-2	Fill 2	50-60 cm.	966	Historic	Glass	Vessel Glass	Clear	Table Glass	Machine-Made	1	Rim Fragment	Probably Tumbler
T59	T59-2	Fill 2	50-60 cm.	967	Historic	Glass	Insulator Glass	Aqua Tint	For Telegraph Pole	Pressed Glass	1	Fragment	
T59	T59-4	Ao/F1	0-10 cm.	968	Historic	Glass	Flat Glass	Lt Green Tint	Window Glass		2	Fragments	
T59	T59-4	F2/A	30-40 cm.	969	Historic	Ceramic	Earthenware		Redware	Missing Surfaces	1	Body Fragment	
T59	T59-4	A	40-50 cm.	970	Historic	Ceramic	Earthenware		Whiteware	Plain	1	Body Fragment	
T59	T59-4	A	40-50 cm.	971	Historic	Ceramic	Earthenware	Dk Brown Glaze	Redware	Ext. Pb Glaze Int. Miss	1	Body Fragment	
T59	T59-4	A	40-50 cm.	972	Historic	Metal	Ferrous Metal		Nail, Cut	1 1/2"L	1	Near Intact	Encrusted

APPENDIX II -

**Avoidance and Protection Plan for the Granite
Town Marker at the Sudbury-Hudson-
Marlborough Boundary near Old Concord Road**

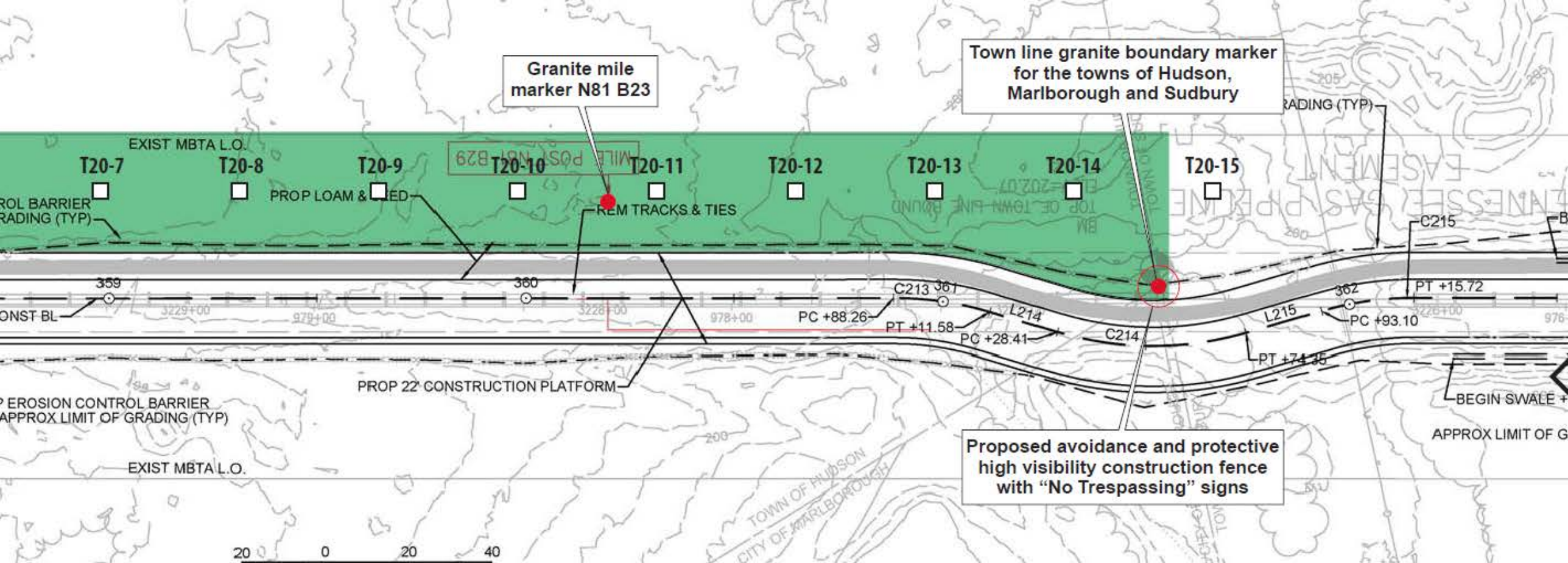

Granite mile marker N81 B23

Town line granite boundary marker for the towns of Hudson, Marlborough and Sudbury

T20-7

T20-8

T20-9

T20-10

T20-11

T20-12

T20-13

T20-14

T20-15

CONTROL BARRIER GRADING (TYP)

PROP LOAM & BED

REM TRACKS & TIES

GRADING (TYP)

CONST BL

3229+00

979+00

360

3228+00

978+00

PC +88.26

PT +11.58

PC +28.41

C214

PT +74.85

PC +93.10

PT +15.72

978

EROSION CONTROL BARRIER APPROX LIMIT OF GRADING (TYP)

PROP 22' CONSTRUCTION PLATFORM

BEGIN SWALE + APPROX LIMIT OF GRADING (TYP)

EXIST MBTA L.O.

Proposed avoidance and protective high visibility construction fence with "No Trespassing" signs

0 20 40

TOWN OF HUDSON
CITY OF MARLBOROUGH

PROP 22' CONSTRUCTION PLATFORM

MILE POST N81 B29

& SEED

BM
TOP OF TOWN LINE BOUND
ELEV=202.07

TOWN OF HUDSON
TOWN OF SUDBURY

BEGIN SWALE

PT +74.35

PT +15.72

360

5226+00

978+00

PC +88.26

C213 361

PT +11.58

L214

PC +28.41

C214

PC +93.10

L215

C215

5226+00

976+00

BEGIN SWALE +25

PROP CHECK DAM (TYP)

PROP LIMIT OF GRADING (TYP)

TOWN OF HUDSON
CITY OF MARLBOROUGH

TOWN OF SUDBURY
CITY OF MARLBOROUGH

TOWN BOUNDARY MARKER

0 40

T