

Town of Sudbury

Community Preservation Committee

<http://www.sudbury.ma.us>
email: cpc@sudbury.ma.us

PROJECT SUBMISSION FORM

Submitter: Esme E. Green

Submission Date: 10/11/2019

Group or Committee Affiliation (if any): Goodnow Library

Submitter's address :

21 Concord Rd
Sudbury, MA 01776

Submitter's email & phone number:

GreenE@sudbury.ma.us/978-440-5515

Purpose (please select all that apply):

- Open Space
- Community Housing
- Historic
- Recreation

Project Manager's email & phone number: Same as submitter's info

Project Name: Final Phase of Reimagining the Second Floor: Converting the Historic Room into Quiet Study

Project Description: See attached

Costs:

Fiscal Year	Total Project Cost	CPC Funds Requested	Other Funding Sources (amount and source)
2021	200,000	130,000	Goodnow Library Foundation
2022			
2023			
2024			
2025			
Total			

How does this project meet the General Criteria and Category Specific Criteria for CPC projects (see attached)?

See attached

Does this project fall within the jurisdiction or interest of other Town Boards, Committees or Departments? If so, please list the boards, committees or departments, whether applications and/or presentations have been made, and what input or recommendations have been given.

The Goodnow Library Trustees, Combined Facilities

For Community Preservation Committee Use:

Form received on: _____

Project presented to CPC on: _____

Reviewed by: _____

Determination: _____

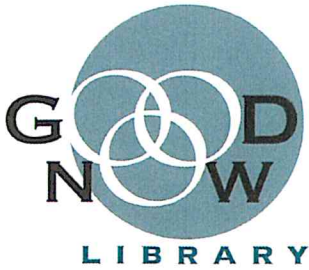

GOODNOW LIBRARY

Create. Cultivate. Collaborate.

Project description:

The Goodnow Library is requesting \$130,000 to cover the cost of refurbishing the library's Historical Room to include more functional shelving for the collection, locking cases for the unique documents and artifacts in the library's local history collection, the installation of large reading tables, lighting and extra power outlets. This project also includes acoustic buffering to promote quiet work and study.

How does this project meet the General Criteria and Category Specific Criteria for CPC projects (see attached)?

This project meets the criteria for Historic proposal in that it is securing and protecting the library's unique special collections, and makes the Historic Room more accessible to residents to work and study while maintaining the original character of the space. During the library's last strategic planning process, we received feedback that users were looking for quiet space in which to work. Additionally, in the past three years we have been working to evaluate, identify and make more accessible the library's special local history collections. This project would allow us better and safer storage, and the ability to curate and display items of interest from the collection. It would also make more use of a beautiful space that has typically been "off-limits" to the public.

This is the final phase of the library's multi-year "Reimagining the Second Floor Project." The previous phases included refitting the Teen Room to create an all-ages "makerspace," reconfiguring the second floor to create a new Teen Space with teen and study friendly furniture, a dedicated Computing and Technology area, an Assistive Technology area, new paint, carpeting and book display units. This project has been the result of a joint effort of the library, Goodnow Library Foundation and the town of Sudbury.

Attached, please see cost estimates and visual representation of the plan. We are happy to answer any questions you have.

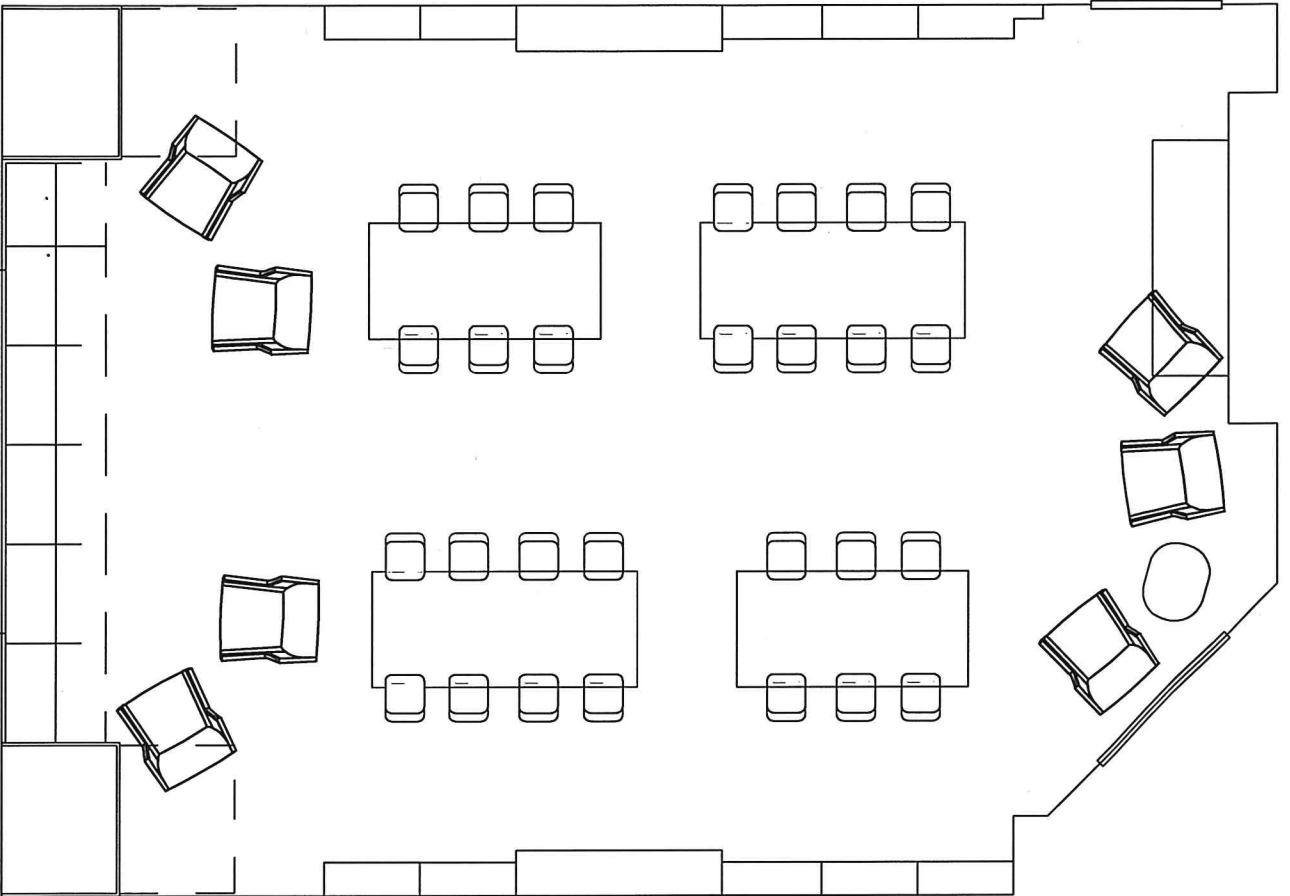

**Goodnow Library
Sudbury, MA**

Date: 3-25-19

Scale: NTS

Revisions:

Notes:

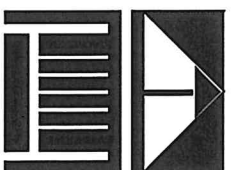

TUCKER
Library Interiors
L.L.C.

27 HARVEY ROAD
BEDFORD, NH 03110
Units 1&2
603-666-7030

www.tuckerlibraryinteriors.com

Copyright © 2008 Tucker Library Interiors, LLC. All rights reserved. No part of this drawing, including questions and interior design concepts, may be reproduced or transmitted in any form, by any means without the prior written permission of Tucker Library Interiors, LLC.

Sheet
Option D

Goodnow Library Historical Room Furnishings Cost Estimate

Estimate Date: 10/4/2019



Item #	Categories	Pricing 10/14	Comments re DWW Pricing
1	Window Credenza	\$ 6,875	Rift white oak (RWO) credenza, inset style; 12 lockable drawers (6ea on left & right sides), Blum soft close drawer slides
2	Bookcase Cabinets (12ea)	\$ 16,674	RWO 1 1/2" frame surround bookcase cabinet
4	Mapcase (2ea)	\$ 10,082	RWO inset style; 10 drawer map table with RWO top (counter) on Blum soft close drawer slides
6	Computer Station Cabinet	\$ 5,852	RWO inset style with pullout keyboard tray
7	Lateral File Cabinet (2ea)	\$ 4,092	RWO inset style 5 drawer vertical file cabinet with interchangeable legal and letter file storage
9	Working Table (2ea)	\$ 33,374	RWO with 1 1/2 inch solid wood top and tapered legs
11	Storage Shelving (8ea)	\$ 8,888	Pre-finished maple plywood with solid wood edge; utilitarian style storage cabinets
12	Chairs (16ea)	\$ 6,592	RWO chairs to match 2 Working Tables
13	Misc Hardware (knobs & pulls)	\$ 2,654	Supply knobs, pulls and bumpers for drawers and doors

Sub Total	\$ 95,083
MA Sales Tax 6.25%	\$ 5,943
Total	\$ 101,026
Delivery Cost	\$ 3,374
Installation Cost	\$ 24,899
Project Total	\$ 129,299

Delivery Costs to site
Installation of cabinetry in Historical room and storage shelving in supply room

General Notes:

1. Estimate valid for 30 days
2. The following is to furnish and install the above referenced millwork furnishings and fixtures
3. If any work is not referenced in the above scope of work, it is assumed to be conducted "by others"