

**NOTICE OF PUBLIC MEETING  
SUDBURY CONSERVATION COMMISSION  
Monday, February 26, 2024 at 7:00 PM  
Virtual Meeting**

The Sudbury Conservation Commission will hold a public meeting to review the Request for Determination of Applicability filing under the Wetlands Protection Act and the Sudbury Wetlands Administration Bylaw to remove trees within the 100-foot Buffer Zone at 255 Peakham Road, in Sudbury, MA. Nick Pernice, Applicant. The meeting will be held on Monday, February 26, 2024 at 7:00 pm, via Zoom.

Copies of the application may be reviewed on the Conservation Department web page at:

<https://sudbury.ma.us/conservationcommission/meeting/conservation-commission-meeting-monday-february-26-2024/>

Please contact the Conservation Office with any questions at 978-440-5470.

SUDBURY CONSERVATION COMMISSION  
2/12/2024



Massachusetts Department of Environmental Protection  
Bureau of Water Resources - Wetlands

**WPA Form 1- Request for Determination of Applicability** Sudbury  
Massachusetts Wetlands Protection Act M.G.L. c. 131, §40 Municipality

**A. General Information**

**Important:**  
When filling out forms on the computer, use only the tab key to move your cursor - do not use the return key.



1. Applicant:  
Nick Pernice  
 First Name Last Name  
255 Peakham Rd  
 Address  
Sudbury ma 01776  
 City/Town State Zip Code  
323 600-3190  
 Phone Number  
 Email Address

2. Property Owner (if different from Applicant):  
Joan Pernice - Sherman  
 First Name Last Name  
255 Peakham Rd  
 Address  
Sudbury MA 01776  
 City/Town State Zip Code  
978 443-2469  
 Phone Number  
 Email Address (if known)

3. Representative (if any)  
 First Name Last Name  
 Company Name  
 Address  
 City/Town State Zip Code  
 Phone Number Email Address (if known)

**B. Project Description**

1. a. Project Location (use maps and plans to identify the location of the area subject to this request):  
255 Peakham Rd Sudbury  
 Street Address City/Town  
42.37276  
 Latitude (Decimal Degrees Format with 5 digits after decimal e.g. XX.XXXXX)  
-71.44554  
 Longitude (Decimal Degrees Format with 5 digits after decimal e.g. -XX.XXXXX)  
Assessors' Map Number JOS-0010  
 Assessors' Lot/Parcel Number

How to find Latitude and Longitude

and how to convert to decimal degrees

b. Area Description (use additional paper, if necessary):  
West + NW side of house

c. Plan and/or Map Reference(s): (use additional paper if necessary)  
PLAN # 1  
 Title Date 2/06/2024  
GIS MAP - 255 Peakham Rd  
 Title Date 2/08/2024

Received



**B. Project Description (cont.)**

2. a. Activity/Work Description (use additional paper and/or provide plan(s) of Activity, if necessary):

Emergency Tree removal

b. Identify provisions of the Wetlands Protection Act or regulations which may exempt the applicant from having to file a Notice of Intent for all or part of the described work (use additional paper, if necessary).

---

3. a. If this application is a Request for Determination of Scope of Alternatives for work in the Riverfront Area, indicate the one classification below that best describes the project.

- Single family house on a lot recorded on or before 8/1/96
- Single family house on a lot recorded after 8/1/96
- Expansion of an existing structure on a lot recorded after 8/1/96
- Project, other than a single-family house or public project, where the applicant owned the lot before 8/7/96
- New agriculture or aquaculture project
- Public project where funds were appropriated prior to 8/7/96
- Project on a lot shown on an approved, definitive subdivision plan where there is a recorded deed restriction limiting total alteration of the Riverfront Area for the entire subdivision
- Residential subdivision; institutional, industrial, or commercial project
- Municipal project
- District, county, state, or federal government project
- Project required to evaluate off-site alternatives in more than one municipality in an Environmental Impact Report under MEPA or in an alternatives analysis pursuant to an application for a 404 permit from the U.S. Army Corps of Engineers or 401 Water Quality Certification from the Department of Environmental Protection.

- b. Provide evidence (e.g., record of date subdivision lot was recorded) supporting the classification above (use additional paper and/or attach appropriate documents, if necessary).
-



Massachusetts Department of Environmental Protection  
Bureau of Water Resources - Wetlands

**WPA Form 1- Request for Determination of Applicability** Sudbury

Massachusetts Wetlands Protection Act M.G.L. c. 131, §40

Municipality

**C. Determinations**

1. I request the \_\_\_\_\_ make the following determination(s). Check any that apply:  
Conservation Commission

- a. whether the **area** depicted on plan(s) and/or map(s) referenced above is an area subject to jurisdiction of the Wetlands Protection Act.
- b. whether the **boundaries** of resource area(s) depicted on plan(s) and/or map(s) referenced above are accurately delineated.
- c. whether the **Activities** depicted on plan(s) referenced above is subject to the Wetlands Protection Act and its regulations.
- d. whether the area and/or Activities depicted on plan(s) referenced above is subject to the jurisdiction of any **municipal wetlands' ordinance or bylaw** of:

Sudbury  
Name of Municipality

- e. whether the following **scope of alternatives** is adequate for Activities in the Riverfront Area as depicted on referenced plan(s).

**D. Signatures and Submittal Requirements**

I hereby certify under the penalties of perjury that the foregoing Request for Determination of Applicability and accompanying plans, documents, and supporting data are true and complete to the best of my knowledge.

I further certify that the property owner, if different from the applicant, and the appropriate DEP Regional Office were sent a complete copy of this Request (including all appropriate documentation) simultaneously with the submittal of this Request to the Conservation Commission.

Failure by the applicant to send copies in a timely manner may result in dismissal of the Request for Determination of Applicability.

Signatures:

I also understand that notification of this Request will be placed in a local newspaper at my expense in accordance with Section 10.05(3)(b)(1) of the Wetlands Protection Act regulations.

\_\_\_\_\_  
Signature of Applicant

\_\_\_\_\_  
Date 2/6/2024

\_\_\_\_\_  
Signature of Representative (if any)

\_\_\_\_\_  
Date

Sherman  
255 Peckham Rd  
Sudbury MA 01776  
PEACKHAM RD

PLAN #1  
Remove 3 trees

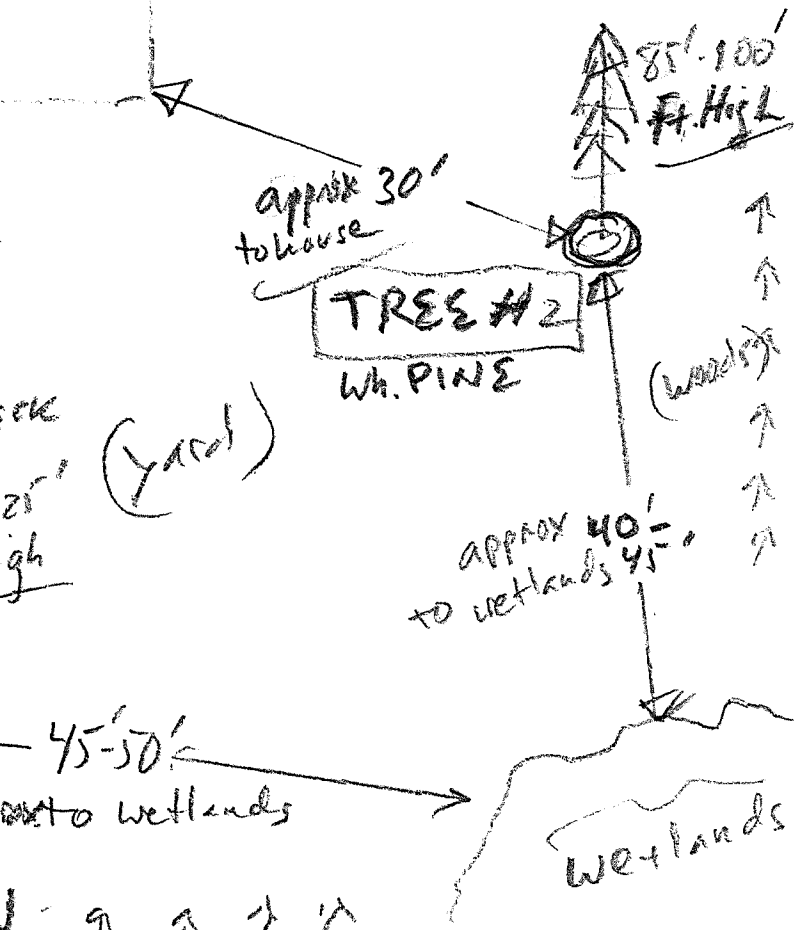
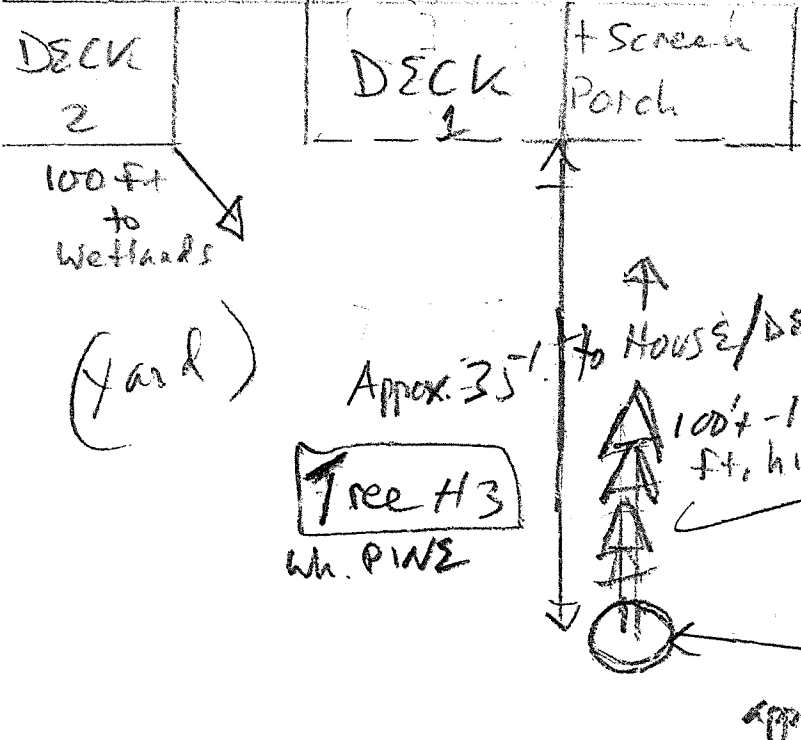
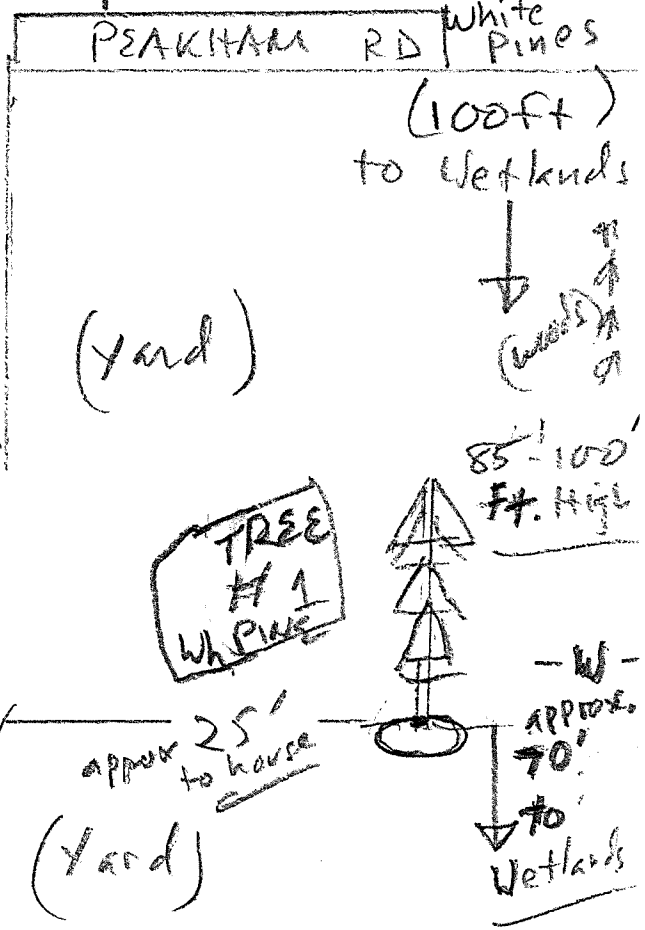
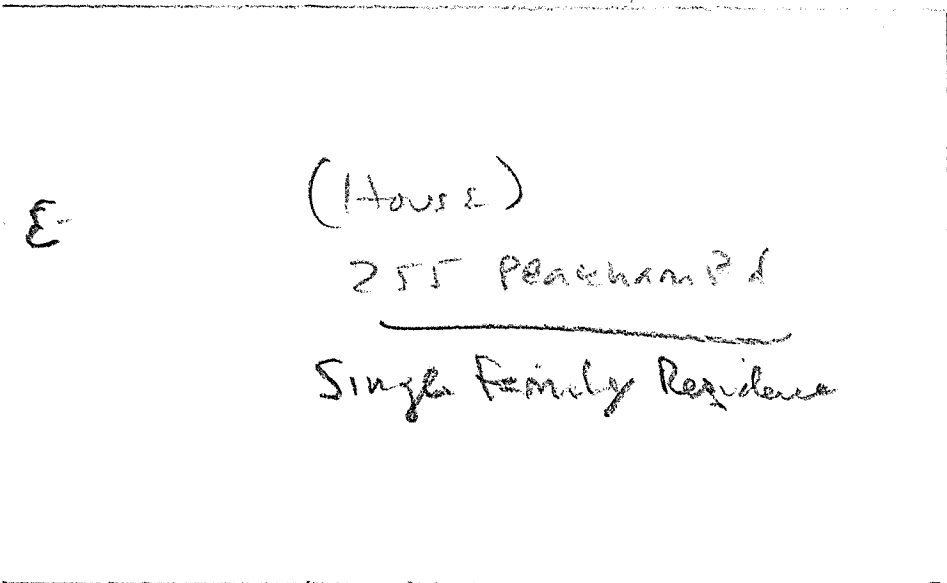
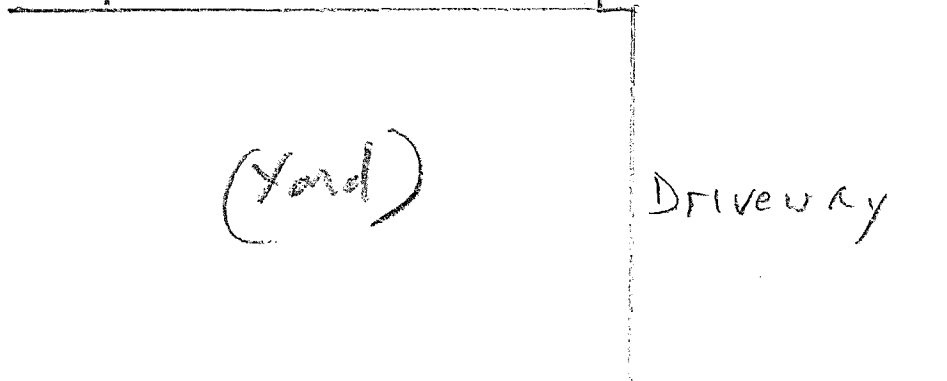



- Parcels with Orthos
- Wetlands Town 2008
  - Open Water
  - Deep Marsh
  - Shallow Marsh/Mead
  - Bog
  - Shrub Swamp
  - Wooded Swamp Dec
  - Wooded Swamp Cor
  - Wooded Swamp Mix
- Wetlands DEP 1/2009
  - Marsh/Bog
  - Wooded marsh
  - Open Water
  - Reservoir (with PWS)
- Streams Ortho
- Streams CIR
- Lake/Reservoir
- MA Highways
  - Interstate
  - US Highway
  - Numbered Routes
- Town Boundary

The data shown on this site are provided for informational and planning purposes only. The Town and its consultants are not responsible for the misuse or misrepresentation of the data.

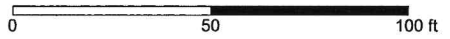

Printed on 02/08/2024 at 12:24 PM

255 Peakham Road