



**NOTICE OF PUBLIC HEARING
SUDBURY CONSERVATION COMMISSION
VIRTUAL MEETING**

The Sudbury Conservation Commission will hold a public hearing to review the Notice of Intent filing, under the State Act and local Wetland Bylaw to remove 16 damaged/dangerous trees within the 100-foot Buffer Zone at 33 Maynard Road, in Sudbury, MA., Evan Kyparissoudas, applicant. The hearing will be held on Monday, June 15, 2020 at 6:30 pm, via remote participation (<https://us02web.zoom.us/j/368460001> is the link to join this Hearing via Zoom). Copies of the application may be reviewed on the Conservation Department web page at; <https://sudbury.ma.us/conservationcommission/meeting/conservation-commission-meeting-monday-june-15-2020/>

Please contact the Conservation Office with any questions at 978-440-5470.

SUDBURY CONSERVATION COMMISSION
June 1, 2020

David W. Burke
WETLANDS RESOURCE SPECIALIST
16 Coburn Rd
Berlin MA
978-758-6957

May 26th, 2020

Lori Capone, Conservation Coordinator
Sudbury Conservation Offices
275 Old Lancaster Rd
Sudbury MA, 01776

Via: Email

Ref: 33 Maynard Rd NOI for tree removal.

Dear Lori:

I am writing on the behalf of homeowner Evan Kyparissoudas in support of a Notice of Intent Application which is attached. This is an After the Fact Filing in that 10 days ago or so a very high wind wound through north-central Sudbury and among other things caused a very large double spired white pine tree to shear off and land in the rear yard of 33 Maynard. The tree caused damage to the pool facility and fencing, missing the southwest corner of the house by a matter of less than 20 feet. Another large pine snapped in half in the front yard and was left dangling over the neighbor's property. Sudbury Police was informed and advised that such a hanging tree constituted a dangerous situation.

Mr. Kyparissoudas had not been living in the house of late as he was too concerned that one of the towering pines (75' plus) may crush the house while he was sleeping several huge trees are located within 15-20' of the house.

A total of the big trees fall within 100' of a wetlands (replication) area bordering on a brook which is off site to the west; they exist within the 100' Buffer Zone to a BVW and also within the Town of Sudbury's Upland Resource Area.

You and I have reviewed the wetlands boundary and replication area very recently in the field and the Sudbury Commission has just last hearing voted in agreement that the replication was succeeding and was within substantial compliance with the referenced Order of Conditions DEP# 301-1249 thereby issuing a Certificate of Compliance. At that same hearing the Commission granted an Emergency Order of Conditions for limited removal of dangerous trees at 33 Maynard Rd. This filing supports that decision.

Last Friday Rusty's Tree service came to the site and plucked all 13 trees within your jurisdiction. It was a one-day job involving one set up of the brand-new crane. Trees were plucked limbs were chipped on site for same day removal and large log butts up to 16' were carefully stacked within the front yard on the lawn organized for removal by log truck. No impact to wetlands occurred and no soils were damaged by equipment.

2.

The crane was set up in the driveway and was able to swing trees over the house. The hanging tree was removed. The work is done.

We should also mention the fact that the pool fence was destroyed and minor damage to the pool apron did occur by the windfall at the very least a new fence will be installed per safety code in Sudbury. The 18'x36' pool is within the Buffer Zone to BVW nearly attached to the rear of the house. Including the wetlands restoration area, this 1.03-acre site is at least 50% wooded so sensible planting sites for off-setting mitigation is limited.

I would suggest to the Commission that when the fence is replaced assuming in same location around the pool at least 26, 36" tall native shrubs be installed along the outside of the fence, these could be arbor vitae or rhododendron, Mt Laurel and or winterberry. I have not consulted with my client on specifics but we did talk about plantings.

The applicant is also requesting the option to chip white pine stumps left near the house to prevent carpenter ant problems.

Attached top this narrative please find:

- *A check in the amount of \$67.50 to the Town of Sudbury*
- *A copy of the check to the Commonwealth in the amount of \$42.50*
- *A GIS Map*
- *A reference plan done by Josh Hassenfuss in support of the last filing*
- *A completed Form 3 NOI Application*
- *A completed Fee Transmittal Form*
- *An abutters list*

Thank you and Chairman Friedlander for you quick response to our request to move so quickly to remove the trees and enabling a single day set up for the crane which is very expensive to employ, however it does the least damage to collateral surroundings. Thank you for supporting this request and we look forward to seeing you as needed on site again if you wish to view the work.

Sincerely,

Dave Burke

Wetlands Resource Specialist



Massachusetts Department of Environmental Protection
 Bureau of Resource Protection - Wetlands

WPA Form 3 – Notice of Intent

Massachusetts Wetlands Protection Act M.G.L. c. 131, §40

Provided by MassDEP:

MassDEP File Number

Document Transaction Number

Sudbury

City/Town

Important:
 When filling out forms on the computer, use only the tab key to move your cursor - do not use the return key.



Note:
 Before completing this form consult your local Conservation Commission regarding any municipal bylaw or ordinance.

A. General Information

1. Project Location (**Note:** electronic filers will click on button to locate project site):

<u>33 Maynard Rd</u>	<u>Sudbury</u>	<u>01776</u>
a. Street Address	b. City/Town	c. Zip Code
Latitude and Longitude:		
<u>G08</u>	<u>42'23.300'N</u>	<u>71'25.243W</u>
f. Assessors Map/Plat Number	d. Latitude	e. Longitude
	<u>0030</u>	
	g. Parcel /Lot Number	

2. Applicant:

<u>Evan</u>	<u>Kyparissoudas</u>	
a. First Name	b. Last Name	
<u>OWNER</u>		
c. Organization		
<u>33 Maynard Rd</u>		
d. Street Address		
<u>Sudbury</u>	<u>MA</u>	<u>01776</u>
e. City/Town	f. State	g. Zip Code
<u>617-816-5093</u>	<u>fullercorp@gmail.com</u>	
h. Phone Number	i. Fax Number	j. Email Address

3. Property owner (required if different from applicant): Check if more than one owner

<u>SAME</u>		
a. First Name	b. Last Name	
c. Organization		
d. Street Address		
e. City/Town	f. State	g. Zip Code
h. Phone Number	i. Fax Number	j. Email address

4. Representative (if any):

<u>David</u>	<u>Burke</u>	
a. First Name	b. Last Name	
<u>Wetlands Resource Specialist</u>		
c. Company		
<u>16 Coburn Rd</u>		
d. Street Address		
<u>Berlin</u>	<u>MA</u>	<u>01503</u>
e. City/Town	f. State	g. Zip Code
<u>978-758-6957</u>	<u>DWFBurke@hotmail.com</u>	
h. Phone Number	i. Fax Number	j. Email address

5. Total WPA Fee Paid (from NOI Wetland Fee Transmittal Form):

<u>110.00</u>	<u>42.50</u>	<u>67.50</u>
a. Total Fee Paid	b. State Fee Paid	c. City/Town Fee Paid



Massachusetts Department of Environmental Protection
Bureau of Resource Protection - Wetlands

WPA Form 3 – Notice of Intent

Massachusetts Wetlands Protection Act M.G.L. c. 131, §40

Provided by MassDEP:
MassDEP File Number
Document Transaction Number
Sudbury
City/Town

A. General Information (continued)

6. General Project Description:

Removal by crane 16 dangerous trees from URA (SWAB) and or 100' Buffer Zone only. No work within wetlands. No wetlands impact. The work was accomplished under an emergency order of conditions last week after a tree fall that nearly hit the house.

7a. Project Type Checklist: (Limited Project Types see Section A. 7b.)

- 1. Single Family Home
- 2. Residential Subdivision
- 3. Commercial/Industrial
- 4. Dock/Pier
- 5. Utilities
- 6. Coastal engineering Structure
- 7. Agriculture (e.g., cranberries, forestry)
- 8. Transportation
- 9. Other

7b. Is any portion of the proposed activity eligible to be treated as a limited project (including Ecological Restoration Limited Project) subject to 310 CMR 10.24 (coastal) or 310 CMR 10.53 (inland)?

- 1. Yes No If yes, describe which limited project applies to this project. (See 310 CMR 10.24 and 10.53 for a complete list and description of limited project types)

2. Limited Project Type

If the proposed activity is eligible to be treated as an Ecological Restoration Limited Project (310 CMR10.24(8), 310 CMR 10.53(4)), complete and attach Appendix A: Ecological Restoration Limited Project Checklist and Signed Certification.

8. Property recorded at the Registry of Deeds for:

Middlesex	_____	_____
a. County		b. Certificate # (if registered land)
88035	_____	439
c. Book		d. Page Number

B. Buffer Zone & Resource Area Impacts (temporary & permanent)

- 1. Buffer Zone Only – Check if the project is located only in the Buffer Zone of a Bordering Vegetated Wetland, Inland Bank, or Coastal Resource Area.
- 2. Inland Resource Areas (see 310 CMR 10.54-10.58; if not applicable, go to Section B.3, Coastal Resource Areas).

Check all that apply below. Attach narrative and any supporting documentation describing how the project will meet all performance standards for each of the resource areas altered, including standards requiring consideration of alternative project design or location.



Massachusetts Department of Environmental Protection
Bureau of Resource Protection - Wetlands

WPA Form 3 – Notice of Intent

Massachusetts Wetlands Protection Act M.G.L. c. 131, §40

Provided by MassDEP:

MassDEP File Number

Document Transaction Number

Sudbury

City/Town

B. Buffer Zone & Resource Area Impacts (temporary & permanent) (cont'd)

For all projects affecting other Resource Areas, please attach a narrative explaining how the resource area was delineated.

Resource Area	Size of Proposed Alteration	Proposed Replacement (if any)
a. <input type="checkbox"/> Bank	1. linear feet	2. linear feet
b. <input type="checkbox"/> Bordering Vegetated Wetland	1. square feet	2. square feet
c. <input type="checkbox"/> Land Under Waterbodies and Waterways	1. square feet	2. square feet
	3. cubic yards dredged	

Resource Area	Size of Proposed Alteration	Proposed Replacement (if any)
d. <input type="checkbox"/> Bordering Land Subject to Flooding	1. square feet	2. square feet
	3. cubic feet of flood storage lost	4. cubic feet replaced
e. <input type="checkbox"/> Isolated Land Subject to Flooding	1. square feet	
	2. cubic feet of flood storage lost	3. cubic feet replaced
f. <input type="checkbox"/> Riverfront Area	NA	
	1. Name of Waterway (if available) - specify coastal or inland	

2. Width of Riverfront Area (check one):

- 25 ft. - Designated Densely Developed Areas only
- 100 ft. - New agricultural projects only
- 200 ft. - All other projects

3. Total area of Riverfront Area on the site of the proposed project: 0000 square feet

4. Proposed alteration of the Riverfront Area:

0000 a. total square feet 0000 b. square feet within 100 ft. 0000 c. square feet between 100 ft. and 200 ft.

5. Has an alternatives analysis been done and is it attached to this NOI? Yes No

6. Was the lot where the activity is proposed created prior to August 1, 1996? Yes No

3. Coastal Resource Areas: (See 310 CMR 10.25-10.35)

Note: for coastal riverfront areas, please complete **Section B.2.f.** above.



Massachusetts Department of Environmental Protection
Bureau of Resource Protection - Wetlands

WPA Form 3 – Notice of Intent

Massachusetts Wetlands Protection Act M.G.L. c. 131, §40

Provided by MassDEP:

MassDEP File Number

Document Transaction Number

Sudbury

City/Town

B. Buffer Zone & Resource Area Impacts (temporary & permanent) (cont'd)

Check all that apply below. Attach narrative and supporting documentation describing how the project will meet all performance standards for each of the resource areas altered, including standards requiring consideration of alternative project design or location.

Online Users:
Include your document transaction number (provided on your receipt page) with all supplementary information you submit to the Department.

<u>Resource Area</u>	<u>Size of Proposed Alteration</u>	<u>Proposed Replacement (if any)</u>
a. <input type="checkbox"/> Designated Port Areas	Indicate size under Land Under the Ocean, below	
b. <input type="checkbox"/> Land Under the Ocean	_____	
	1. square feet	

	2. cubic yards dredged	
c. <input type="checkbox"/> Barrier Beach	Indicate size under Coastal Beaches and/or Coastal Dunes below	
d. <input type="checkbox"/> Coastal Beaches	_____	_____
	1. square feet	2. cubic yards beach nourishment
e. <input type="checkbox"/> Coastal Dunes	_____	_____
	1. square feet	2. cubic yards dune nourishment
	<u>Size of Proposed Alteration</u>	<u>Proposed Replacement (if any)</u>
f. <input type="checkbox"/> Coastal Banks	_____	
	1. linear feet	
g. <input type="checkbox"/> Rocky Intertidal Shores	_____	
	1. square feet	
h. <input type="checkbox"/> Salt Marshes	_____	_____
	1. square feet	2. sq ft restoration, rehab., creation
i. <input type="checkbox"/> Land Under Salt Ponds	_____	
	1. square feet	

	2. cubic yards dredged	
j. <input type="checkbox"/> Land Containing Shellfish	_____	
	1. square feet	
k. <input type="checkbox"/> Fish Runs	Indicate size under Coastal Banks, inland Bank, Land Under the Ocean, and/or inland Land Under Waterbodies and Waterways, above	

	1. cubic yards dredged	
l. <input type="checkbox"/> Land Subject to Coastal Storm Flowage	_____	
	1. square feet	
4. <input type="checkbox"/> Restoration/Enhancement	If the project is for the purpose of restoring or enhancing a wetland resource area in addition to the square footage that has been entered in Section B.2.b or B.3.h above, please enter the additional amount here.	
	_____	_____
	a. square feet of BVW	b. square feet of Salt Marsh
5. <input type="checkbox"/> Project Involves Stream Crossings	NO	
	_____	_____
	a. number of new stream crossings	b. number of replacement stream crossings



Massachusetts Department of Environmental Protection
Bureau of Resource Protection - Wetlands

WPA Form 3 – Notice of Intent

Massachusetts Wetlands Protection Act M.G.L. c. 131, §40

Provided by MassDEP:

MassDEP File Number

Document Transaction Number

Sudbury

City/Town

C. Other Applicable Standards and Requirements

- This is a proposal for an Ecological Restoration Limited Project. Skip Section C and complete Appendix A: Ecological Restoration Limited Project Checklists – Required Actions (310 CMR 10.11).

Streamlined Massachusetts Endangered Species Act/Wetlands Protection Act Review

1. Is any portion of the proposed project located in **Estimated Habitat of Rare Wildlife** as indicated on the most recent Estimated Habitat Map of State-Listed Rare Wetland Wildlife published by the Natural Heritage and Endangered Species Program (NHESP)? To view habitat maps, see the *Massachusetts Natural Heritage Atlas* or go to http://maps.massgis.state.ma.us/PRI_EST_HAB/viewer.htm.

- a. Yes No **If yes, include proof of mailing or hand delivery of NOI to:**

**Natural Heritage and Endangered Species Program
Division of Fisheries and Wildlife
1 Rabbit Hill Road
Westborough, MA 01581**

- 2018 and GIS
b. Date of map _____

If yes, the project is also subject to Massachusetts Endangered Species Act (MESA) review (321 CMR 10.18). To qualify for a streamlined, 30-day, MESA/Wetlands Protection Act review, please complete Section C.1.c, and include requested materials with this Notice of Intent (NOI); *OR* complete Section C.2.f, if applicable. *If MESA supplemental information is not included with the NOI, by completing Section 1 of this form, the NHESP will require a separate MESA filing which may take up to 90 days to review (unless noted exceptions in Section 2 apply, see below).*

- c. Submit Supplemental Information for Endangered Species Review*

1. Percentage/acreage of property to be altered:
 - (a) within wetland Resource Area _____ percentage/acreage
 - (b) outside Resource Area _____ percentage/acreage

2. Assessor's Map or right-of-way plan of site

2. Project plans for entire project site, including wetland resource areas and areas outside of wetlands jurisdiction, showing existing and proposed conditions, existing and proposed tree/vegetation clearing line, and clearly demarcated limits of work **
 - (a) Project description (including description of impacts outside of wetland resource area & buffer zone)
 - (b) Photographs representative of the site

* Some projects **not** in Estimated Habitat may be located in Priority Habitat, and require NHESP review (see <http://www.mass.gov/eea/agencies/dfg/dfw/natural-heritage/regulatory-review/>). Priority Habitat includes habitat for state-listed plants and strictly upland species not protected by the Wetlands Protection Act.

** MESA projects may not be segmented (321 CMR 10.16). The applicant must disclose full development plans even if such plans are not required as part of the Notice of Intent process.



Massachusetts Department of Environmental Protection
Bureau of Resource Protection - Wetlands

WPA Form 3 – Notice of Intent

Massachusetts Wetlands Protection Act M.G.L. c. 131, §40

Provided by MassDEP:

MassDEP File Number

Document Transaction Number

Sudbury

City/Town

C. Other Applicable Standards and Requirements (cont'd)

(c) MESA filing fee (fee information available at http://www.mass.gov/dfwele/dfw/nhesp/regulatory_review/mesa/mesa_fee_schedule.htm).
Make check payable to "Commonwealth of Massachusetts - NHESP" and **mail to NHESP** at above address

Projects altering 10 or more acres of land, also submit:

(d) Vegetation cover type map of site

(e) Project plans showing Priority & Estimated Habitat boundaries

(f) OR Check One of the Following

1. Project is exempt from MESA review.
Attach applicant letter indicating which MESA exemption applies. (See 321 CMR 10.14, http://www.mass.gov/dfwele/dfw/nhesp/regulatory_review/mesa/mesa_exemptions.htm; the NOI must still be sent to NHESP if the project is within estimated habitat pursuant to 310 CMR 10.37 and 10.59.)

2. Separate MESA review ongoing. a. NHESP Tracking # _____ b. Date submitted to NHESP _____

3. Separate MESA review completed.
Include copy of NHESP "no Take" determination or valid Conservation & Management Permit with approved plan.

3. For coastal projects only, is any portion of the proposed project located below the mean high water line or in a fish run?

a. Not applicable – project is in inland resource area only b. Yes No

If yes, include proof of mailing, hand delivery, or electronic delivery of NOI to either:

South Shore - Cohasset to Rhode Island border, and the Cape & Islands:

Division of Marine Fisheries -
Southeast Marine Fisheries Station
Attn: Environmental Reviewer
836 South Rodney French Blvd.
New Bedford, MA 02744
Email: DMF.EnvReview-South@state.ma.us

North Shore - Hull to New Hampshire border:

Division of Marine Fisheries -
North Shore Office
Attn: Environmental Reviewer
30 Emerson Avenue
Gloucester, MA 01930
Email: DMF.EnvReview-North@state.ma.us

Also if yes, the project may require a Chapter 91 license. For coastal towns in the Northeast Region, please contact MassDEP's Boston Office. For coastal towns in the Southeast Region, please contact MassDEP's Southeast Regional Office.



Massachusetts Department of Environmental Protection
Bureau of Resource Protection - Wetlands

WPA Form 3 – Notice of Intent

Massachusetts Wetlands Protection Act M.G.L. c. 131, §40

Provided by MassDEP:

MassDEP File Number

Document Transaction Number

Sudbury

City/Town

C. Other Applicable Standards and Requirements (cont'd)

Online Users:
Include your document transaction number (provided on your receipt page) with all supplementary information you submit to the Department.

- 4. Is any portion of the proposed project within an Area of Critical Environmental Concern (ACEC)?
 a. Yes No If yes, provide name of ACEC (see instructions to WPA Form 3 or MassDEP Website for ACEC locations). **Note:** electronic filers click on Website.
 b. ACEC
- 5. Is any portion of the proposed project within an area designated as an Outstanding Resource Water (ORW) as designated in the Massachusetts Surface Water Quality Standards, 314 CMR 4.00?
 a. Yes No
- 6. Is any portion of the site subject to a Wetlands Restriction Order under the Inland Wetlands Restriction Act (M.G.L. c. 131, § 40A) or the Coastal Wetlands Restriction Act (M.G.L. c. 130, § 105)?
 a. Yes No
- 7. Is this project subject to provisions of the MassDEP Stormwater Management Standards?
 a. Yes. Attach a copy of the Stormwater Report as required by the Stormwater Management Standards per 310 CMR 10.05(6)(k)-(q) and check if:
 - 1. Applying for Low Impact Development (LID) site design credits (as described in Stormwater Management Handbook Vol. 2, Chapter 3)
 - 2. A portion of the site constitutes redevelopment
 - 3. Proprietary BMPs are included in the Stormwater Management System.
 b. No. Check why the project is exempt:
 - 1. Single-family house
 - 2. Emergency road repair
 - 3. Small Residential Subdivision (less than or equal to 4 single-family houses or less than or equal to 4 units in multi-family housing project) with no discharge to Critical Areas.

D. Additional Information

- This is a proposal for an Ecological Restoration Limited Project. Skip Section D and complete Appendix A: Ecological Restoration Notice of Intent – Minimum Required Documents (310 CMR 10.12).

Applicants must include the following with this Notice of Intent (NOI). See instructions for details.

Online Users: Attach the document transaction number (provided on your receipt page) for any of the following information you submit to the Department.

- 1. USGS or other map of the area (along with a narrative description, if necessary) containing sufficient information for the Conservation Commission and the Department to locate the site. (Electronic filers may omit this item.)
- 2. Plans identifying the location of proposed activities (including activities proposed to serve as a Bordering Vegetated Wetland [BVW] replication area or other mitigating measure) relative to the boundaries of each affected resource area.



Massachusetts Department of Environmental Protection
Bureau of Resource Protection - Wetlands

WPA Form 3 – Notice of Intent

Massachusetts Wetlands Protection Act M.G.L. c. 131, §40

Provided by MassDEP:

MassDEP File Number

Document Transaction Number

Sudbury

City/Town

D. Additional Information (cont'd)

3. Identify the method for BVW and other resource area boundary delineations (MassDEP BVW Field Data Form(s), Determination of Applicability, Order of Resource Area Delineation, etc.), and attach documentation of the methodology.

4. List the titles and dates for all plans and other materials submitted with this NOI.

33 Maynard Rd Wetlands Restoration

a. Plan Title

Josh Hasenfus

Josh Hasenfus (Drawing)

b. Prepared By

c. Signed and Stamped by

11-18-10

d. Final Revision Date

e. Scale

GIS map USGS map

f. Additional Plan or Document Title

g. Date

5. If there is more than one property owner, please attach a list of these property owners not listed on this form.

6. Attach proof of mailing for Natural Heritage and Endangered Species Program, if needed.

7. Attach proof of mailing for Massachusetts Division of Marine Fisheries, if needed.

8. Attach NOI Wetland Fee Transmittal Form

9. Attach Stormwater Report, if needed.

E. Fees

1. Fee Exempt: No filing fee shall be assessed for projects of any city, town, county, or district of the Commonwealth, federally recognized Indian tribe housing authority, municipal housing authority, or the Massachusetts Bay Transportation Authority.

Applicants must submit the following information (in addition to pages 1 and 2 of the NOI Wetland Fee Transmittal Form) to confirm fee payment:

2. Municipal Check Number	5-26-20
	3. Check date
4. State Check Number	5-26-20
	5. Check date
David	Burke
6. Payor name on check: First Name	7. Payor name on check: Last Name

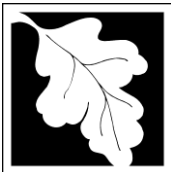

Massachusetts Department of Environmental Protection
Bureau of Resource Protection - Wetlands

WPA Form 3 – Notice of Intent

Massachusetts Wetlands Protection Act M.G.L. c. 131, §40

Provided by MassDEP:
MassDEP File Number
Document Transaction Number
Sudbury
City/Town

F. Signatures and Submittal Requirements

I hereby certify under the penalties of perjury that the foregoing Notice of Intent and accompanying plans, documents, and supporting data are true and complete to the best of my knowledge. I understand that the Conservation Commission will place notification of this Notice in a local newspaper at the expense of the applicant in accordance with the wetlands regulations, 310 CMR 10.05(5)(a).

I further certify under penalties of perjury that all abutters were notified of this application, pursuant to the requirements of M.G.L. c. 131, § 40. Notice must be made by Certificate of Mailing or in writing by hand delivery or certified mail (return receipt requested) to all abutters within 100 feet of the property line of the project location.

_____	5-26-20
1. Signature of Applicant	2. Date
_____	5-26-20
3. Signature of Property Owner (if different)	4. Date
_____	5-26-20
5. Signature of Representative (if any)	6. Date

For Conservation Commission:

Two copies of the completed Notice of Intent (Form 3), including supporting plans and documents, two copies of the NOI Wetland Fee Transmittal Form, and the city/town fee payment, to the Conservation Commission by certified mail or hand delivery.

For MassDEP:

One copy of the completed Notice of Intent (Form 3), including supporting plans and documents, one copy of the NOI Wetland Fee Transmittal Form, and a **copy** of the state fee payment to the MassDEP Regional Office (see Instructions) by certified mail or hand delivery.

Other:

If the applicant has checked the "yes" box in any part of Section C, Item 3, above, refer to that section and the Instructions for additional submittal requirements.

The original and copies must be sent simultaneously. Failure by the applicant to send copies in a timely manner may result in dismissal of the Notice of Intent.



Massachusetts Department of Environmental Protection
 Bureau of Resource Protection - Wetlands
NOI Wetland Fee Transmittal Form
 Massachusetts Wetlands Protection Act M.G.L. c. 131, §40

Important: When filling out forms on the computer, use only the tab key to move your cursor - do not use the return key.

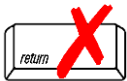

A. Applicant Information

1. Location of Project:

<u>33 Maynard Rd</u>	<u>Sudbury</u>
a. Street Address	b. City/Town
<u>1305</u>	<u>42.50</u>
c. Check number	d. Fee amount

2. Applicant Mailing Address:

<u>Evan</u>	<u>Kyparissoudas</u>	
a. First Name	b. Last Name	
<u>OWNER</u>		
c. Organization		
<u>33 Maynard Rd</u>		
d. Mailing Address		
<u>Sudbury</u>	<u>MA</u>	<u>01776</u>
e. City/Town	f. State	g. Zip Code
<u>617-816-5093</u>	<u>fullercorp@gmail.com</u>	
h. Phone Number	i. Fax Number	j. Email Address

3. Property Owner (if different):

<u>SAME</u>		
a. First Name	b. Last Name	

c. Organization		

d. Mailing Address		

<u></u>	<u></u>	<u></u>
e. City/Town	f. State	g. Zip Code
<u></u>	<u></u>	<u></u>
h. Phone Number	i. Fax Number	j. Email Address

B. Fees

Fee should be calculated using the following process & worksheet. **Please see Instructions before filling out worksheet.**

Step 1/Type of Activity: Describe each type of activity that will occur in wetland resource area and buffer zone.

Step 2/Number of Activities: Identify the number of each type of activity.

Step 3/Individual Activity Fee: Identify each activity fee from the six project categories listed in the instructions.

Step 4/Subtotal Activity Fee: Multiply the number of activities (identified in Step 2) times the fee per category (identified in Step 3) to reach a subtotal fee amount. Note: If any of these activities are in a Riverfront Area in addition to another Resource Area or the Buffer Zone, the fee per activity should be multiplied by 1.5 and then added to the subtotal amount.

Step 5/Total Project Fee: Determine the total project fee by adding the subtotal amounts from Step 4.

Step 6/Fee Payments: To calculate the state share of the fee, divide the total fee in half and subtract \$12.50. To calculate the city/town share of the fee, divide the total fee in half and add \$12.50.

To calculate filing fees, refer to the category fee list and examples in the instructions for filling out WPA Form 3 (Notice of Intent).

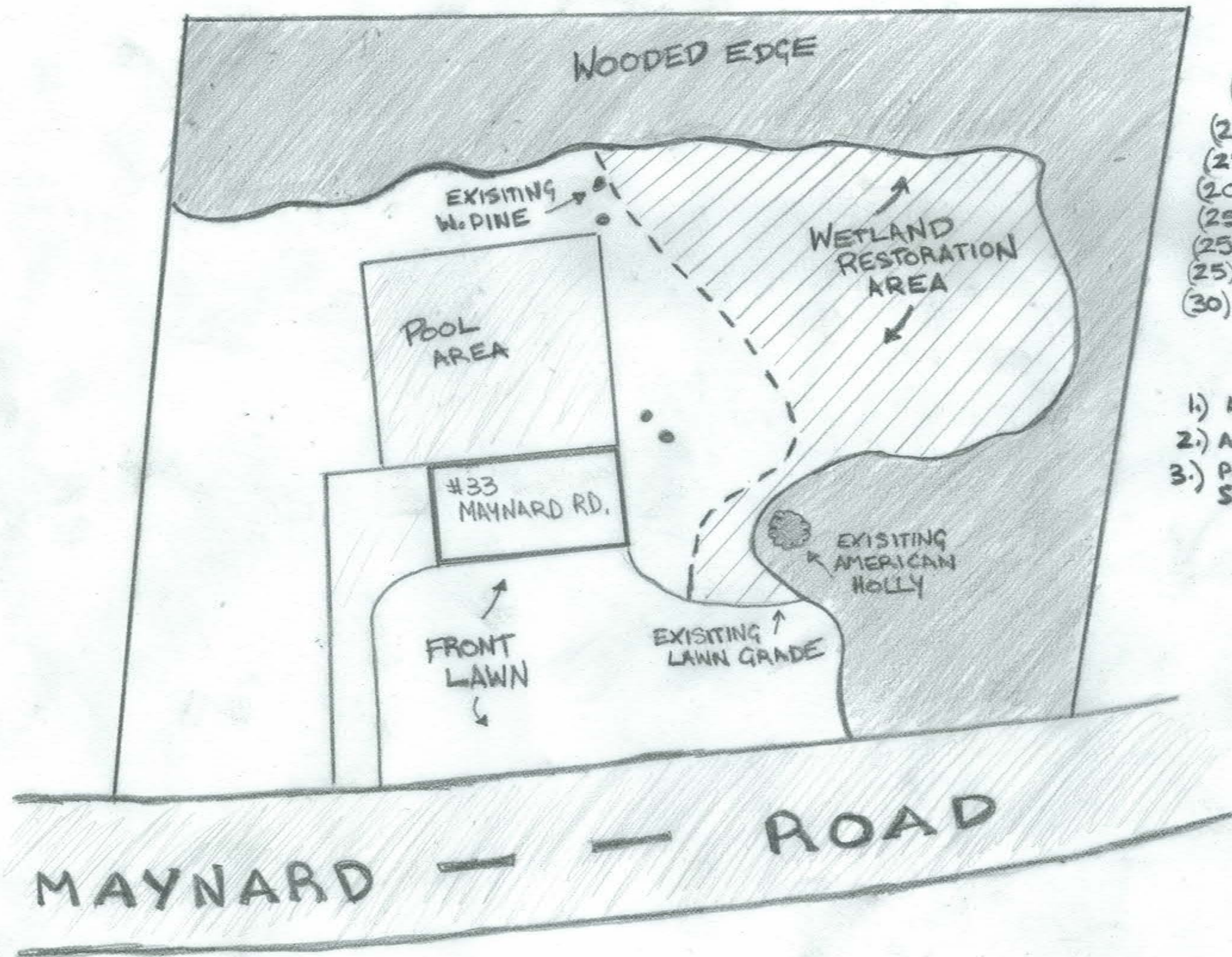

PLANT LIST:

- (3) ACER RUBRUM, RED MAPLE 5-GAL.
- (20) CORNUS ANOMUM, SILKY DOGWOOD 1-GAL.
- (25) CORNUS SERICEA, RED DOGWOOD 1-GAL.
- (20) VIBURNUM DENTATUM, ARROWWOOD 1-GAL.
- (25) CLETHRA ALNIFOLIA, SUMMERSWEET 1-GAL.
- (25) VACCINIUM CORYMBOSUM, BLUEBERRY 1-GAL.
- (25) LINDERA BENZOIN, SPICEBUSH 1-GAL.
- (30) ILEX VERTICILLATA, WINTERBERRY 1-GAL.

NOTES:

- 1.) ALL PLANTS TO BE PLANTED APPROX. 6' O.C.
- 2.) ALL PLANTS TO BE CONTAINER GROWN.
- 3.) PLANTS TO BE INSTALLED IN GROUPINGS OF SAME SPECIES.

33 MAYNARD RD.
WETLAND RESTORATION
JOSH HASENFUS

116 TAUNTON ST. PLAINVILLE
508.954.4096

11-18-10 DRAWN: JH



**NOTICE OF PUBLIC HEARING
SUDBURY CONSERVATION COMMISSION
VIRTUAL MEETING**

The Sudbury Conservation Commission will hold a public hearing to review the Notice of Intent filing, under the State Act and local Wetland Bylaw to remove 16 damaged/dangerous trees within the 100-foot Buffer Zone at 33 Maynard Road, in Sudbury, MA., Evan Kyparissoudas, applicant. The hearing will be held on Monday, June 15, 2020 at 6:30 pm, via remote participation (<https://us02web.zoom.us/j/368460001> is the link to join this Hearing via Zoom). Copies of the application may be reviewed on the Conservation Department web page at; <https://sudbury.ma.us/conservationcommission/meeting/conservation-commission-meeting-monday-june-15-2020/>

Please contact the Conservation Office with any questions at 978-440-5470.

SUDBURY CONSERVATION COMMISSION
June 1, 2020