

Town of Sudbury

Conservation Commission

275 Old Lancaster Rd.
Sudbury, MA 01776
Tel: 978-440-5471
ConCom@sudbury.ma.us

Sudbury Community Garden Application



Name: _____ Phone: _____

Address: _____ Email: _____

Total Number of Plots (30' x 30') Desired: _____

Organic Section _____ Inorganic Section _____ Perennial Section _____

Do you want the same plot you had last year if possible? Please enter the plot #. _____

If not, do you have a plot preference? _____

* Please refer to the attached garden plot plan for the letter/number designation.

I/We agree to abide by the rules and regulations governing the use of the Community Garden sites and hereby release and covenant to hold harmless the town of Sudbury, its agents, contractors, and employees, of and from any and all actions, claims and damages for personal inquiries and disabilities or damages to property or produce that I/we may sustain and may incur as a result of my/our participations in the Community Garden project.

Signature(s): _____ Dated: _____

I/WE WILL BE WILLING TO HELP (phoning and/or e-mailing; staking; assigning plots; clerical help; planning a harvest party)

FEES: \$20 per plot; \$2 per key.

Make checks payable to: **Sudbury Community Gardens**

Mail Application and check to: **Heather Lambert**
19 Autumn Street
Sudbury, MA 01776

CART PATH

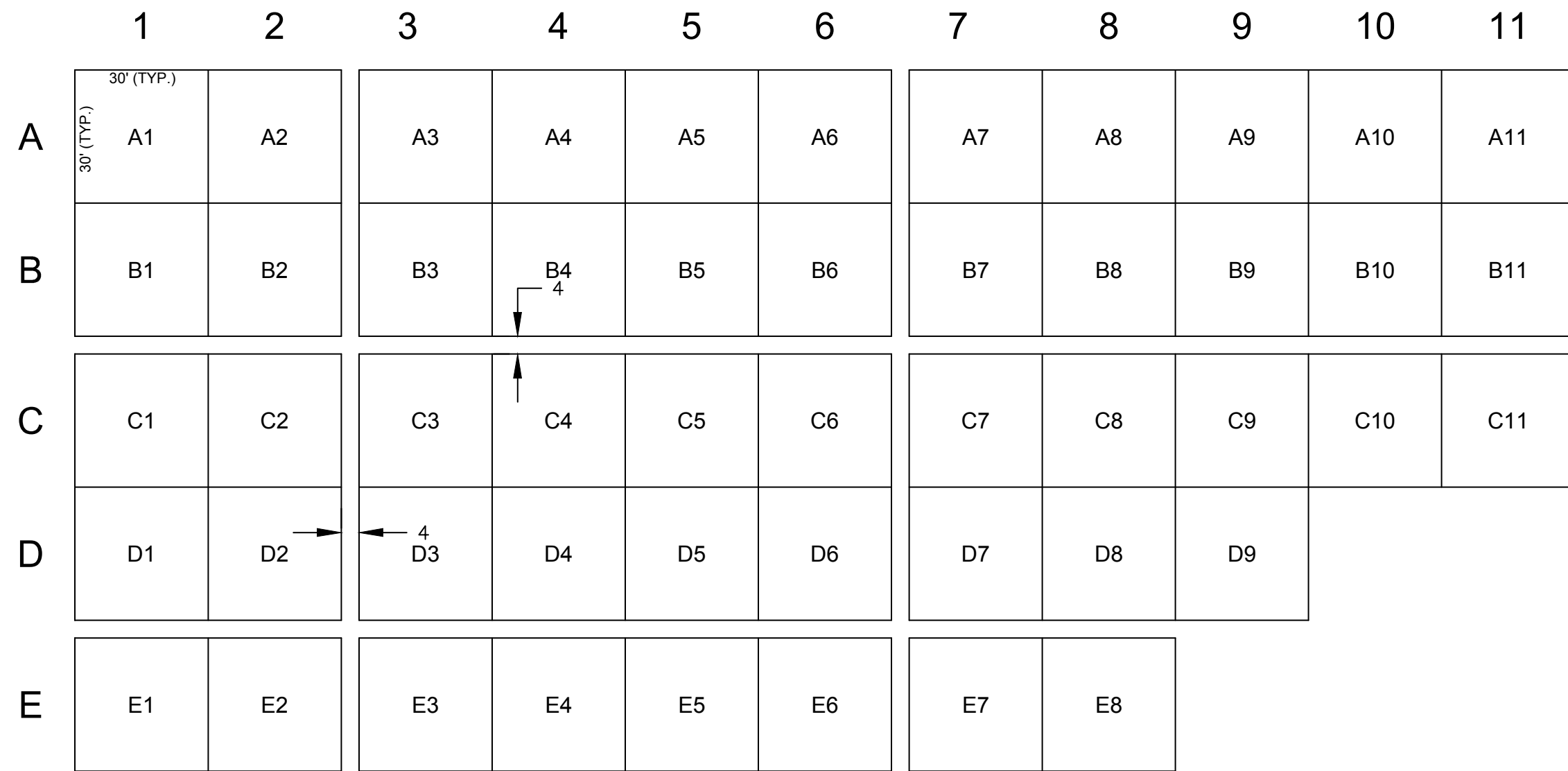

PERRENNIAL BEDS AVAILABLE IN COLUMN 1 AND ROW E

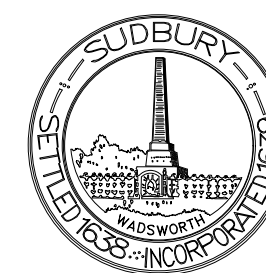
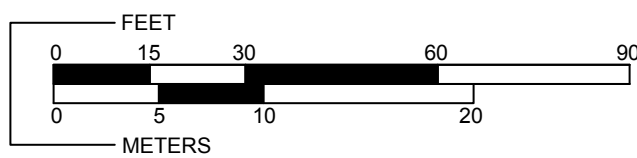
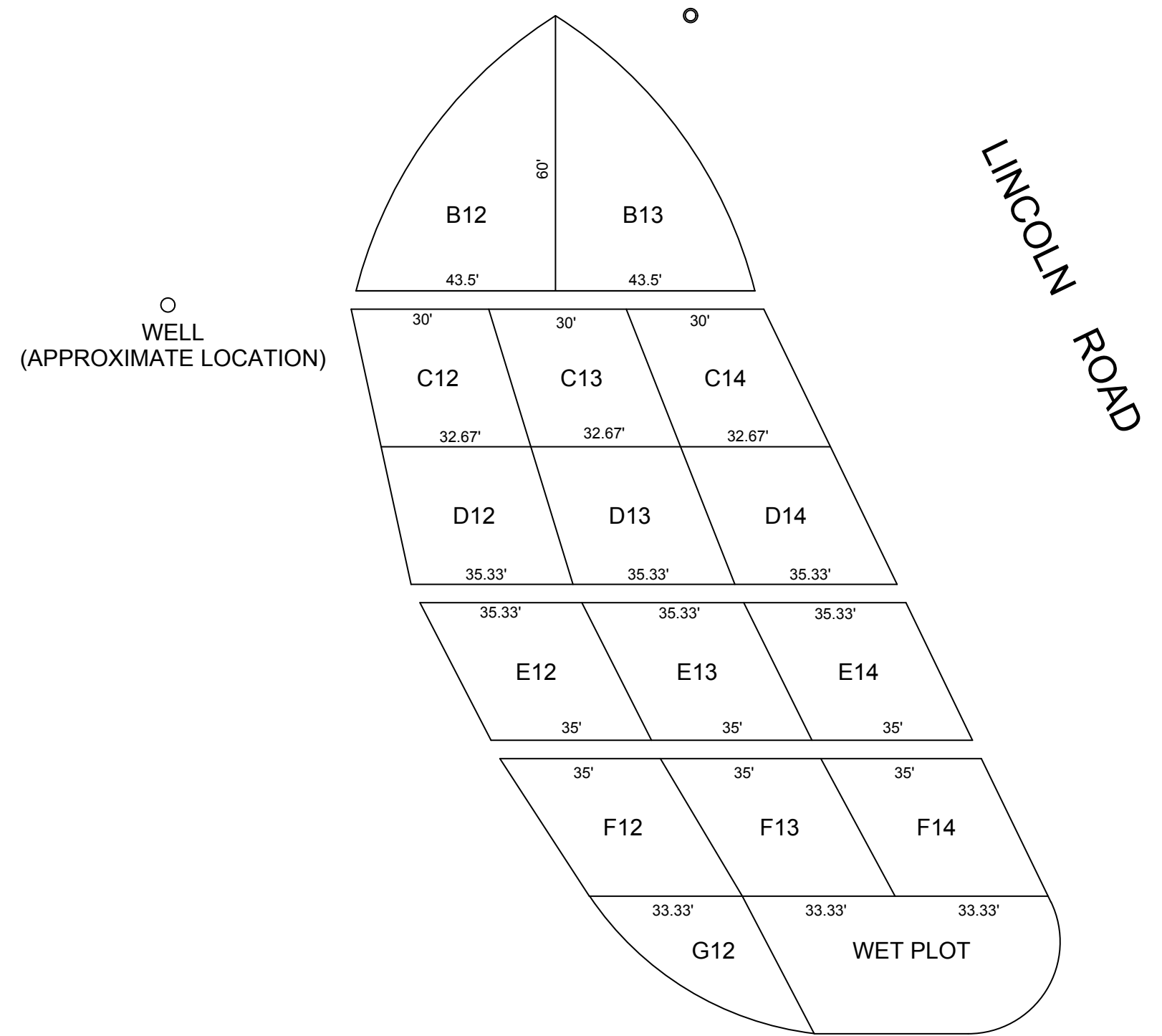
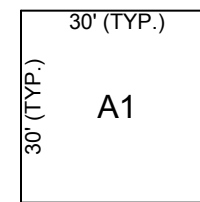

SUDBURY COMMUNITY GARDENS
 OPERATED BY
 THE SUDBURY CONSERVATION COMMISSION
 AT THE
 LINCOLN MEADOWS CONSERVATION RESERVATION
 LINCOLN ROAD SUDBURY, MA.

TOWN OF SUDBURY ENGINEERING DEPARTMENT
 DATE: APRIL 18, 2012 SCALE: 1IN.=30FT.