

Received

JUL 09 2019

Sudbury Conservation Department

Trina Baker

Curvin Huber

79 Bent Rd.

Sudbury, MA 01776

Cell: 570-594-1682

Dear Sudbury Conservation Commission,

We are contacting the Commission to file a Notice of Intent for the removal of six pine trees located on the perimeter of our house. These pines range in height from 60' to 70' and pose a risk for collapse onto the house giving the increase in micro-burst intensity. The pines under consideration for removal had been included in a previous site evaluation on 12/11/2018 conducted by the Arborist Thomas Greco, MCA#1808. A copy of this evaluation is included as Item 2. Seventeen trees had been identified as posing a potential risk to the house.

Following that site evaluation, the Sudbury Conservation Commission conducted a site visit and determined that six of the seventeen trees posed an eminent threat to the house. These six trees were subsequently removed the following week. We are requesting the Conservation Commission's approval to remove an additional six pine trees that had been included in the original Arborist site evaluation. Item A provides layouts showing the location of the pine trees in relation to the house.

It is our goal to implement a replanting plan that exceeds any benefits the current pine trees in question provide. All six trees are located on the edge of our current lawn. We will replace the removed trees with white Paper Birch, Red Twig Dogwood, Eastern Red Cedar, and Pink Koussa & Cherokee Princess Dogwoods. This will provide low and mid-height protection for the conservation areas located behind where the removed trees are located.

Thank you for your time and consideration.

Sincerely,



Trina Baker



Curvin Huber

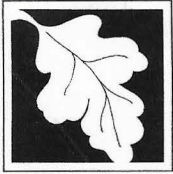

Massachusetts Department of Environmental Protection
Bureau of Resource Protection - Wetlands

WPA Form 3 – Notice of Intent

Massachusetts Wetlands Protection Act M.G.L. c. 131, §40

Provided by MassDEP:

MassDEP File Number

Document Transaction Number

City/Town

Important:
When filling out forms on the computer, use only the tab key to move your cursor - do not use the return key.



Note:
Before completing this form consult your local Conservation Commission regarding any municipal bylaw or ordinance.

A. General Information

1. Project Location (**Note:** electronic filers will click on button to locate project site):

| | | |
|------------------------------|-----------------------|--------------|
| 79 Bent Rd | Sudbury | 01776 |
| a. Street Address | b. City/Town | c. Zip Code |
| Latitude and Longitude: | 42.367110 | -71.447300 |
| | d. Latitude | e. Longitude |
| 305 | 0314 | |
| f. Assessors Map/Plat Number | g. Parcel /Lot Number | |

2. Applicant:

| | |
|---------------------|-------------------|
| Catriona and Curvin | Baker and Huber |
| a. First Name | b. Last Name |
| None | |
| c. Organization | |
| 79 Bent Rd | |
| d. Street Address | |
| Sudbury | MA |
| e. City/Town | f. State |
| 570-594-1682 | 01776 |
| h. Phone Number | g. Zip Code |
| i. Fax Number | 3dsmaya@gmail.com |
| | j. Email Address |

3. Property owner (required if different from applicant): ☐ Check if more than one owner

| | |
|-------------------|------------------|
| a. First Name | b. Last Name |
| | |
| c. Organization | |
| d. Street Address | |
| e. City/Town | f. State |
| | g. Zip Code |
| h. Phone Number | i. Fax Number |
| | j. Email address |

4. Representative (if any):

| | |
|-------------------|------------------|
| a. First Name | b. Last Name |
| | |
| c. Company | |
| d. Street Address | |
| e. City/Town | f. State |
| | g. Zip Code |
| h. Phone Number | i. Fax Number |
| | j. Email address |

5. Total WPA Fee Paid (from NOI Wetland Fee Transmittal Form):

| | | |
|-------------------|-------------------|-----------------------|
| 165.00 | 70.00 | 95.00 |
| a. Total Fee Paid | b. State Fee Paid | c. City/Town Fee Paid |

Received
JUL 09 2019
Sudbury Conservation Department



Massachusetts Department of Environmental Protection
Bureau of Resource Protection - Wetlands

Provided by MassDEP:

WPA Form 3 – Notice of Intent

Massachusetts Wetlands Protection Act M.G.L. c. 131, §40

MassDEP File Number

Document Transaction Number

City/Town

A. General Information (continued)

6. General Project Description:

We would like to remove six pine trees around the parimeter of the yard for safety concerns.

7a. Project Type Checklist: (Limited Project Types see Section A. 7b.)

- | | |
|---|---|
| 1. <input checked="" type="checkbox"/> Single Family Home | 2. <input type="checkbox"/> Residential Subdivision |
| 3. <input type="checkbox"/> Commercial/Industrial | 4. <input type="checkbox"/> Dock/Pier |
| 5. <input type="checkbox"/> Utilities | 6. <input type="checkbox"/> Coastal engineering Structure |
| 7. <input type="checkbox"/> Agriculture (e.g., cranberries, forestry) | 8. <input type="checkbox"/> Transportation |
| 9. <input type="checkbox"/> Other | |

7b. Is any portion of the proposed activity eligible to be treated as a limited project (including Ecological Restoration Limited Project) subject to 310 CMR 10.24 (coastal) or 310 CMR 10.53 (inland)?

1. ☐ Yes ☒ No If yes, describe which limited project applies to this project. (See 310 CMR 10.24 and 10.53 for a complete list and description of limited project types)

2. Limited Project Type

If the proposed activity is eligible to be treated as an Ecological Restoration Limited Project (310 CMR10.24(8), 310 CMR 10.53(4)), complete and attach Appendix A: Ecological Restoration Limited Project Checklist and Signed Certification.

8. Property recorded at the Registry of Deeds for:

Middlesex South

a. County

~~26535~~ 71544

c. Book

b. Certificate # (if registered land)

~~185~~ 414

d. Page Number

B. Buffer Zone & Resource Area Impacts (temporary & permanent)

- ☐ Buffer Zone Only – Check if the project is located only in the Buffer Zone of a Bordering Vegetated Wetland, Inland Bank, or Coastal Resource Area.
- ☐ Inland Resource Areas (see 310 CMR 10.54-10.58; if not applicable, go to Section B.3, Coastal Resource Areas).

Check all that apply below. Attach narrative and any supporting documentation describing how the project will meet all performance standards for each of the resource areas altered, including standards requiring consideration of alternative project design or location.



Massachusetts Department of Environmental Protection
Bureau of Resource Protection - Wetlands

WPA Form 3 – Notice of Intent

Massachusetts Wetlands Protection Act M.G.L. c. 131, §40

Provided by MassDEP:

MassDEP File Number

Document Transaction Number

City/Town

B. Buffer Zone & Resource Area Impacts (temporary & permanent) (cont'd)

For all projects affecting other Resource Areas, please attach a narrative explaining how the resource area was delineated.

| Resource Area | Size of Proposed Alteration | Proposed Replacement (if any) |
|--|--|-------------------------------|
| a. <input type="checkbox"/> Bank | 1. linear feet | 2. linear feet |
| b. <input type="checkbox"/> Bordering Vegetated Wetland | 1. square feet | 2. square feet |
| c. <input type="checkbox"/> Land Under Waterbodies and Waterways | 1. square feet 3. cubic yards dredged | 2. square feet |

| Resource Area | Size of Proposed Alteration | Proposed Replacement (if any) |
|--|---|--|
| d. <input type="checkbox"/> Bordering Land Subject to Flooding | 1. square feet 3. cubic feet of flood storage lost | 2. square feet 4. cubic feet replaced |
| e. <input type="checkbox"/> Isolated Land Subject to Flooding | 1. square feet 2. cubic feet of flood storage lost | 3. cubic feet replaced |
| f. <input checked="" type="checkbox"/> Riverfront Area | <u>Dudley Brook</u> 1. Name of Waterway (if available) - specify coastal or inland | |

2. Width of Riverfront Area (check one):

- ☐ 25 ft. - Designated Densely Developed Areas only
- ☐ 100 ft. - New agricultural projects only
- ☐ 200 ft. - All other projects

3. Total area of Riverfront Area on the site of the proposed project:

227,743
square feet

4. Proposed alteration of the Riverfront Area:

| | | |
|----------------------|-------------------------------|--|
| <u>1000</u> | <u>0</u> | <u>1000</u> |
| a. total square feet | b. square feet within 100 ft. | c. square feet between 100 ft. and 200 ft. |

5. Has an alternatives analysis been done and is it attached to this NOI? ☐ Yes ☐ No

6. Was the lot where the activity is proposed created prior to August 1, 1996? ☐ Yes ☐ No

3. ☐ Coastal Resource Areas: (See 310 CMR 10.25-10.35)

Note: for coastal riverfront areas, please complete **Section B.2.f.** above.

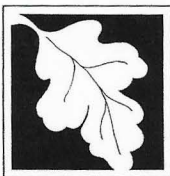

Massachusetts Department of Environmental Protection
Bureau of Resource Protection - Wetlands

WPA Form 3 – Notice of Intent

Massachusetts Wetlands Protection Act M.G.L. c. 131, §40

Provided by MassDEP:

MassDEP File Number

Document Transaction Number

City/Town

B. Buffer Zone & Resource Area Impacts (temporary & permanent) (cont'd)

Check all that apply below. Attach narrative and supporting documentation describing how the project will meet all performance standards for each of the resource areas altered, including standards requiring consideration of alternative project design or location.

Online Users:
Include your document transaction number (provided on your receipt page) with all supplementary information you submit to the Department.

| <u>Resource Area</u> | <u>Size of Proposed Alteration</u> | <u>Proposed Replacement (if any)</u> |
|---|---|--|
| a. <input type="checkbox"/> Designated Port Areas | Indicate size under Land Under the Ocean, below | |
| b. <input type="checkbox"/> Land Under the Ocean | 1. square feet _____ 2. cubic yards dredged _____ | |
| c. <input type="checkbox"/> Barrier Beach | Indicate size under Coastal Beaches and/or Coastal Dunes below | |
| d. <input type="checkbox"/> Coastal Beaches | 1. square feet _____ | 2. cubic yards beach nourishment _____ |
| e. <input type="checkbox"/> Coastal Dunes | 1. square feet _____ | 2. cubic yards dune nourishment _____ |
| | <u>Size of Proposed Alteration</u> | <u>Proposed Replacement (if any)</u> |
| f. <input type="checkbox"/> Coastal Banks | 1. linear feet _____ | |
| g. <input type="checkbox"/> Rocky Intertidal Shores | 1. square feet _____ | |
| h. <input type="checkbox"/> Salt Marshes | 1. square feet _____ | 2. sq ft restoration, rehab., creation _____ |
| i. <input type="checkbox"/> Land Under Salt Ponds | 1. square feet _____ | |
| | 2. cubic yards dredged _____ | |
| j. <input type="checkbox"/> Land Containing Shellfish | 1. square feet _____ | |
| k. <input type="checkbox"/> Fish Runs | Indicate size under Coastal Banks, inland Bank, Land Under the Ocean, and/or inland Land Under Waterbodies and Waterways, above | |
| | 1. cubic yards dredged _____ | |
| l. <input type="checkbox"/> Land Subject to Coastal Storm Flowage | 1. square feet _____ | |

4. ☐ Restoration/Enhancement

If the project is for the purpose of restoring or enhancing a wetland resource area in addition to the square footage that has been entered in Section B.2.b or B.3.h above, please enter the additional amount here.

a. square feet of BVW _____

b. square feet of Salt Marsh _____

5. ☐ Project Involves Stream Crossings

a. number of new stream crossings _____

b. number of replacement stream crossings _____



Massachusetts Department of Environmental Protection
Bureau of Resource Protection - Wetlands

Provided by MassDEP:

WPA Form 3 – Notice of Intent

Massachusetts Wetlands Protection Act M.G.L. c. 131, §40

MassDEP File Number _____

Document Transaction Number _____

City/Town _____

C. Other Applicable Standards and Requirements

- ☐ This is a proposal for an Ecological Restoration Limited Project. Skip Section C and complete Appendix A: Ecological Restoration Limited Project Checklists – Required Actions (310 CMR 10.11).

Streamlined Massachusetts Endangered Species Act/Wetlands Protection Act Review

1. Is any portion of the proposed project located in **Estimated Habitat of Rare Wildlife** as indicated on the most recent Estimated Habitat Map of State-Listed Rare Wetland Wildlife published by the Natural Heritage and Endangered Species Program (NHESP)? To view habitat maps, see the *Massachusetts Natural Heritage Atlas* or go to http://maps.massgis.state.ma.us/PRI_EST_HAB/viewer.htm.

a. ☐ Yes ☒ No

If yes, include proof of mailing or hand delivery of NOI to:

Natural Heritage and Endangered Species Program
Division of Fisheries and Wildlife
1 Rabbit Hill Road
Westborough, MA 01581

b. Date of map _____

If yes, the project is also subject to Massachusetts Endangered Species Act (MESA) review (321 CMR 10.18). To qualify for a streamlined, 30-day, MESA/Wetlands Protection Act review, please complete Section C.1.c, and include requested materials with this Notice of Intent (NOI); *OR* complete Section C.2.f, if applicable. *If MESA supplemental information is not included with the NOI, by completing Section 1 of this form, the NHESP will require a separate MESA filing which may take up to 90 days to review (unless noted exceptions in Section 2 apply, see below).*

- c. Submit Supplemental Information for Endangered Species Review*

1. ☐ Percentage/acreage of property to be altered:

(a) within wetland Resource Area

percentage/acreage _____

(b) outside Resource Area

percentage/acreage _____

2. ☐ Assessor's Map or right-of-way plan of site

2. ☐ Project plans for entire project site, including wetland resource areas and areas outside of wetlands jurisdiction, showing existing and proposed conditions, existing and proposed tree/vegetation clearing line, and clearly demarcated limits of work **

(a) ☐ Project description (including description of impacts outside of wetland resource area & buffer zone)

(b) ☐ Photographs representative of the site

* Some projects **not** in Estimated Habitat may be located in Priority Habitat, and require NHESP review (see <http://www.mass.gov/eea/agencies/dfg/dfw/natural-heritage/regulatory-review/>). Priority Habitat includes habitat for state-listed plants and strictly upland species not protected by the Wetlands Protection Act.

** MESA projects may not be segmented (321 CMR 10.16). The applicant must disclose full development plans even if such plans are not required as part of the Notice of Intent process.



Massachusetts Department of Environmental Protection
Bureau of Resource Protection - Wetlands

WPA Form 3 – Notice of Intent

Massachusetts Wetlands Protection Act M.G.L. c. 131, §40

Provided by MassDEP:

MassDEP File Number

Document Transaction Number

City/Town

C. Other Applicable Standards and Requirements (cont'd)

- (c) ☐ MESA filing fee (fee information available at http://www.mass.gov/dfwele/dfw/nhesp/regulatory_review/mesa/mesa_fee_schedule.htm). Make check payable to "Commonwealth of Massachusetts - NHESP" and **mail to NHESP** at above address

Projects altering 10 or more acres of land, also submit:

- (d) ☐ Vegetation cover type map of site
- (e) ☐ Project plans showing Priority & Estimated Habitat boundaries
- (f) OR Check One of the Following
1. ☐ Project is exempt from MESA review.
Attach applicant letter indicating which MESA exemption applies. (See 321 CMR 10.14, http://www.mass.gov/dfwele/dfw/nhesp/regulatory_review/mesa/mesa_exemptions.htm; the NOI must still be sent to NHESP if the project is within estimated habitat pursuant to 310 CMR 10.37 and 10.59.)
2. ☐ Separate MESA review ongoing. a. NHESP Tracking # _____ b. Date submitted to NHESP _____
3. ☐ Separate MESA review completed.
Include copy of NHESP "no Take" determination or valid Conservation & Management Permit with approved plan.
3. For coastal projects only, is any portion of the proposed project located below the mean high water line or in a fish run?
- a. ☒ Not applicable – project is in inland resource area only b. ☐ Yes ☐ No

If yes, include proof of mailing, hand delivery, or electronic delivery of NOI to either:

South Shore - Cohasset to Rhode Island border, and the Cape & Islands:

Division of Marine Fisheries -
Southeast Marine Fisheries Station
Attn: Environmental Reviewer
836 South Rodney French Blvd.
New Bedford, MA 02744
Email: DMF.EnvReview-South@state.ma.us

North Shore - Hull to New Hampshire border:

Division of Marine Fisheries -
North Shore Office
Attn: Environmental Reviewer
30 Emerson Avenue
Gloucester, MA 01930
Email: DMF.EnvReview-North@state.ma.us

Also if yes, the project may require a Chapter 91 license. For coastal towns in the Northeast Region, please contact MassDEP's Boston Office. For coastal towns in the Southeast Region, please contact MassDEP's Southeast Regional Office.



Massachusetts Department of Environmental Protection
Bureau of Resource Protection - Wetlands

Provided by MassDEP:

WPA Form 3 – Notice of Intent

Massachusetts Wetlands Protection Act M.G.L. c. 131, §40

MassDEP File Number

Document Transaction Number

City/Town

C. Other Applicable Standards and Requirements (cont'd)

Online Users:
Include your document transaction number (provided on your receipt page) with all supplementary information you submit to the Department.

4. Is any portion of the proposed project within an Area of Critical Environmental Concern (ACEC)?
- a. ☐ Yes ☒ No If yes, provide name of ACEC (see instructions to WPA Form 3 or MassDEP Website for ACEC locations). **Note:** electronic filers click on Website.
- b. ACEC
5. Is any portion of the proposed project within an area designated as an Outstanding Resource Water (ORW) as designated in the Massachusetts Surface Water Quality Standards, 314 CMR 4.00?
- a. ☐ Yes ☒ No
6. Is any portion of the site subject to a Wetlands Restriction Order under the Inland Wetlands Restriction Act (M.G.L. c. 131, § 40A) or the Coastal Wetlands Restriction Act (M.G.L. c. 130, § 105)?
- a. ☐ Yes ☒ No
7. Is this project subject to provisions of the MassDEP Stormwater Management Standards?
- a. ☐ Yes. Attach a copy of the Stormwater Report as required by the Stormwater Management Standards per 310 CMR 10.05(6)(k)-(q) and check if:
1. ☐ Applying for Low Impact Development (LID) site design credits (as described in Stormwater Management Handbook Vol. 2, Chapter 3)
 2. ☐ A portion of the site constitutes redevelopment
 3. ☐ Proprietary BMPs are included in the Stormwater Management System.
- b. ☒ No. Check why the project is exempt:
1. ☒ Single-family house
 2. ☐ Emergency road repair
 3. ☐ Small Residential Subdivision (less than or equal to 4 single-family houses or less than or equal to 4 units in multi-family housing project) with no discharge to Critical Areas.

D. Additional Information

- ☐ This is a proposal for an Ecological Restoration Limited Project. Skip Section D and complete Appendix A: Ecological Restoration Notice of Intent – Minimum Required Documents (310 CMR 10.12).

Applicants must include the following with this Notice of Intent (NOI). See instructions for details.

Online Users: Attach the document transaction number (provided on your receipt page) for any of the following information you submit to the Department.

1. ☐ USGS or other map of the area (along with a narrative description, if necessary) containing sufficient information for the Conservation Commission and the Department to locate the site. (Electronic filers may omit this item.)
2. ☐ Plans identifying the location of proposed activities (including activities proposed to serve as a Bordering Vegetated Wetland [BVW] replication area or other mitigating measure) relative to the boundaries of each affected resource area.

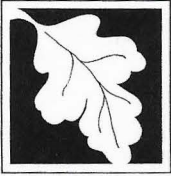

Massachusetts Department of Environmental Protection
Bureau of Resource Protection - Wetlands

WPA Form 3 – Notice of Intent

Massachusetts Wetlands Protection Act M.G.L. c. 131, §40

Provided by MassDEP:

MassDEP File Number

Document Transaction Number

City/Town

D. Additional Information (cont'd)

3. ☐ Identify the method for BVW and other resource area boundary delineations (MassDEP BVW Field Data Form(s), Determination of Applicability, Order of Resource Area Delineation, etc.), and attach documentation of the methodology.

4. ☐ List the titles and dates for all plans and other materials submitted with this NOI.

a. Plan Title

b. Prepared By

d. Final Revision Date

f. Additional Plan or Document Title

c. Signed and Stamped by

e. Scale

g. Date

5. ☐ If there is more than one property owner, please attach a list of these property owners not listed on this form.
6. ☐ Attach proof of mailing for Natural Heritage and Endangered Species Program, if needed.
7. ☐ Attach proof of mailing for Massachusetts Division of Marine Fisheries, if needed.
8. ☒ Attach NOI Wetland Fee Transmittal Form
9. ☐ Attach Stormwater Report, if needed.

E. Fees

1. ☐ Fee Exempt: No filing fee shall be assessed for projects of any city, town, county, or district of the Commonwealth, federally recognized Indian tribe housing authority, municipal housing authority, or the Massachusetts Bay Transportation Authority.

Applicants must submit the following information (in addition to pages 1 and 2 of the NOI Wetland Fee Transmittal Form) to confirm fee payment:

2. Municipal Check Number

4. State Check Number

6. Payor name on check: First Name

3. Check date

5. Check date

7. Payor name on check: Last Name

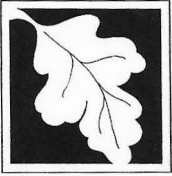

Massachusetts Department of Environmental Protection
Bureau of Resource Protection - Wetlands

Provided by MassDEP:

WPA Form 3 – Notice of Intent

Massachusetts Wetlands Protection Act M.G.L. c. 131, §40

MassDEP File Number

Document Transaction Number

City/Town

F. Signatures and Submittal Requirements

I hereby certify under the penalties of perjury that the foregoing Notice of Intent and accompanying plans, documents, and supporting data are true and complete to the best of my knowledge. I understand that the Conservation Commission will place notification of this Notice in a local newspaper at the expense of the applicant in accordance with the wetlands regulations, 310 CMR 10.05(5)(a).

I further certify under penalties of perjury that all abutters were notified of this application, pursuant to the requirements of M.G.L. c. 131, § 40. Notice must be made by Certificate of Mailing or in writing by hand delivery or certified mail (return receipt requested) to all abutters within 100 feet of the property line of the project location.

1. Signature of Applicant

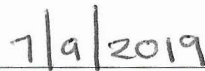
2. Date

3. Signature of Property Owner (if different)

4. Date

5. Signature of Representative (if any)

6. Date

For Conservation Commission:

Two copies of the completed Notice of Intent (Form 3), including supporting plans and documents, two copies of the NOI Wetland Fee Transmittal Form, and the city/town fee payment, to the Conservation Commission by certified mail or hand delivery.

For MassDEP:

One copy of the completed Notice of Intent (Form 3), including supporting plans and documents, one copy of the NOI Wetland Fee Transmittal Form, and a **copy** of the state fee payment to the MassDEP Regional Office (see Instructions) by certified mail or hand delivery.

Other:

If the applicant has checked the "yes" box in any part of Section C, Item 3, above, refer to that section and the Instructions for additional submittal requirements.

The original and copies must be sent simultaneously. Failure by the applicant to send copies in a timely manner may result in dismissal of the Notice of Intent.

Item A

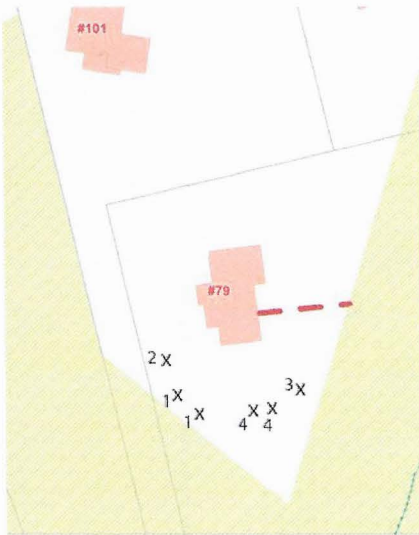

Replanting Strategy

1. White Paper Birch
2. Red Twig Dogwood
3. Eastern Red Cedar
4. Pink Koussa & Cherokee Princess Dogwoods



Tree locations in feet from proximity to house

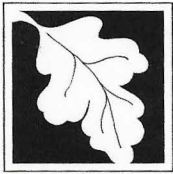

Massachusetts Department of Environmental Protection
Bureau of Resource Protection - Wetlands
NOI Wetland Fee Transmittal Form
Massachusetts Wetlands Protection Act M.G.L. c. 131, §40

Important: When filling out forms on the computer, use only the tab key to move your cursor - do not use the return key.



A. Applicant Information

1. Location of Project:

79 Bent Rd

a. Street Address

Sudbury

b. City/Town

c. Check number

d. Fee amount

2. Applicant Mailing Address:

Catriona and Curvin

a. First Name

Baker and Huber

b. Last Name

None

c. Organization

79 Bent Rd

d. Mailing Address

Sudbury

e. City/Town

MA

f. State

01776

g. Zip Code

570-594-1682

h. Phone Number

i. Fax Number

3dsmaya@gmail.com

j. Email Address

3. Property Owner (if different):

a. First Name

b. Last Name

c. Organization

d. Mailing Address

e. City/Town

f. State

g. Zip Code

h. Phone Number

i. Fax Number

j. Email Address

B. Fees

Fee should be calculated using the following process & worksheet. **Please see Instructions before filling out worksheet.**

Step 1/Type of Activity: Describe each type of activity that will occur in wetland resource area and buffer zone.

Step 2/Number of Activities: Identify the number of each type of activity.

Step 3/Individual Activity Fee: Identify each activity fee from the six project categories listed in the instructions.

Step 4/Subtotal Activity Fee: Multiply the number of activities (identified in Step 2) times the fee per category (identified in Step 3) to reach a subtotal fee amount. Note: If any of these activities are in a Riverfront Area in addition to another Resource Area or the Buffer Zone, the fee per activity should be multiplied by 1.5 and then added to the subtotal amount.

Step 5/Total Project Fee: Determine the total project fee by adding the subtotal amounts from Step 4.

Step 6/Fee Payments: To calculate the state share of the fee, divide the total fee in half and subtract \$12.50. To calculate the city/town share of the fee, divide the total fee in half and add \$12.50.

To calculate filing fees, refer to the category fee list and examples in the instructions for filling out WPA Form 3 (Notice of Intent).



Massachusetts Department of Environmental Protection
Bureau of Resource Protection - Wetlands
NOI Wetland Fee Transmittal Form
Massachusetts Wetlands Protection Act M.G.L. c. 131, §40

B. Fees (continued)

| Step 1/Type of Activity | Step 2/Number of Activities | Step 3/Individual Activity Fee | Step 4/Subtotal Activity Fee |
|-------------------------|-----------------------------|--------------------------------|------------------------------|
| Category 1A | 1 | 110 | 110 |
| RA 50% | 1 | 55 | 55 |
| | | | |
| | | | |
| | | | |
| | | | |
| | | | |

Step 5/Total Project Fee: _____

Step 6/Fee Payments:

| | |
|---------------------------------|-------------------------------|
| Total Project Fee: | 165 |
| | a. Total Fee from Step 5 |
| State share of filing Fee: | 70 |
| | b. 1/2 Total Fee less \$12.50 |
| City/Town share of filling Fee: | 95 |
| | c. 1/2 Total Fee plus \$12.50 |

C. Submittal Requirements

- a.) Complete pages 1 and 2 and send with a check or money order for the state share of the fee, payable to the Commonwealth of Massachusetts.

Department of Environmental Protection
Box 4062
Boston, MA 02211

- b.) **To the Conservation Commission:** Send the Notice of Intent or Abbreviated Notice of Intent; a **copy** of this form; and the city/town fee payment.

To MassDEP Regional Office (see Instructions): Send a copy of the Notice of Intent or Abbreviated Notice of Intent; a **copy** of this form; and a **copy** of the state fee payment. (E-filers of Notices of Intent may submit these electronically.)

**Notification to Abutters Under the
Massachusetts Wetlands Protection Act and the
Sudbury Wetlands Administration Bylaw**

In accordance with the second paragraph of Massachusetts General Laws Chapter 131, Section 40 and the Town of Sudbury's Wetlands Administration Bylaw, you are hereby notified of the following:

- A. The name of the applicant is Catriona Baker and Curvin Huber
- B. The applicant has filed a Notice of Intent with the Sudbury Conservation Commission seeking permission to remove, fill, dredge, or alter an Area subject to Protection Under the Wetlands Protection Act (General Laws Chapter 131, Section 40) and the Town of Sudbury's Wetlands Administration Bylaw.
- C. The address of the lot where the activity is proposed is:
79 Boat Rd
- D. Copies of the Notice of Intent may be examined at the Sudbury Conservation Office between the hours of 9am and 12pm Mondays, Wednesdays, and Fridays, and other times by appointment.
- E. Copies of the Notice of Intent may be obtained from either (check one) the applicant X or the applicant's representative _____, by calling this telephone number (508) 544-1682 between the hours of 9am and 5pm, on the following days of the week: Monday - Friday
- F. The Public Hearing will be held on July 29th at 4:15 pm at the DPW Facility (or otherwise posted) located at 275 Old Lancaster Rd., Sudbury MA

NOTE: Notice of the public hearing, including its date, time, and place, will be published at least five (5) days in advance in the MetroWest News of Sudbury Town Crier.

NOTE: Notice of the public hearing, including its date, time, and place, will be posted in The Sudbury Town Clerk's office, Town Hall, not less than forty-eight (48) hours in advance.

NOTE: You also may contact the Sudbury Conservation Commission or the Department of Environmental Protection Northeast Regional Office for more information about this application or the Wetlands Protection Act. To contact the Sudbury Conservation Commission, please call 978-443-2209 x1371.